

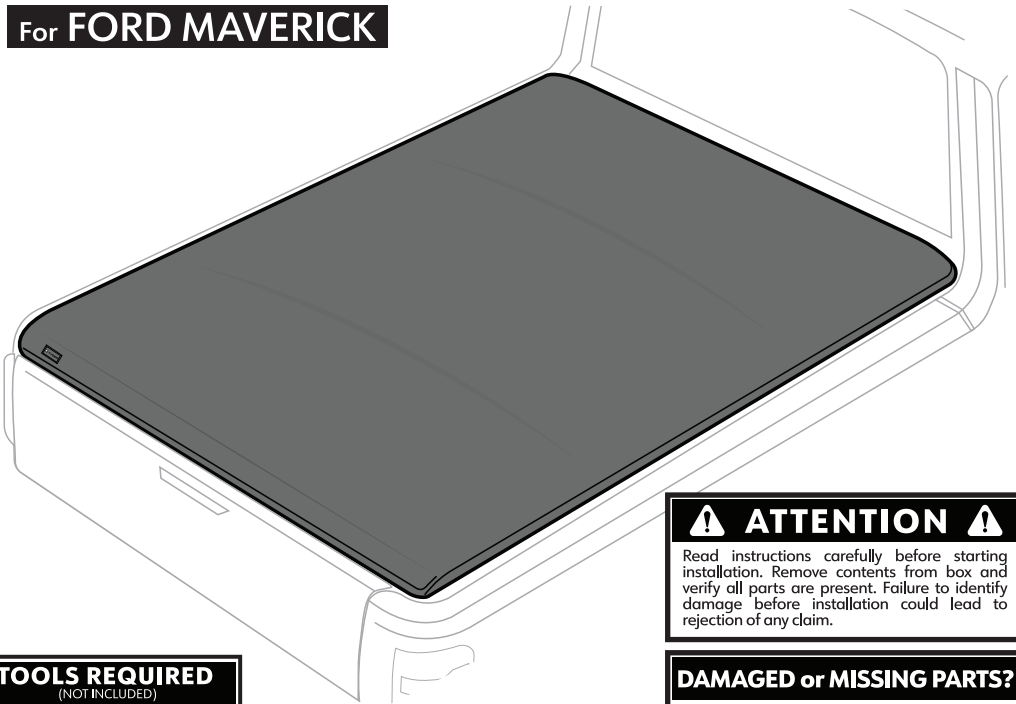

TYGER®

T1 | SOFT ROLL-UP TONNEAU COVER

For FORD MAVERICK



TOOLS REQUIRED (NOT INCLUDED)



10mm
Socket



Ratchet
Wrench



Phillips
Screwdriver

⚠ ATTENTION ⚠

Read instructions carefully before starting installation. Remove contents from box and verify all parts are present. Failure to identify damage before installation could lead to rejection of any claim.

DAMAGED or MISSING PARTS?

NEED HELP?

contact us: 1-866-340-3038

PARTS LIST

(ONLY MARKED ITEMS ARE INCLUDED)

☒ Bed Cover



☒ Side Rails (L & R)



☒ SP-BC1023
Mounting Clamps



☒ SP-BC0003
Front Seal Strip
170 x 2.5 x 1 cm



☒ SP-BC0010
Bulkhead Side Seal Strip
5.6 x 0.55 x 0.35 cm





SP-BC0003

SP-BC0010

1 APPLYING SEAL STRIPS ⓘ

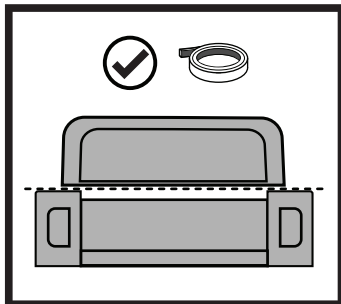
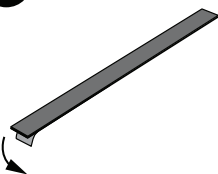
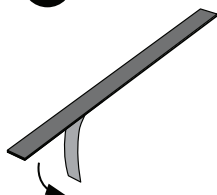
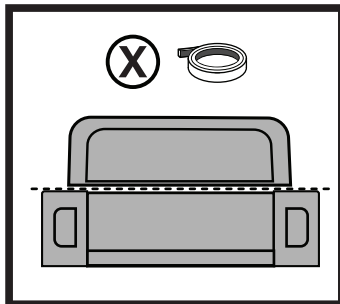
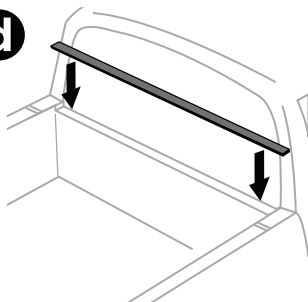
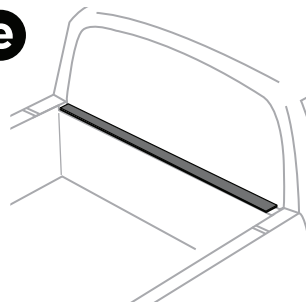
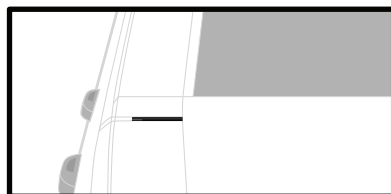
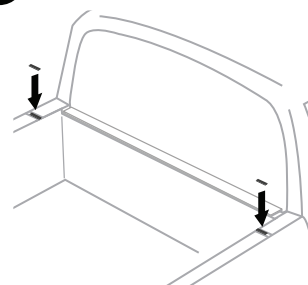
IF THE TRUCK'S FRONT BED RAIL IS LOWER THAN THE SIDES, USE THE PROVIDED WEATHER SEAL STRIPS. GAPS ON THE FRONT BED AND TAILGATE CAN CAUSE NOISE AND FLAPPING ISSUES WHILE DRIVING ALONG WITH WATER LEAKAGE.

a

b

c

d

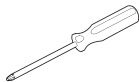
e

f



YOU NEED

Phillips-Head
Screwdriver



ATTENTION

Lift tarp while inserting
side rail to prevent
tearing!

2 ASSEMBLING COVER ⓘ

- PLACE COVER ASSEMBLY ON FRONT TRUCK BED RAIL AGAINST THE CAB.
- LOOSEN THE SCREW IN BULKHEAD ASSEMBLY ON BOTH SIDES, THEN SLIDE IN THE SIDE RAILS.
- REINSTALL AND TIGHTEN SCREWS TO ATTACH SIDE RAILS TO COVER ASSEMBLY.

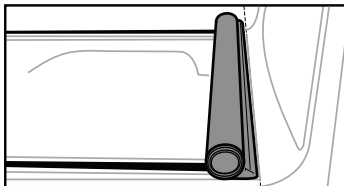
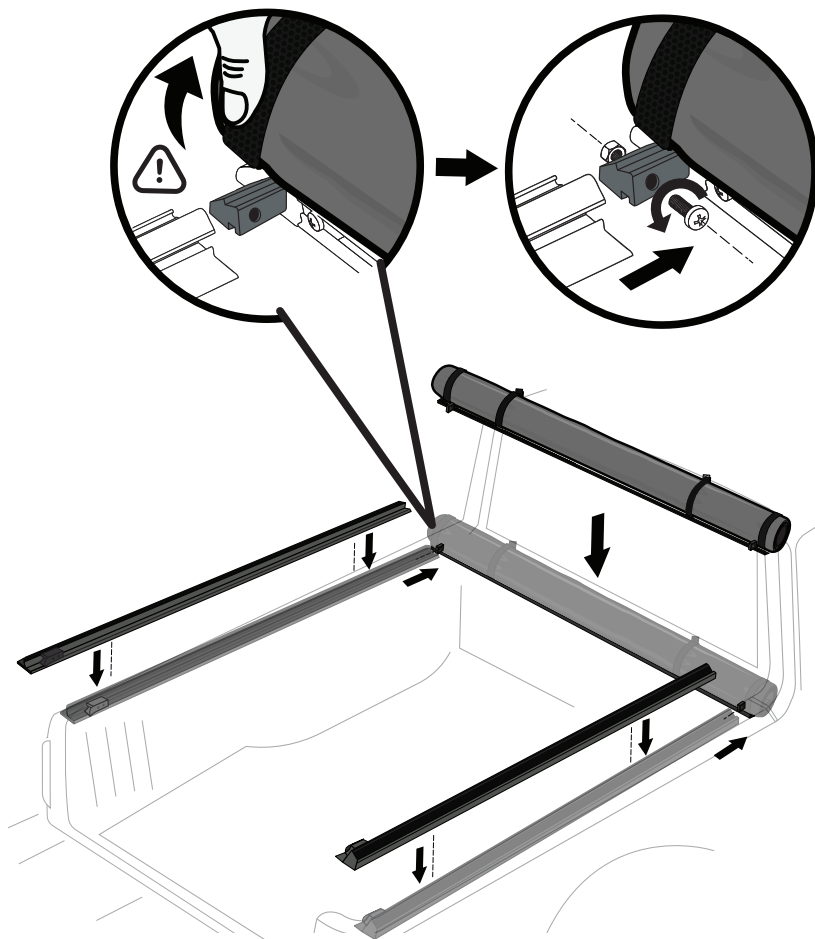

The base of the front cover assembly must be aligned flush against the outer edge of the front bed panel railing.

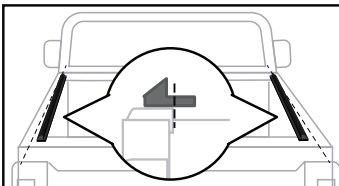

Cover side rails will taper off towards the tailgate and may not stay parallel; they will hover over the cargo space so rear clamps can reach the railings.



The cover side rails may not seem parallel with the bed panel railings but both side rails must be symmetrically spaced between each other and their tailgate ends must be aligned for proper latching.



NOTE



DO NOT
over-tighten
the clamps

ATTENTION

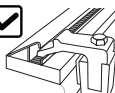

Inside Channel

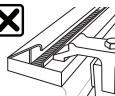

Out of Channel

3 POSITIONING SIDE RAILS & CLAMPS



- REMOVE CLAMP ASSEMBLIES FROM THE PACKAGE.
- DISASSEMBLE THE UPPER CLAMP FROM THE LOWER CLAMP THEN HOOK THE UPPER CLAMP INTO THE SIDE-RAIL'S INNER CHANNEL.
- LATCH LOWER CLAMP TO THE RAIL LIP AND REATTACH IT TO THE UPPER CLAMP WITH THE NUT AND BOLT.

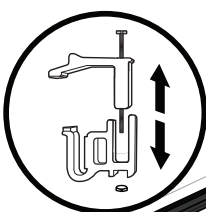

SP-BC1023



ATTENTION!

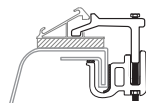

CLAMPS MUST BE ATTACHED SECURELY TO THE **METAL PART** OF THE TRUCK BED RAIL LIPS; SMALL HOLES MIGHT NEED TO BE CUT ON THE BED LINER.



ATTENTION

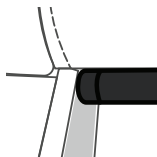

Incorrect positioning of the crossbars can cause water to pool on the cover.

ATTENTION



Horizontal crossbars are arched by design to help drain and prevent water pooling. Make sure the arched side is facing up during installation.

4 ROLLING OUT THE COVER



- UNHOOK THE SAFETY STRAPS.
- MAKE SURE THE ENDS OF THE CROSSBARS ARE RESTING ON THE SIDE RAIL LEDGES AND CROSSBARS ARE ARCHED UPWARD.

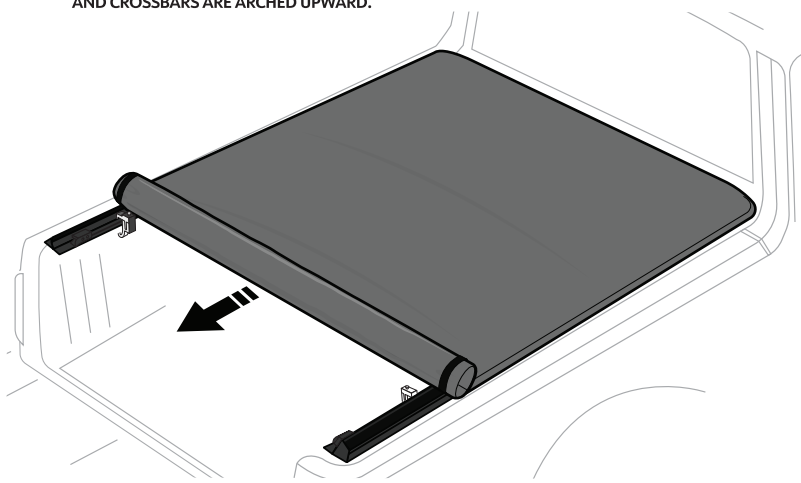

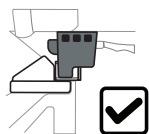
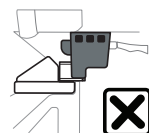
WARNING!

In Channel

NOT In Channel
NOTE

For latching issue, refer to **PAGE 10** for trouble shooting instruction.

NOTE

Velcro Strips must be fully fastened to prevent water from leaking in.

5 LOCKING THE COVER

- PUSH DOWN THE END OF THE COVER WITH SUFFICIENT FORCE TO CLOSE IT.
- THE COVER MUST BE CLOSED FIRST BEFORE YOU SHUT THE TAILGATE.

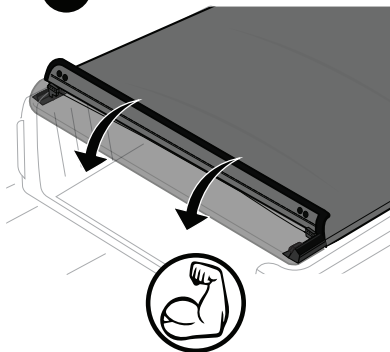
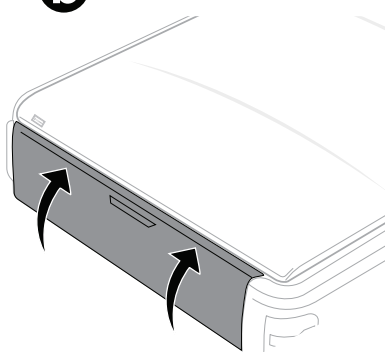
a

b

CLICK!!!

6 STRAIGHTENING OUT THE COVER

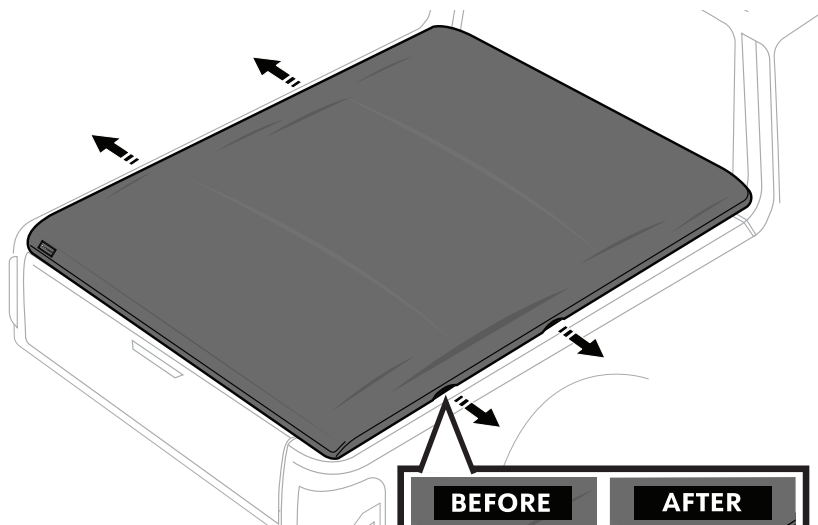
- STRETCH OUT THE COVER TARP ON BOTH SIDES TO REMOVE ANY WRINKLES AND MAKE SURE BOTH VELCRO STRIPS ARE PROPERLY FASTENED AND SEALED TO PREVENT WATER LEAK.



BEFORE
AFTER



SEAL STRIP

7 CHECKING FOR GAPS ⓘ

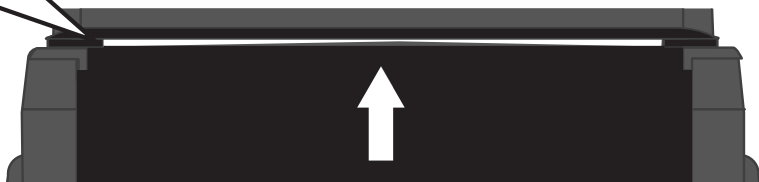
- WITH THE TAILGATE OPEN, VISUALLY INSPECT FOR LIGHT LEAKING THROUGH THE GAPS. APPLY ADDITIONAL SEALING STRIPS TO FILL THE GAPS THEN REINSPECT AND REPEAT.



INSTALLATION COMPLETE!!!

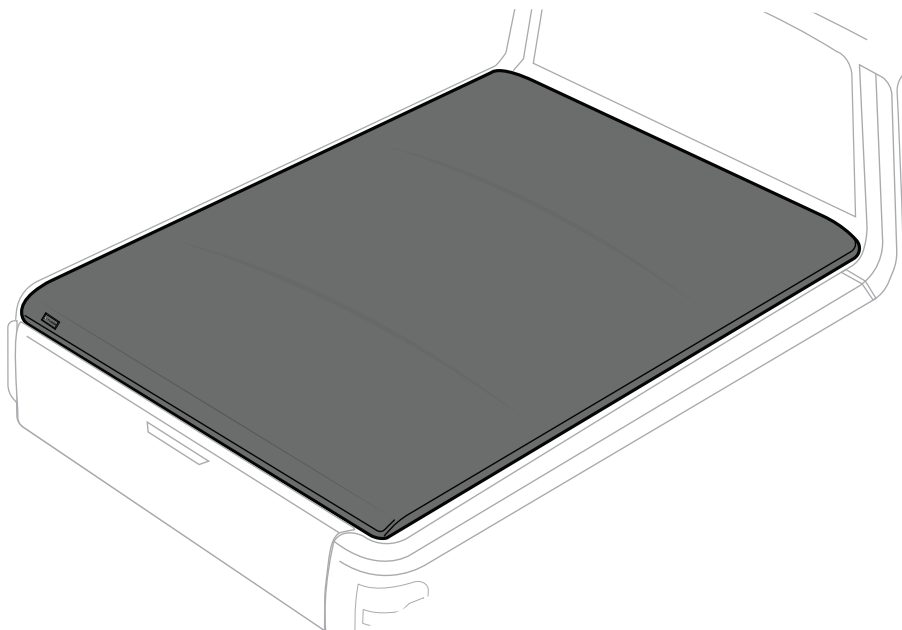

AFTER INSTALLATION

8 RELEASING THE COVER ⓘ



NOTE

Pressing down on the cover edge will improve the release.

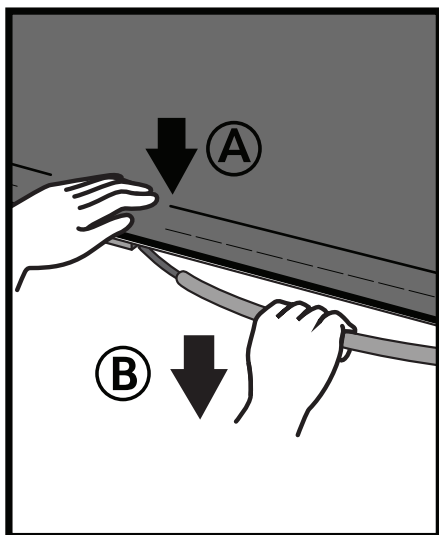

• OPEN THE TAILGATE AND PUSH DOWN AGAINST THE COVER EDGE WITH ONE HAND.



• PULL ON LATCH CABLE TO RELEASE THE COVER WITH THE OTHER HAND.

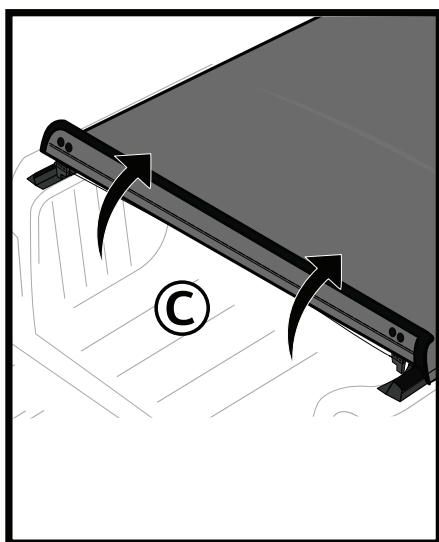

• ROLL UP THE COVER CLOSELY.

ATTENTION

Make sure the cover is free from any debris before rolling it up. Safety straps must be buckled and tightened before driving.

NOTE

Cover may not fully cover all the way to the outer edges of the bed rails due to small variance in bed sizes from different year models.



DO NOT
overload cargo



Secure strap buckles
before driving



Remove snow before
rolling up cover



Use water and
soap to clean.
Avoid abrasive
chemical cleaners

9 ROLLING UP THE COVER

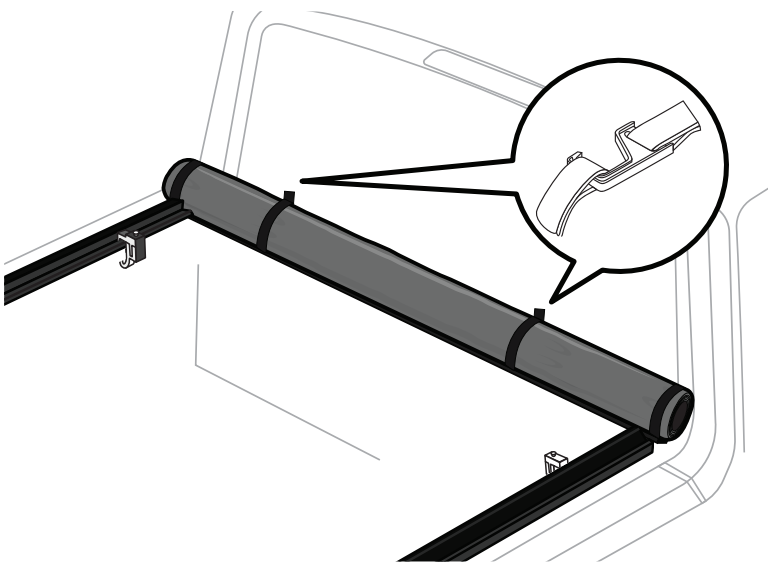
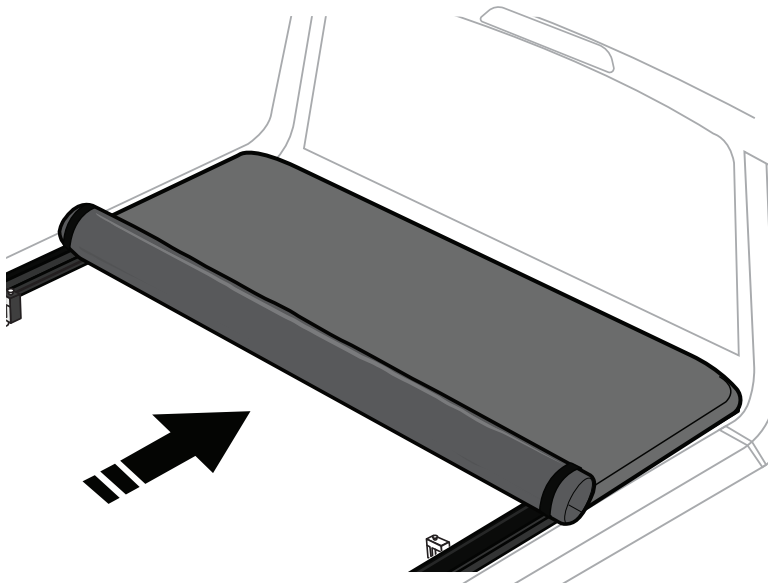

10 SELF-MAINTENANCE THE TENSION CONTROL SYSTEM ⓘ

NOTE: TENSION PLATE ADJUSTMENT IS NOT REQUIRED FOR BRAND-NEW TONNEAU COVERS.

IF THE TENSION BETWEEN THE BULKHEAD & TENSION PLATE HAS BECOME LOOSE OR TIGHT OVER TIME, YOU CAN ADJUST THE TENSION PLATE POSITION TO IMPROVE THE TENSION CONTROL.

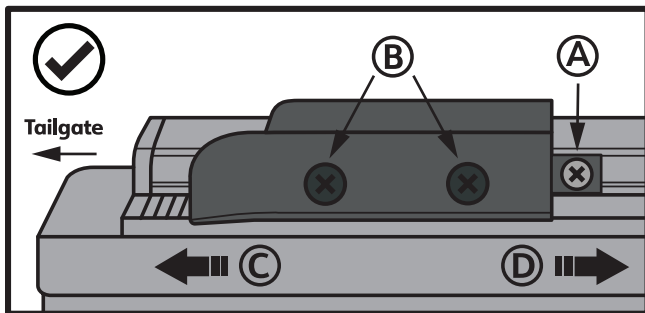
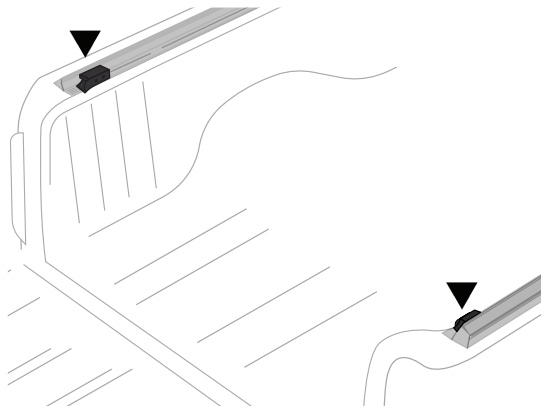

NOTE

Only move one increment at a time. Each increment gives you 1/8" of tension adjustment. Apply the same adjustment to both sides' tension plates.

YOU NEED

Phillips-Head
Screwdriver

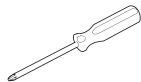

- (A)** • FIRST LOOSEN THE FRONT SCREW IN THE RAIL CHANNEL. DO NOT FULLY REMOVE THIS SCREW.
- (B)** • THEN LOOSEN THE 2 SCREWS IN THE TENSION PLATE BLOCK. DO NOT FULLY REMOVE THESE SCREWS. THIS ALLOWS THE TENSION PLATE TO SLIDE BACK AND FORTH.
- (C)** • TO INCREASE THE TENSION (LATCHING IS TOO LOOSE), MOVE THE TENSION PLATE TOWARDS THE TAILGATE. RE-TIGHTEN FIRST THE (A) THEN (B) SCREWS.
- (D)** • TO DECREASE THE TENSION (LATCHING IS TOO TIGHT), MOVE THE TENSION PLATE TOWARDS THE FRONT. RE-TIGHTEN FIRST THE (A) THEN (B) SCREWS.

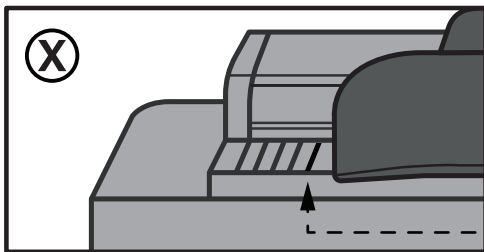

⚠ ATTENTION

• **DO NOT** ADJUST THE TENSION PLATE BEYOND **THE LAST INCREMENT LINE.**

11 COVER DOESN'T STAY LATCHED?

- MAKE SURE THE LOCKING CLIP ON BOTH SIDES ARE COMPLETELY INSERTED INTO THE CHANNEL ON THE SIDE RAILS TO AVOID END OF THE COVER BECOMING UNLATCHED.

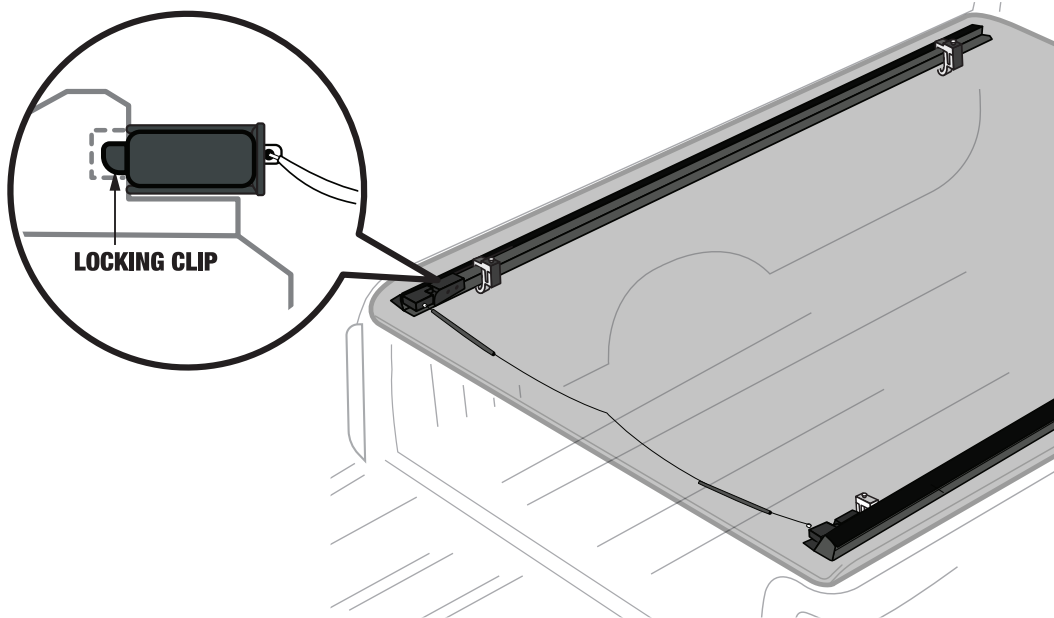

- ## 12
- IF COVER DOESN'T STAY CLOSED AND YOU FIND THE LOCKING CLIP IS NOT FULLY INSERTED.

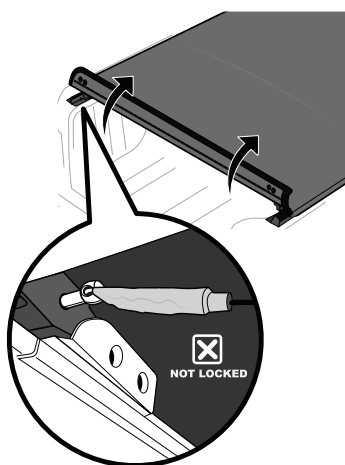

- ## 13
- IF NEEDED, FOLLOW INSTRUCTIONS IN **PAGE 9** TO ADJUST THE TENSION PLATE.

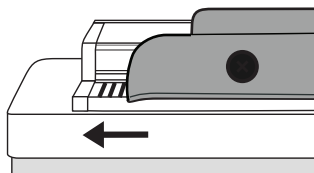

- ## 14
- MAKE SURE THE LOCKING CLIP ON BOTH SIDES ARE INSERTED INTO THE CHANNEL ON THE SIDE RAILS.

