

T1X | SOFT ROLL-UP COVER IN FABRIC

For 2024 - Up TOYOTA TACOMA

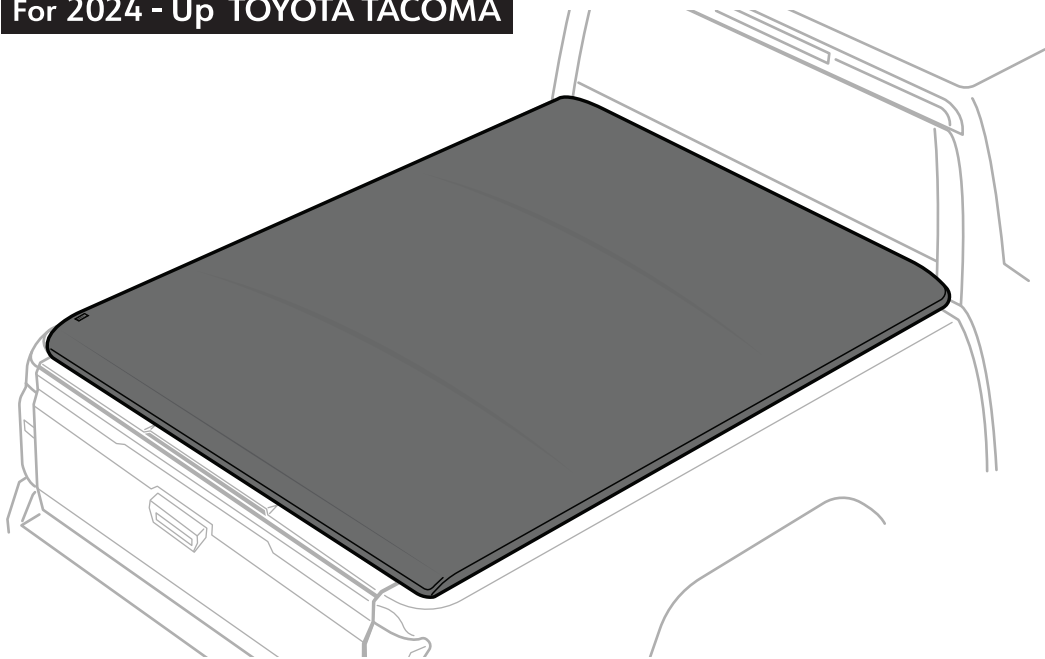

TOOLS REQUIRED

(NOT INCLUDED)



10mm Socket



Ratchet Wrench



Phillips Screwdriver



ATTENTION



Read instructions carefully before starting installation. Remove contents from box and verify all parts are present. Failure to identify damage before installation could lead to rejection of any claim.

CONTACT US:

1-866-340-3038



LIVE CHAT

- Bed Cover



- SP-BC1032 **A**
- SP-BC1033 **B**
- SP-BC1034 **C**

Mounted Clamps for Utility Track

NOTE: The letters **A**, **B** and **C** etched on side of the clamps.



- Side Rails (L & R)
(A, B and C etched on the face of the rail)



- SP-BC0014
Front Seal Strip
150 x 2.0 x 0.4cm



- SP-BC0016
Bulkhead Side Foam Block
6.0 x 2.5 x 2.5cm



- SP-BC0017
Bulkhead Side Seal Foam
3.5 x 2.6 x 0.3cm



- SP-BC0022
Front Utility Track Seal Strip
150 x 2.3 x 1.7cm



PARTS LIST



1 APPLYING SEAL STRIPS

The Tacoma's front bed rail area requires sealing foams to fill the gaps on each side and to level the uneven surfaces around the bed rail.

ATTENTION: GAPS ON THE FRONT BED AND TAILGATE CAN CAUSE NOISE AND FLAPPING ISSUES WHILE DRIVING ALONG WITH WATER LEAKAGE.

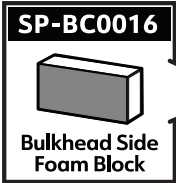
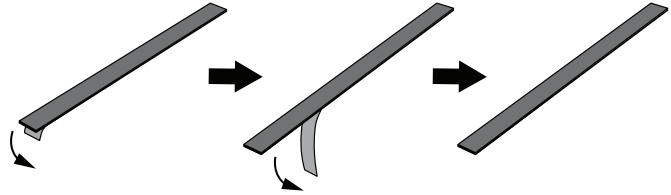

Attached on each side to be used as a base for the Utility Track Seal Strip in Step **b**.

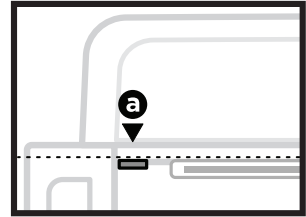
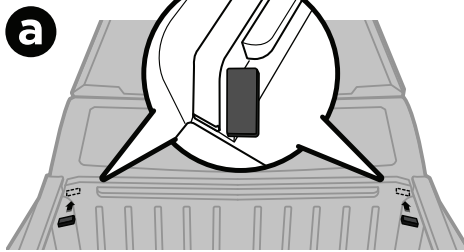

Apply on Front Utility Track to level the lower bulkhead with the side bed rails

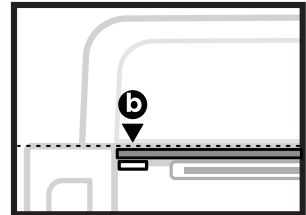
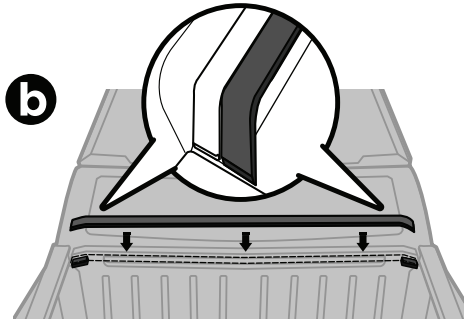

Used to level the front bed rail with the side bed rails.

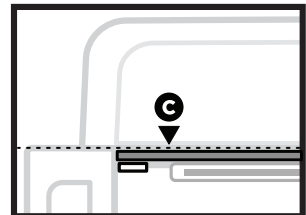
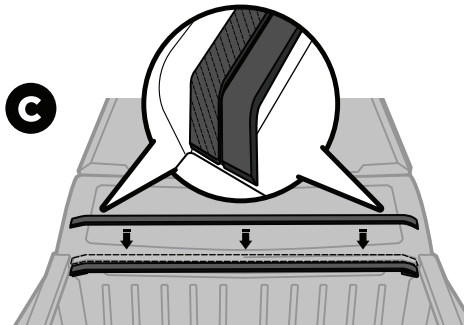

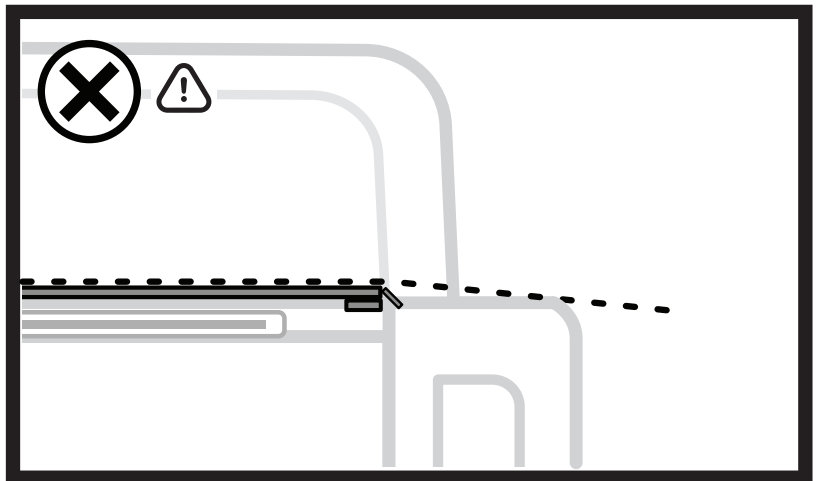
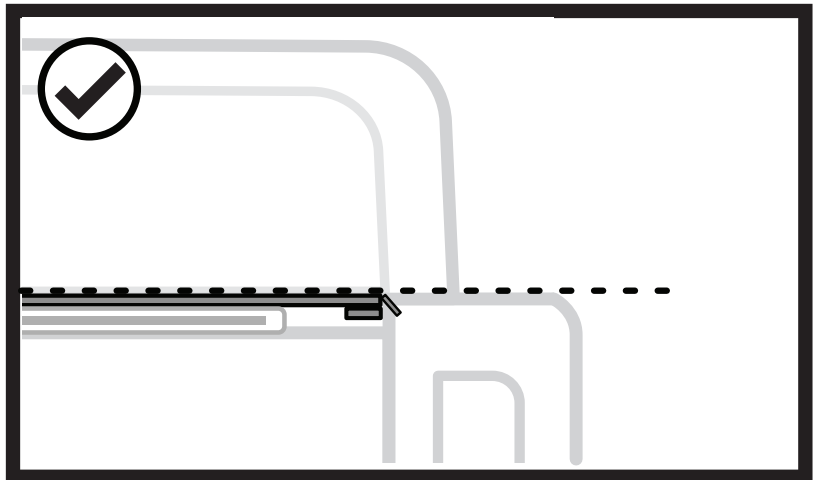
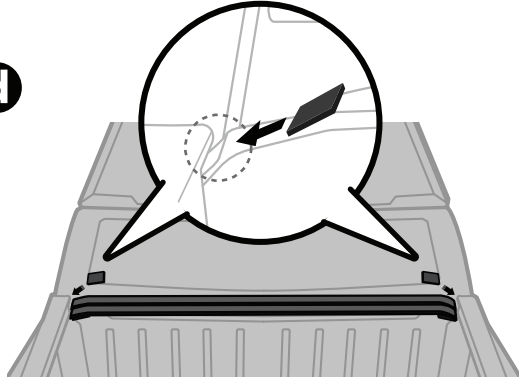

Slide these into the narrow gaps between the front and side bed panels.

d**ATTENTION**

The sponge strips must be on the same plane, otherwise will cause water leaking.



YOU NEED

Phillips-Head
Screwdriver

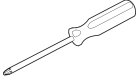

ATTENTION

Lift tarp while inserting
side rail to prevent
tearing!

2 ASSEMBLING COVER ⓘ

- Place cover assembly on front truck bed rail against the cab.
- Loosen the screw in bulkhead assembly on both sides, then slide in the side rails.
- Reinstall and tighten screws to attach side rails to cover assembly.

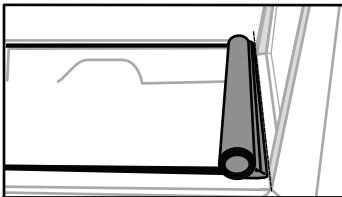
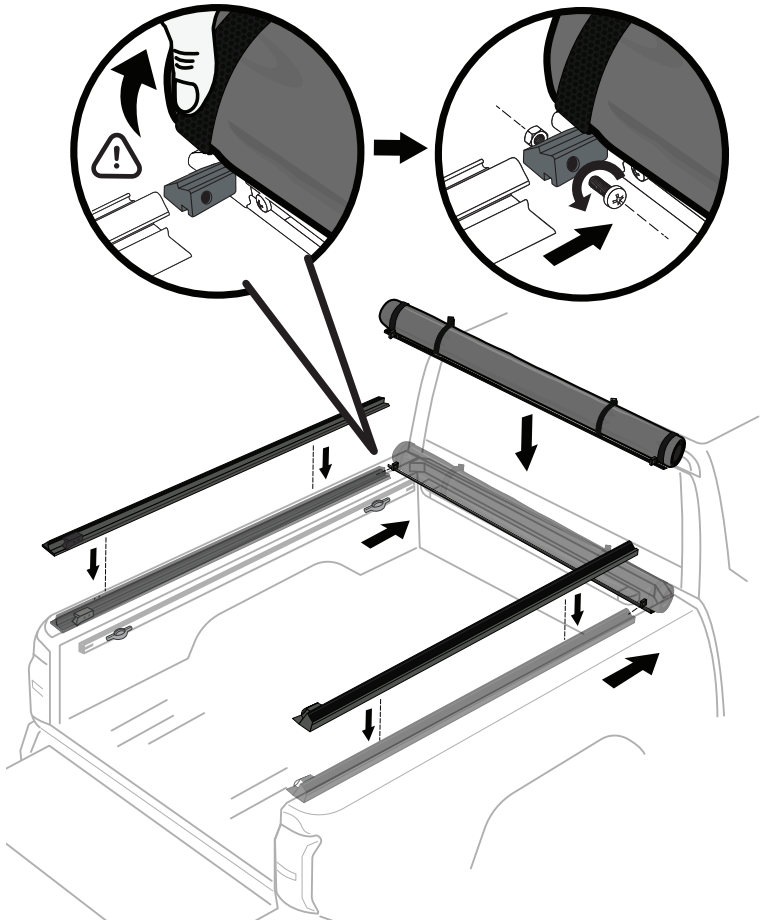

The base of the front cover assembly must be positioned right up against the left and right rear window post panels. Make sure there is no gap between the weather seal tape and the cover base.

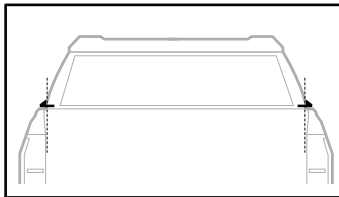

The inner portions of bed cover side rails will taper off towards the tailgate end and partially hover over the side panel railings into the cargo space in order for the rear clamps to access the rail channel.



The cover side rails may not seem parallel with the bed panel railings but both side rails must be symmetrically spaced between each other and their tailgate ends must be aligned for proper latching.

3 INSTALL THE ALTERNATE BRACKETS

Models with utility tracks require alternate brackets to access the bed railing lip. First, remove any tie-down anchors installed along the tracks. Then, in the following order, slide in **A > B > C** marked alternate brackets to each matching position marked on the cover side rails. Slide anchors back in between the brackets if needed.

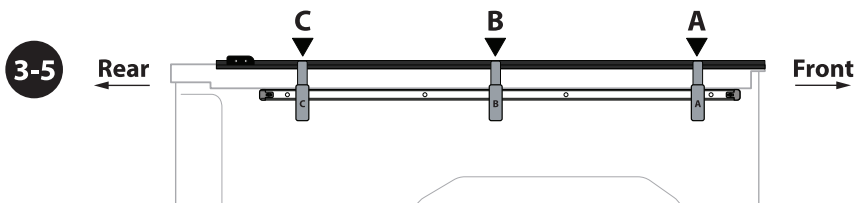
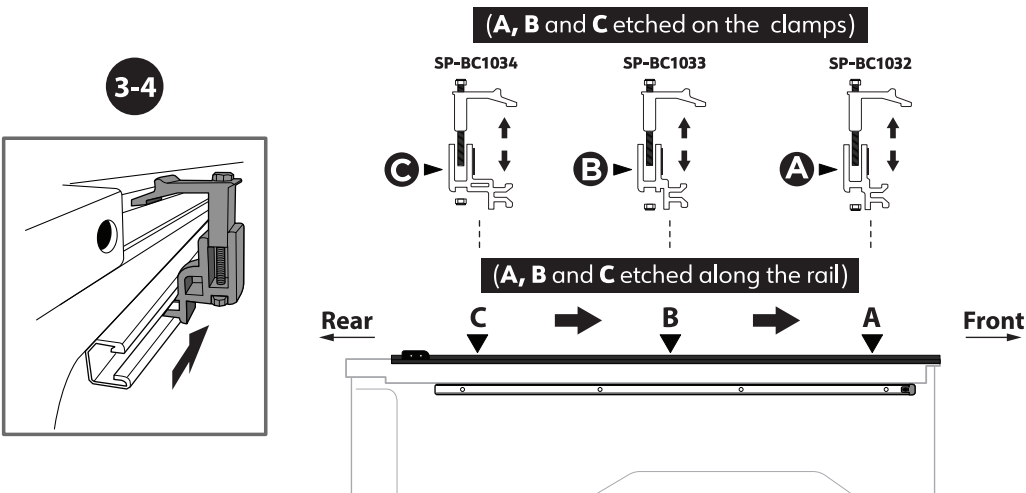
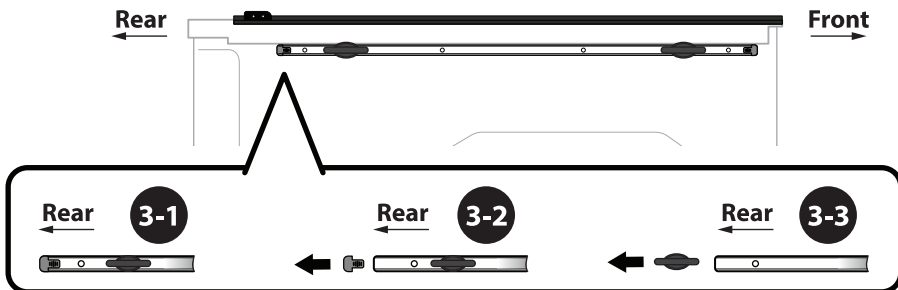

ATTENTION

Inside Channel	Out of Channel
✓	✗

NOTE

✓	✗ DO NOT over-tighten the clamps

ATTENTION

Make sure the alignment of the **A**, **B** and **C** are matching both on the clamps side and Rail Face.

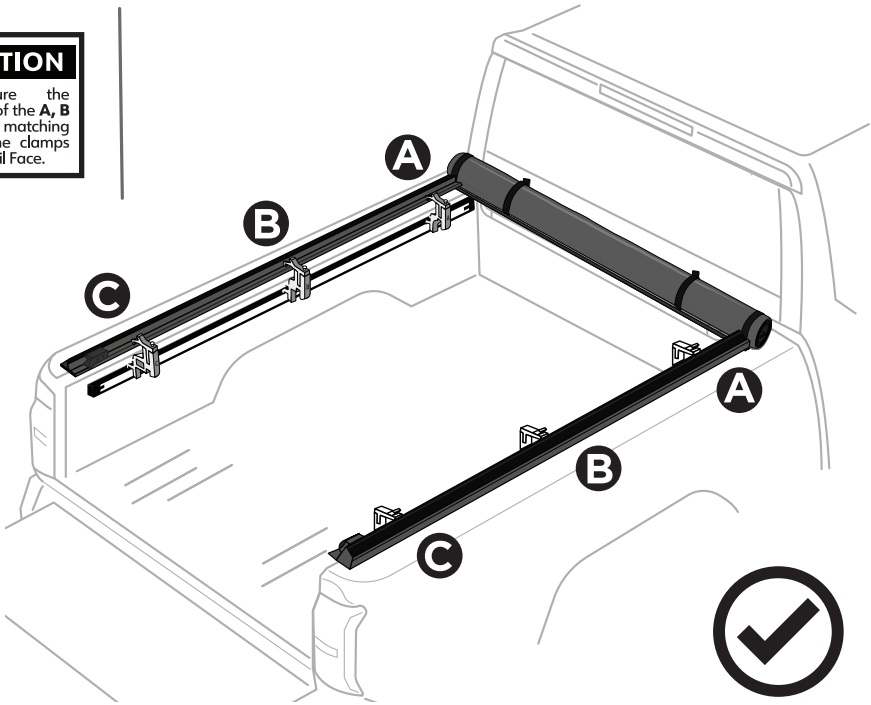

i

ATTENTION

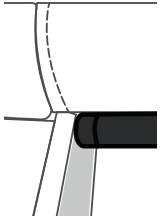

Incorrect positioning of the crossbars can cause water to pool on the cover.

ATTENTION

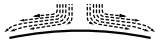

Horizontal crossbars are arched by design to help drain and prevent water pooling. Make sure the arched side is facing up during installation.

4 ROLLING OUT THE COVER **i**

- Unhook the safety straps.
- Make sure the ends of the crossbars are resting on the side rail ledges and crossbars are arched upward.

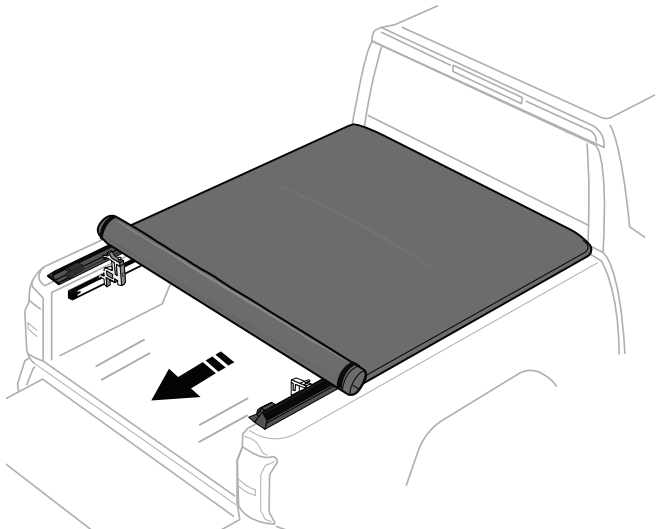



WARNING!

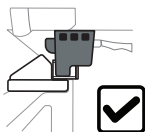

In Channel

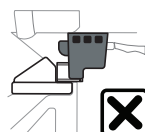

NOT In Channel

NOTE

For latching issue, refer to **PAGE 13** for trouble shooting instruction.

5 LOCKING THE COVER

- Push down the end of the cover with sufficient force to close it.
- The cover must be closed first before you shut the tailgate.

a

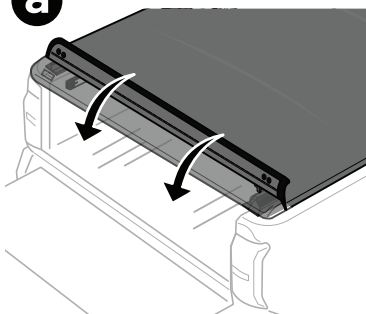

b

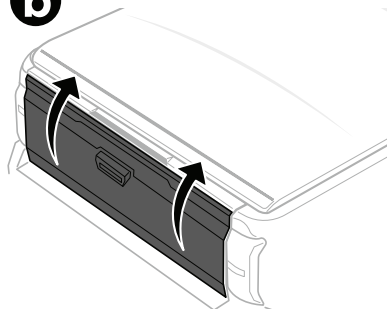

CLICK!!!

6 STRAIGHTENING OUT THE COVER

- Stretch out the cover tarp on both sides to remove any wrinkles and make sure both velcro strips are properly fastened and sealed to prevent water leak.

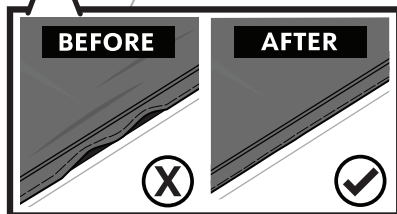
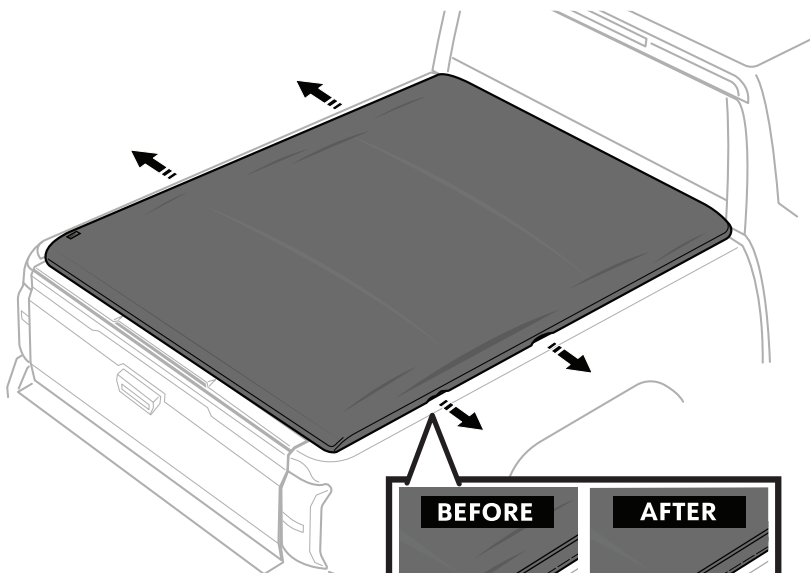

NOTE



Velcro Strips must be fully fastened to prevent water from leaking in.

7 CHECKING FOR GAPS ⓘ

- With the tailgate open, visually inspect for light leaking through the gaps. Apply additional sealing strips to fill the gaps then reinspect and repeat.

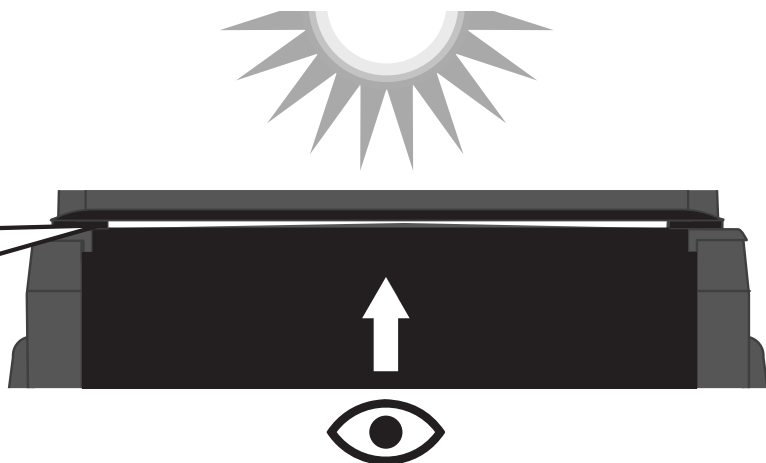

INSTALLATION COMPLETE!!!



AFTER INSTALLATION

8 RELEASING THE COVER ⓘ



NOTE

Pressing down on the cover edge will improve the release.

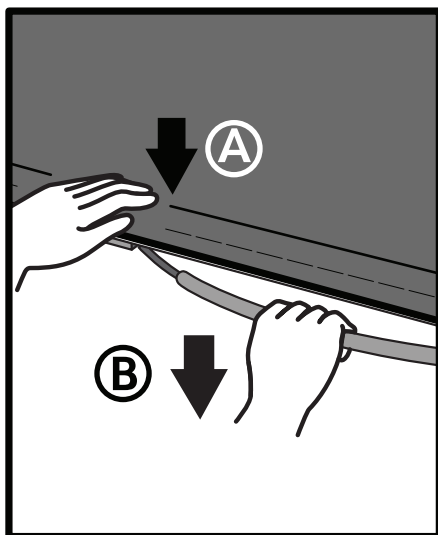

• Open the tailgate and push down against the cover edge with one hand.



• Pull on latch cable to release the cover with the other hand.

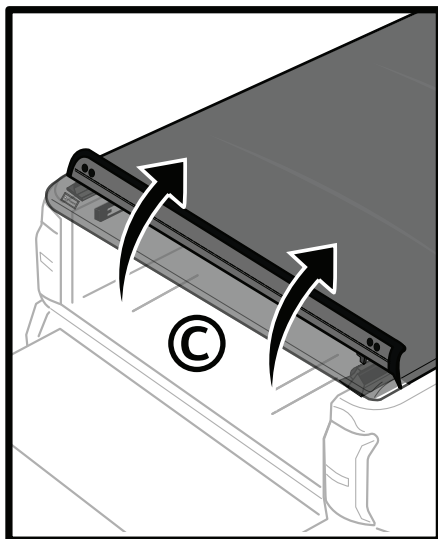

• Roll up the cover closely.

9 ROLLING UP THE COVER ⓘ



ATTENTION

Make sure the cover is free from any debris before rolling it up. Safety straps must be buckled and tightened before driving.

NOTE

Cover may not fully cover all the way to the outer edges of the bed rails due to small variance in bed sizes from different year models.



DO NOT
overload cargo



Secure strap buckles
before driving



Remove snow before
rolling up cover



Use water and soap to clean.
Avoid abrasive
chemical cleaners

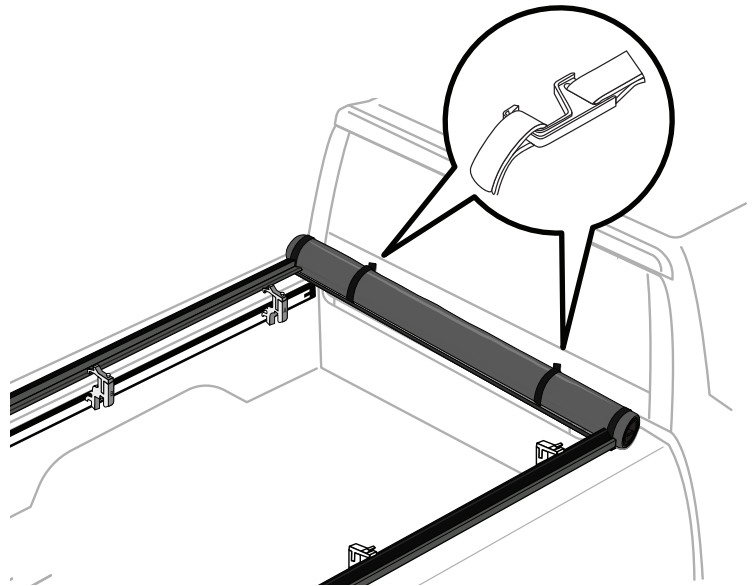
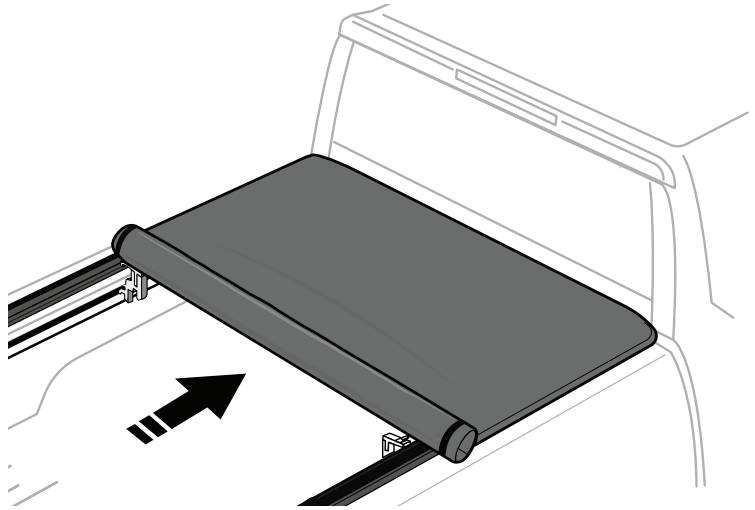

10 TONNEAU COVER CARE & MAINTENANCE

❄️ COLD WEATHER USE – IMPORTANT

- DO NOT operate the vehicle with snow or ice buildup on the cover
- Gently remove any snow buildup from the cover before operation
- If the cover is frozen or stuck, DO NOT force it to roll or unroll
- If frozen, allow the cover to thaw naturally. DO NOT use hot water, chemicals, or de-icing agents
- DO NOT use sharp or hard objects to remove ice or snow, as this may damage the cover

⚠️ CLEANING TIPS

Follow these cleaning guidelines to help prevent damage to the fabric and seams, protect the waterproof barrier, and minimize fading:

- DO NOT use pressure washers or hot water
- Tonneau cover must be removed before using an automated car wash
- Rinse with a standard garden hose using a shower, fan, or mist setting
- Avoid using jet or power stream modes at close range (<1 ft)
- For dirt or stains, use a soft sponge or cloth with mild soap and luke warm water (max 30°C / 86°F)
- Avoid scrubbing, bleach, or harsh chemicals
- Rinse thoroughly and air dry completely before closing or storing
- Avoid prolonged soaking to water and detergent



Gentle
Hand Wash



No
Harsh Chemicals



DO NOT
Pressure Wash



DO NOT
Iron



NO Automated
Car wash



Air Dry

11 SELF-MAINTENANCE THE TENSION CONTROL SYSTEM ⓘ

NOTE: Tension plate adjustment is not required for brand-new tonneau covers. If the tension between the bulkhead & tension plate has become loose or tight over time. You can adjust the tension plate position to improve the tension control.

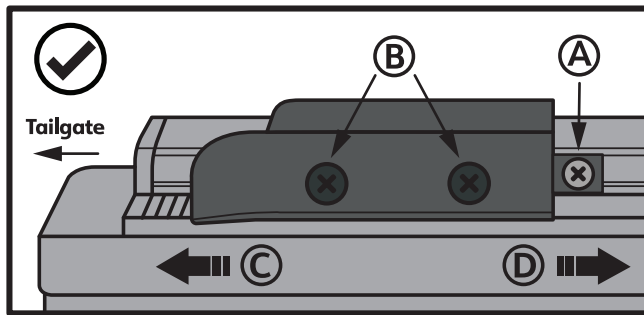
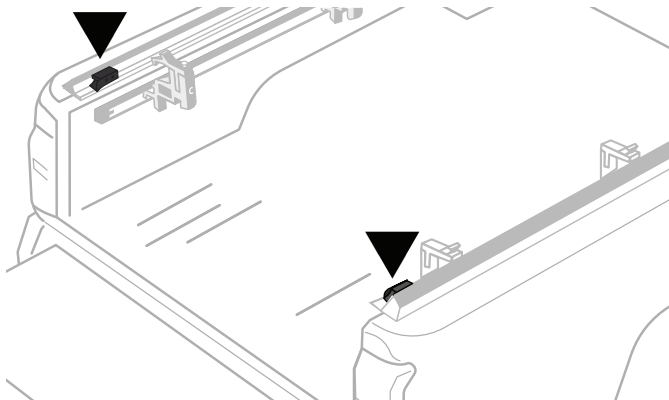

- (A)** • First loosen the front screw in the rail channel. Do not fully remove this screw.
- (B)** • Then loosen the 2 screws in the tension plate block. DO NOT fully remove these screws. This allows the tension plate to slide back and forth.
- (C)** • To increase the tension (latching is too loose), move the tension plate towards the tailgate. Re-tighten first the **(A)** then **(B)** screws.
- (D)** • To decrease the tension (latching is too tight), move the tension plate towards the front. Re-tighten first the **(A)** then **(B)** screws.



NOTE

Only move one increment at a time. Each increment gives you 1/8" of tension adjustment. Apply the same adjustment to both sides' tension plates.

YOU NEED

Phillips-Head
Screwdriver

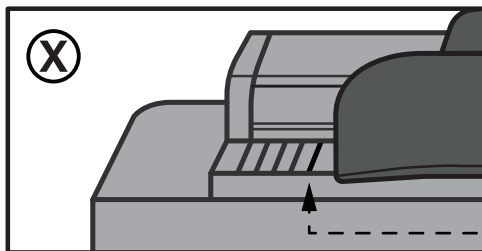
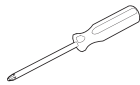

⚠ ATTENTION

• DO NOT Adjust the tension plate beyond the last increment line.

12 COVER DOESN'T STAY LATCHED?

- Make sure the locking clip on both sides are completely inserted into the channel on the side rails to avoid end of the cover becoming unlatched.

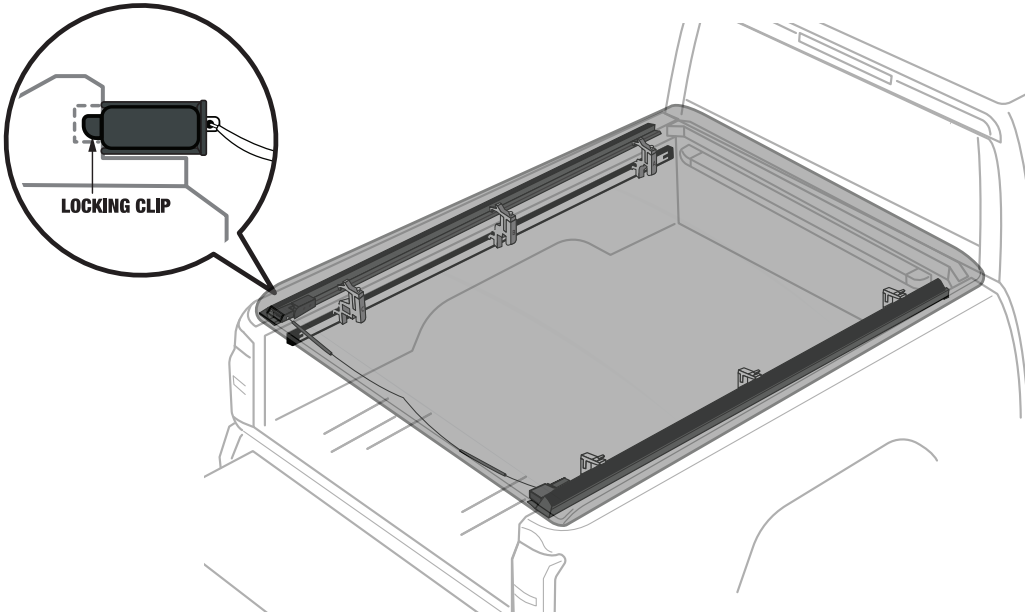

- 13** • If cover doesn't stay closed and you find the locking clip is not fully inserted.

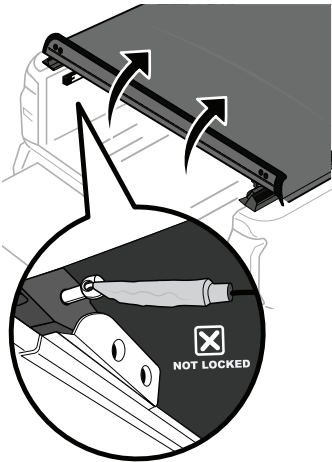

- 14** • If needed, follow instructions in **PAGE 12** To adjust the tension plate.

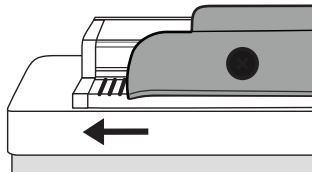

- 15** • Make sure the locking clip on both sides are inserted into the channel on the side rails.

