

T5 | ALLOY HARD FOLDING TONNEAU COVER QUAD-FOLD

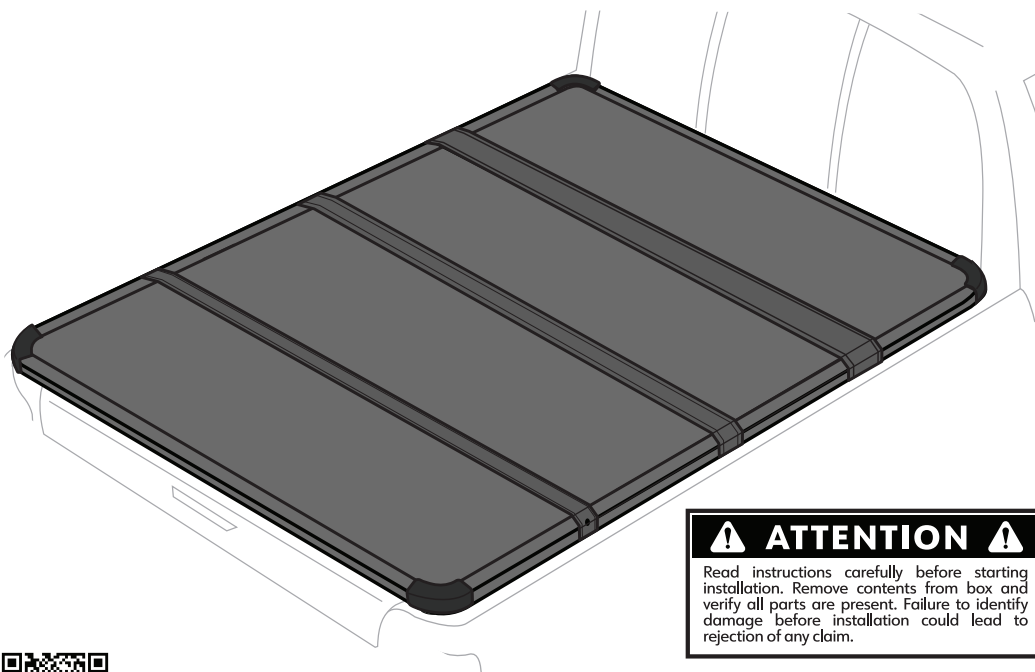

Scan to Download the Latest Digital Version

⚠ ATTENTION ⚠

Read instructions carefully before starting installation. Remove contents from box and verify all parts are present. Failure to identify damage before installation could lead to rejection of any claim.

DAMAGED or MISSING PARTS?

NEED HELP?

contact us: 1-866-340-3038

PARTS LIST (ONLY MARKED ITEMS ARE INCLUDED)

☒ Bed Cover

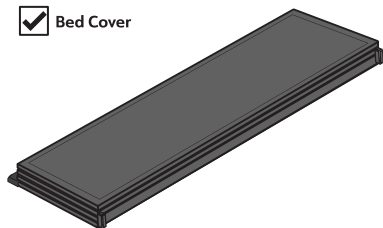

☐ SP-BC3002



☒ SP-BC0006



☒ SP-BC5038



☒ SP-BC5037
Safety Clamp

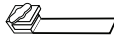

☐ SP-BC3003B



☐ SP-BC3004



☐ SP-BC3005



☒ SP-BC5039
Safety Clamp Fasteners



☐ SP-BC0003
Front Seal Strip
170 x 2.5 x 1cm

☐ SP-BC0004
Front Seal Strip
170 x 3.5 x 0.4cm

☐ SP-BC0005
Spare Seal Strip
200 x 3.0 x 0.6cm





SEAL STRIP

Only needed
for certain models



1 APPLYING SEAL STRIP

IF YOUR TRUCK'S FRONT BED RAIL IS LOWER THAN THE SIDE BED RAILS, USE THE PROVIDED WEATHER SEAL STRIPS TO LEVEL THE SURFACE. ANY GAPS IN THE BED RAILS AND TAILGATE CAN CAUSE NOISE, FLAPPING, OR WATER LEAKAGE WHILE DRIVING.

NOTE: SPARE SEALING STRIP (SP-BC0005) IS INCLUDED IN CASE ADDITIONAL SEALING IS NEEDED AROUND THE BED AREA.

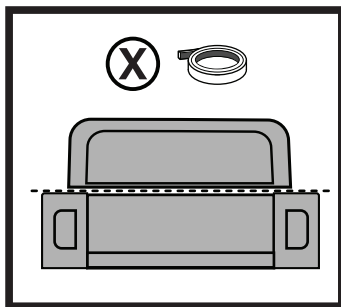
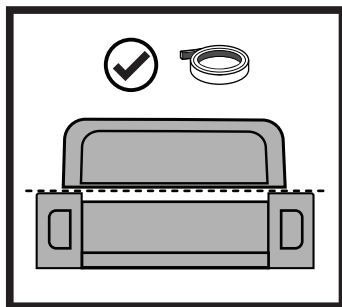

a

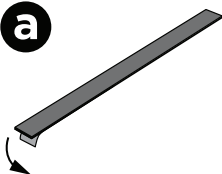

b

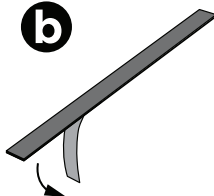

c

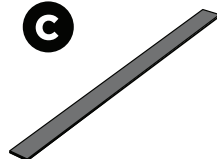

d

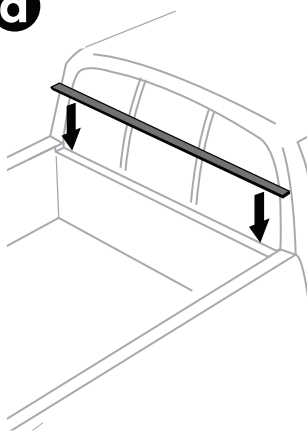

e

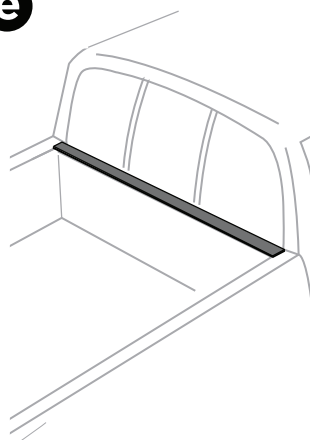

2 LAYING OUT THE COVER

- PLACE THE FOLDED COVER ASSEMBLY ON THE FRONT BED RAIL.
- RELEASE THE SAFETY BUCKLES AND FULLY UNFOLD THE COVER TOWARDS THE TAILGATE.

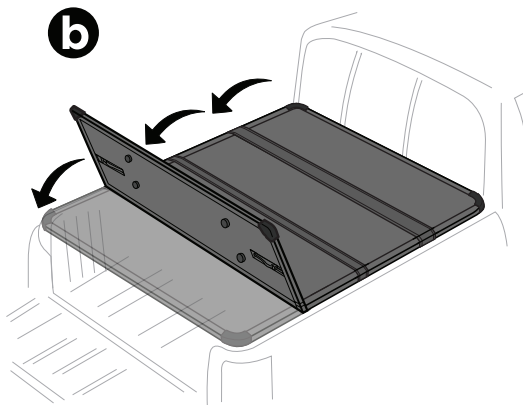
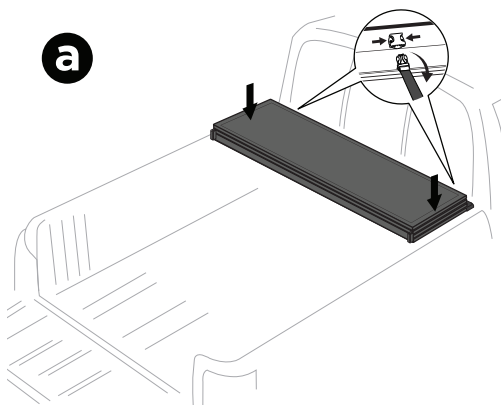

c

- C-1** • ALIGN THE FRONT OF THE COVER AGAINST THE OUTER EDGE AT THE MIDPOINT OF THE FRONT BED RAIL.
- C-2** • ALIGN BOTH SIDES OF THE COVER EVENLY ON THE SIDE BED RAILS. THE WIDTH OF THE COVER DOES NOT COVER ALL THE WAY TO THE OUTER EDGES OF THE SIDE RAILS.

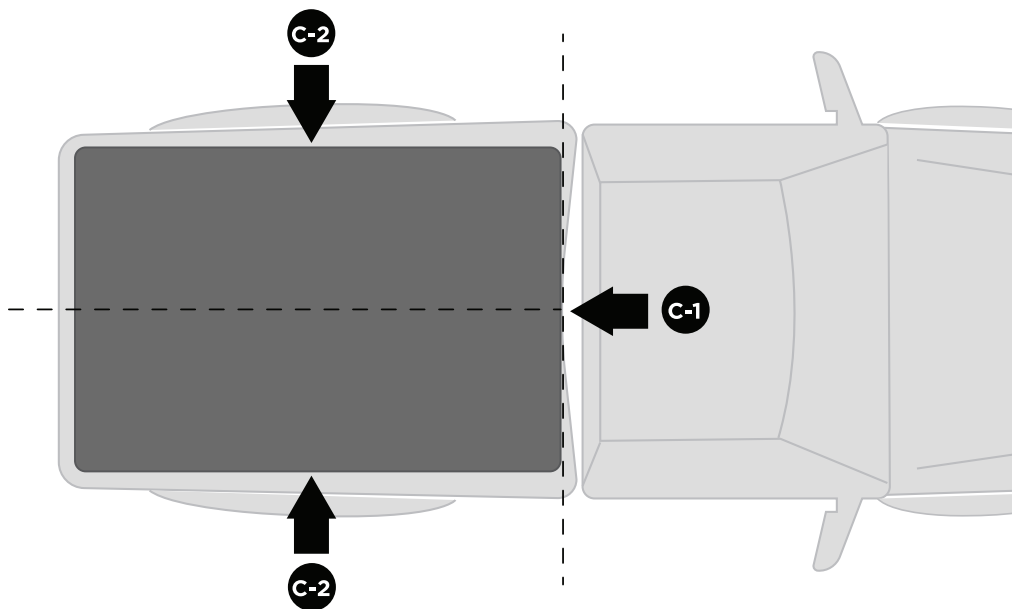

3 FOLDING BACK THE COVER

- CAREFULLY REFOLD THE COVER WITHOUT MOVING ITS POSITION ON THE TRUCK BED.

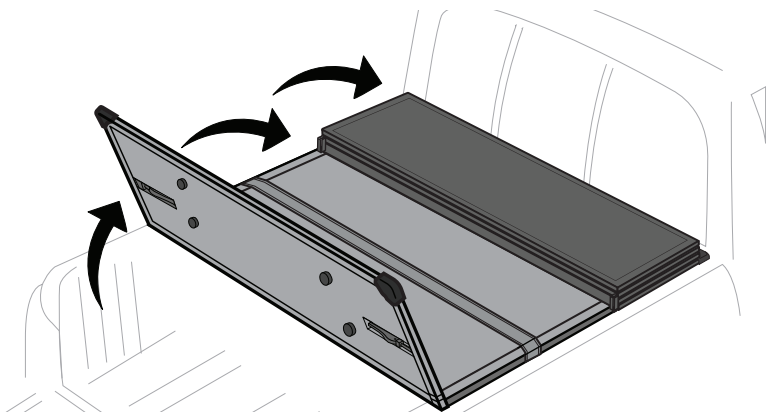

4 CLAMPS & LATCHES OVERVIEW

- THE CLAMPS AND LATCHES ARE ALREADY ATTACHED TO THE ASSEMBLED COVER.

NOTE: FOR MODELS WITH UTILITY TRACK, REFER TO **PAGE 12** FOR INSTRUCTION ON UTILITY TRACK BRACKET INSTALLATION.

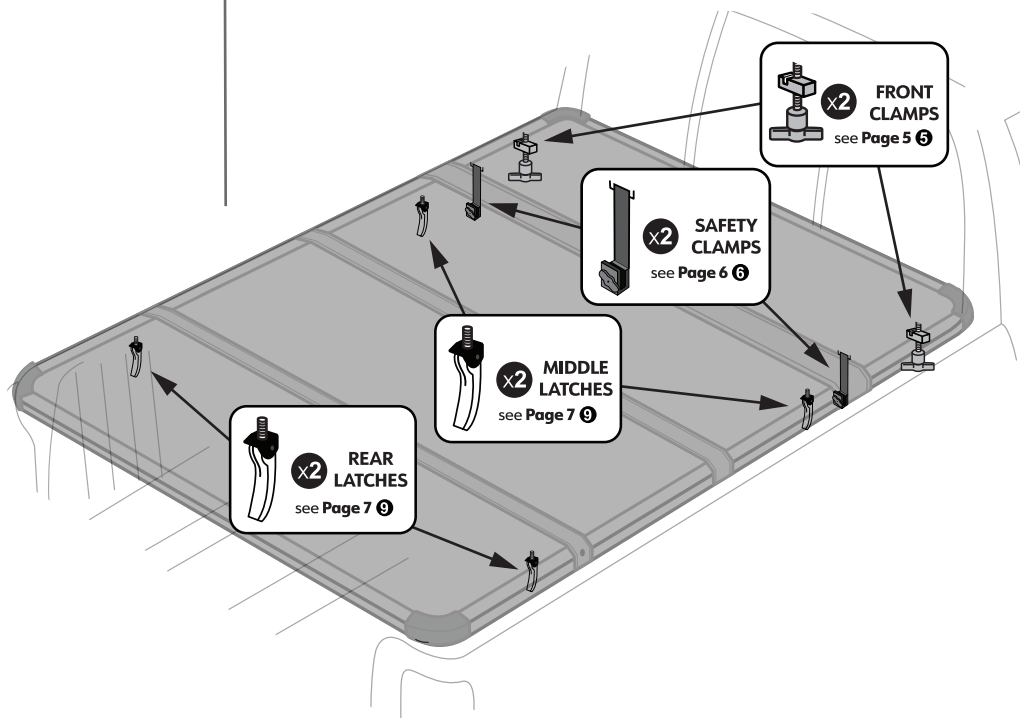

5 APPLYING FRONT CLAMPS ⓘ

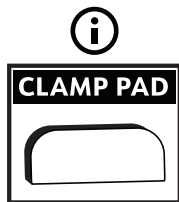

NOTE

Refer to **PAGE 4**
for the Front
Clamps location.

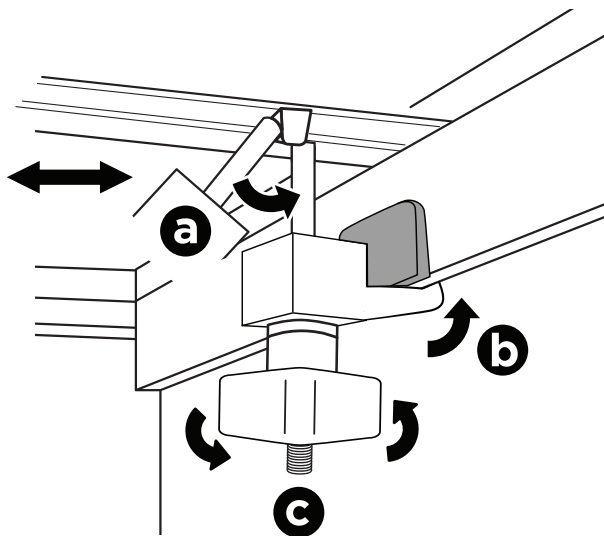
a

• PULL DOWN
FRONT CLAMPS
INTO VERTICAL
POSITION.

b

• HOOK THE JAW OF THE
CLAMP ONTO THE METAL
BED RAIL LIP. CLAMP PAD
CAN BE INSERTED TO
PROTECT THE PAINT.

c

• TURN THE KNOB UNTIL
SIDE Q-SEAL ON THE
COVER IS COMPRESSED
AND THE CLAMP IS
SNUG.

ⓘ

TYPE A

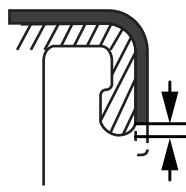
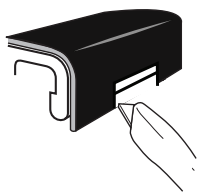

TYPE B

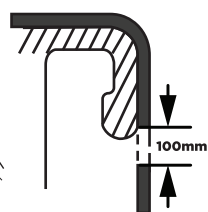
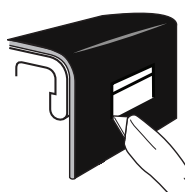
ⓘ

NOTE

For Type **A** or **B**
over-the rail bedliner
shown above, a small
hole large enough to fit
the clamp will need to
be cut so the clamp can
be fasten securely to
the **metal part** of the
truck bed lip!

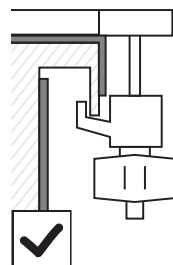
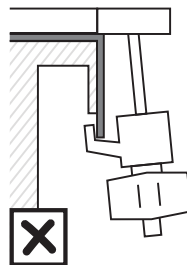
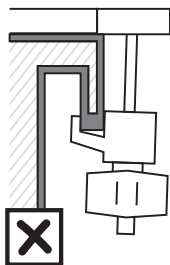



NOTE

Refer to **PAGE 4** for the Safety Clamps location.

YOU NEED

SP-BC0006



NOTE

Safety clamps must be secured properly to the metal part of the bed rail while the vehicle is in motion, otherwise the warranty will be voided.



ATTENTION

DO NOT use wrench or overtighten!

6 APPLYING SAFETY CLAMPS ⓘ

- TURN THE KNOB COUNTERCLOCKWISE TO LOOSEN THE SAFETY CLAMP WITH THE STRAP, ATTACH CLAMP TO THE METAL BED RAIL LIP ON BOTH SIDES, THEN TIGHTEN.

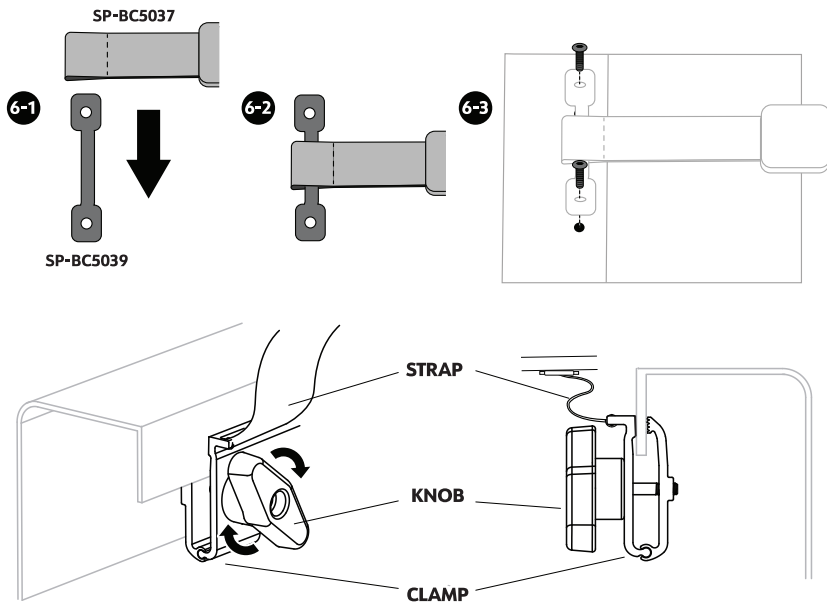

7 UNFOLD THE TONNEAU COVER

- Unfold the cover completely towards the tailgate.

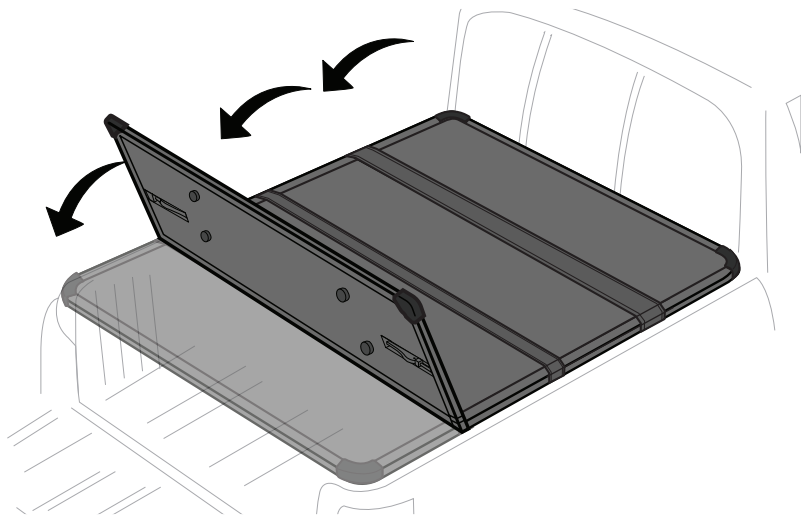



NOTE

All latches & clamps must make solid contact with the metal bed rail lip for the cover to be secured.

YOU NEED

SP-BC5038



NOTE

Refer to **PAGE 4** for the Rear Latch location.

8 ADJUST THE STOPPER

• FOR THE REAR LATCH, IF NEEDED, ADJUST STOPPER POSITION BY UNSCREWING THE BOLTS THEN SLIDE THE STOPPER TO THE OPTIMAL POSITION AND RESCREW.

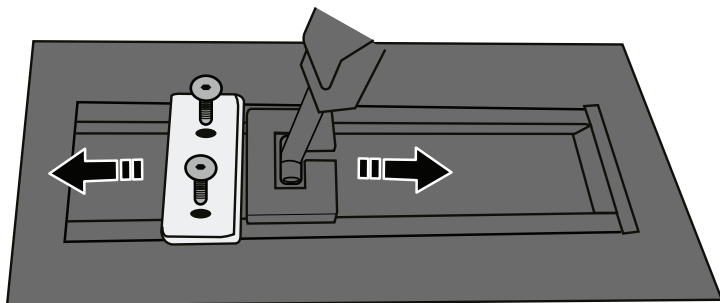

9 FASTENING REAR & MIDDLE LATCHES

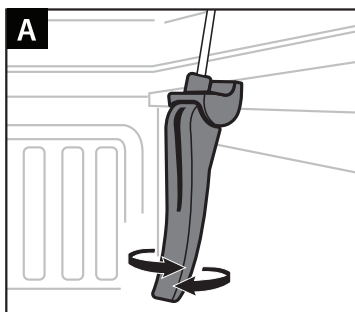

A: START BY PULLING DOWN LATCH HANDLE FROM THE BACK OF COVER. THEN UNSCREW THE HANDLE TO LOWER ITS POSITION.

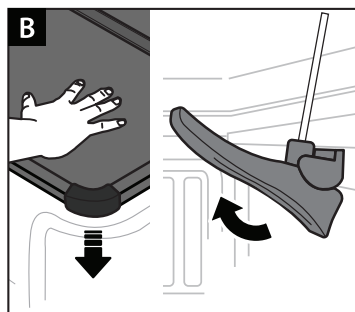

B: WITH ONE HAND, LIFT AND KEEP THE LATCH HANDLE POINTING UP AS MUCH AS POSSIBLE (BEYOND 90°). THEN, WITH THE OTHER HAND FIRMLY PRESSED DOWN ONTO THE COVER CORNER. CONTINUE TO ROTATE HANDLE TO ADJUST THE POSITION.

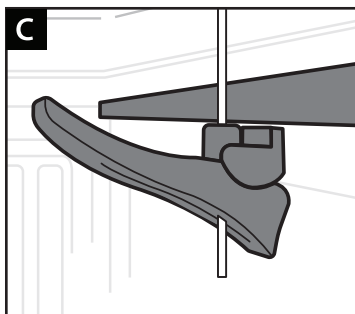

C: FOR THE TIGHTEST FIT, OPENING OF LATCH JAW SHOULD BE LEVEL WITH THE SIDE RAIL LIP WITHOUT LIMITING ACCESS TO THE JAW.

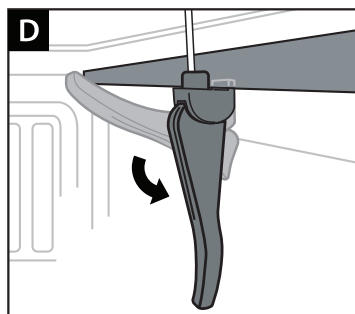

D: LATCH THE JAW GROOVE FULLY INTO THE RAIL LIP, THEN CRANK HANDLE DOWN TO TIGHTEN. GO BACK AND READJUST JAW POSITION FROM STEP B IF THE LATCH DOES NOT FEEL VERY TIGHT.

SEAL STRIP

10 CHECKING FOR GAPS ⓘ

- WITH THE TAILGATE OPEN, VISUALLY INSPECT FOR LIGHT LEAKING THROUGH THE GAPS. APPLY ADDITIONAL SEALING STRIPS TO FILL THE GAPS THEN REINSPECT AND REPEAT.

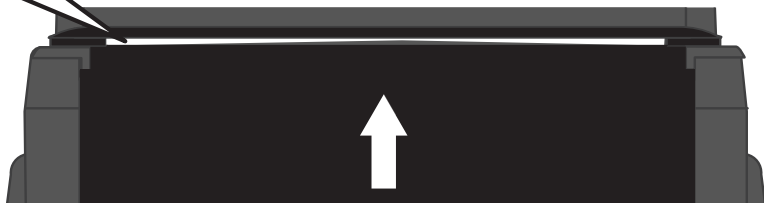
NOTE

Cover may not completely cover to the outside edge of the bed rails due to slight difference in truck bed shape for different year models

11 FINISHING INSTALLATION ⓘ

- AFTER REAR LATCHES ARE SECURELY FASTENED, SHUT & LOCK THE TAILGATE SO THE COVER CANNOT BE OPENED FROM THE OUTSIDE.

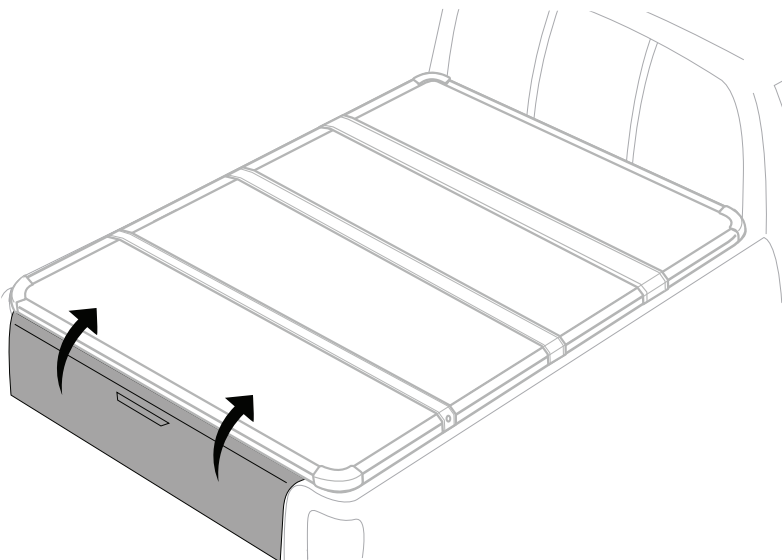

INSTALLATION COMPLETE!!!

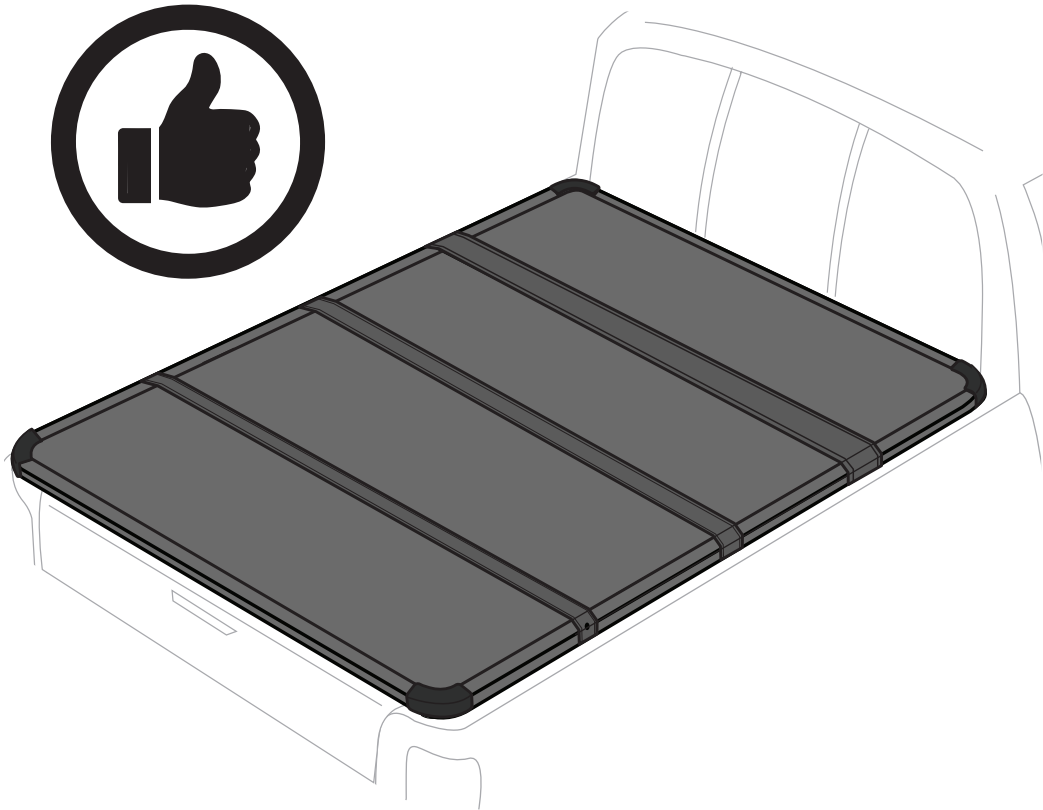

DO NOT
overload cargo



DO NOT place
sharp objects on top



Remove snow before
folding up cover



Secure strap buckles
before driving



Use seal strips for
Exposed gaps to
Avoid leaking



Use water and
soap to clean.
Avoid abrasive
chemical cleaners

AFTER INSTALLATION

12 FOLDING UP THE COVER

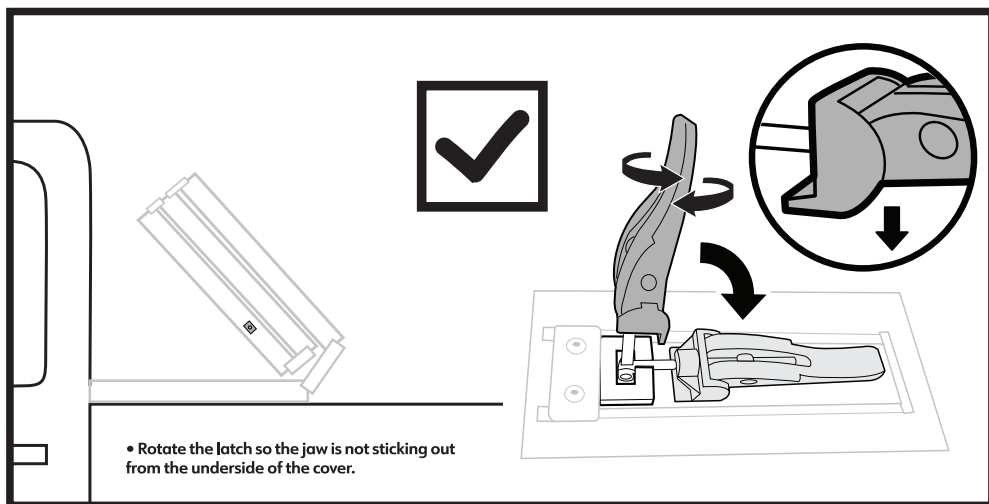
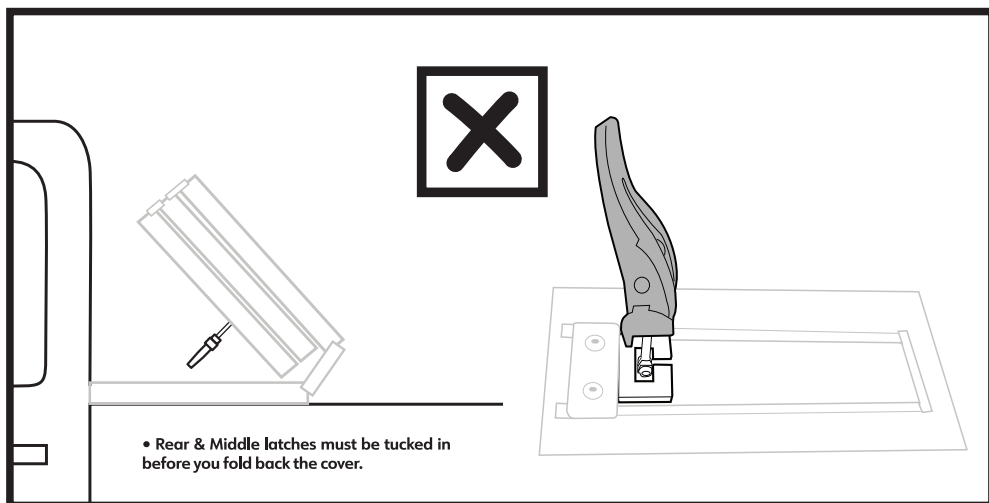

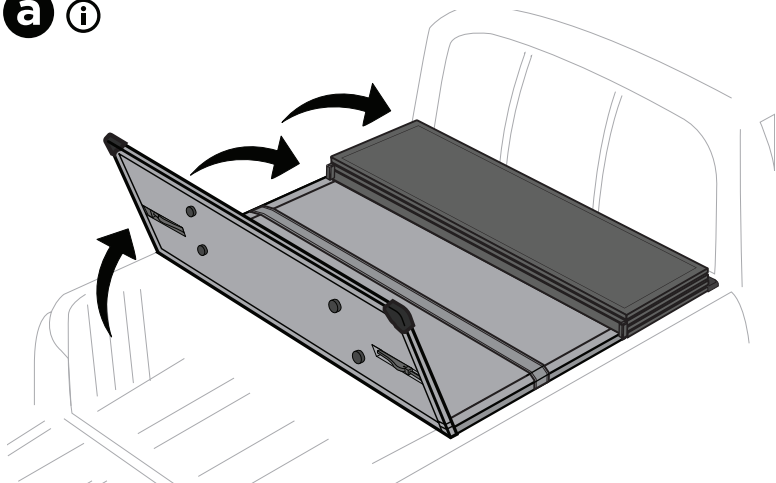

NOTE

DO NOT release the rear & middle latches, front clamps and safety clamps when you unfold the cover, and make sure they are all secured!

a 

b

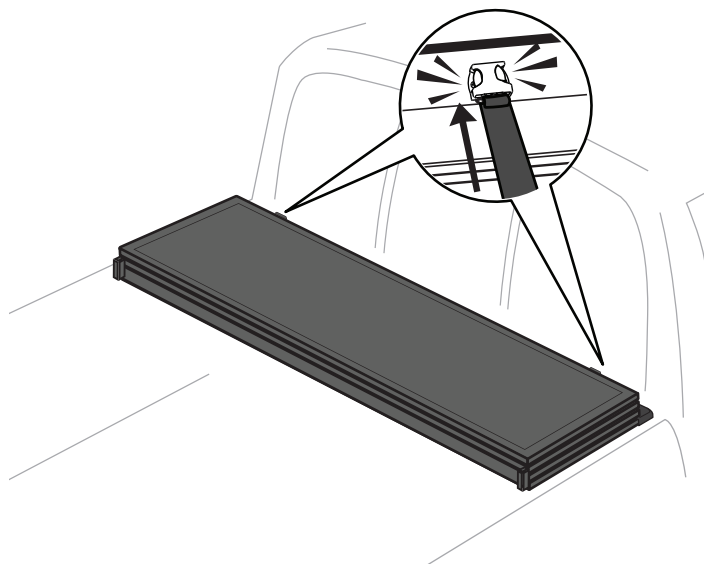
• ENSURE THE SAFETY BUCKLES ARE PROPERLY SECURED ON BOTH SIDES.

CLICK!!!



13 FOR MODELS WITH UTILITY TRACKS

For NISSAN FRONTIER

You will need:



SP-BC3005

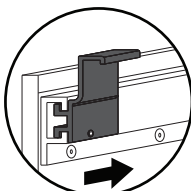

a Slide aluminum blocks into track

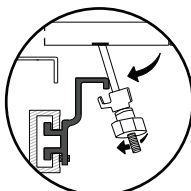

b Attach **Front Clamps** on to aluminum block

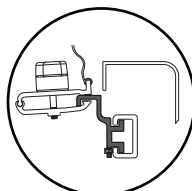

c Attach **Safety Clamps** on to aluminum block

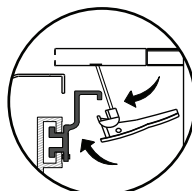

d Attach **Rear Latches** on to aluminum block

For NISSAN TITAN

You will need:



SP-BC3004

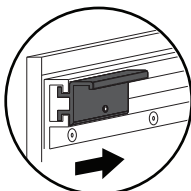

a Slide aluminum blocks into track

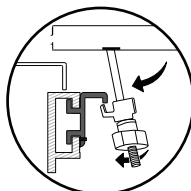

b Attach **Front Clamps** on to aluminum block

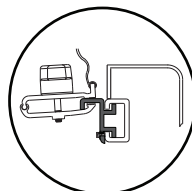

c Attach **Safety Clamps** on to aluminum block

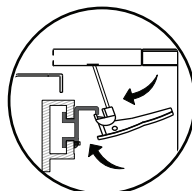

d Attach **Rear Latches** on to aluminum block

For TOYOTA TACOMA & TUNDRA

You will need:



SP-BC3003B

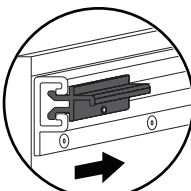

a Slide aluminum blocks into track

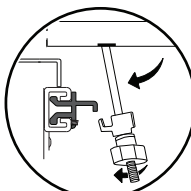

b Attach **Front Clamps** on to aluminum block

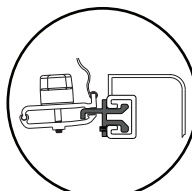

c Attach **Safety Clamps** on to aluminum block

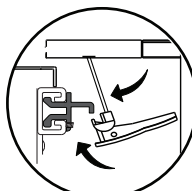

d Attach **Rear Latches** on to aluminum block