

T5 | ALLOY HARD FOLDING TONNEAU COVER

TRI-FOLD
For 2024 - Up TOYOTA TACOMA

⚠ ATTENTION ⚠

Read instructions carefully before starting installation. Remove contents from box and verify all parts are present. Failure to identify damage before installation could lead to rejection of any claim.

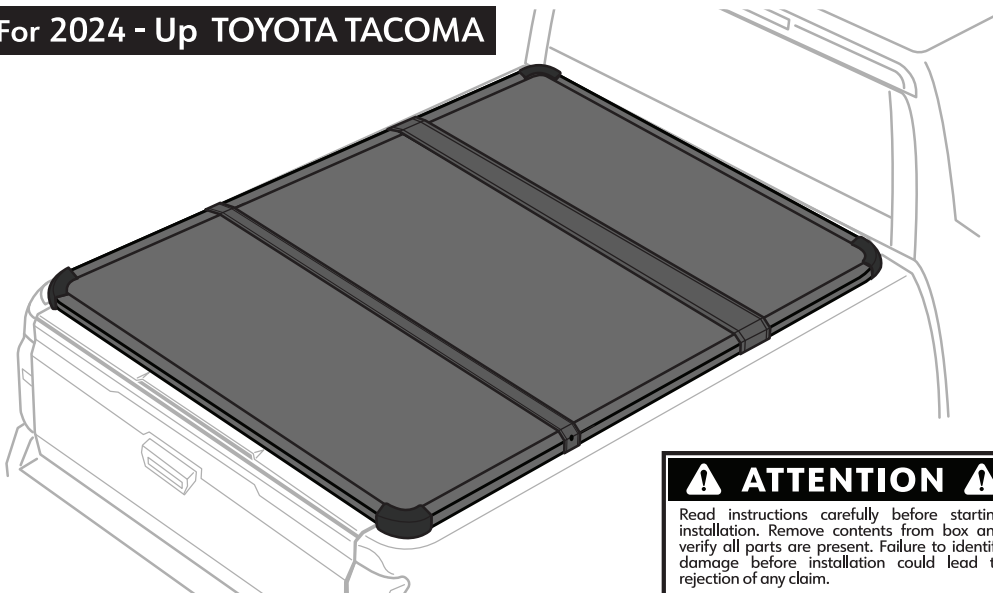

Scan to Download the Latest Digital Version

DAMAGED or MISSING PARTS?

NEED HELP?

contact us: **1-866-340-3038**

☒ Bed Cover

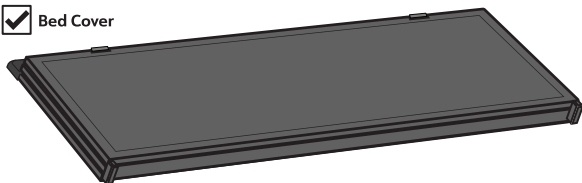

☒ SP-BC3003B



☒ SP-BC0006



☒ SP-BC0014 Front Seal Strip 150 x 2.0 x 0.4cm



☒ SP-BC5038



☒ SP-BC0016 Bulkhead Side Seal Strip 6.0 x 2.5 x 2.5cm



☒ SP-BC5037 Safety Clamp

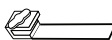

☒ SP-BC0017 Bulkhead Side Seal Foam 3.5 x 2.6 x 0.3cm



☒ SP-BC5039 Safety Clamp Fasteners



Apply on Front Utility Track

☒ SP-BC0015 Bulkhead Seal Strip 150 x 2.3 x 1.7cm



Only for **2024 Tacoma 5' or 6' Bed**

☐ SP-BC0018 Bulkhead Seal Strip 150 x 2.3 x 1.4cm



Only for **2025-Up Tacoma 5' Bed**

☐ SP-BC0019 Bulkhead Seal Strip 150 x 2.3 x 1.1cm



Only for **2025-Up Tacoma 6' Bed**

PARTS LIST



1 APPLYING SEAL STRIPS ⓘ

The Tacoma's front bed rail area requires sealing foams to fill the gaps on each side and to level the uneven surfaces around the bed rail.

ATTENTION: GAPS ON THE FRONT BED AND TAILGATE CAN CAUSE NOISE AND FLAPPING ISSUES WHILE DRIVING ALONG WITH WATER LEAKAGE.

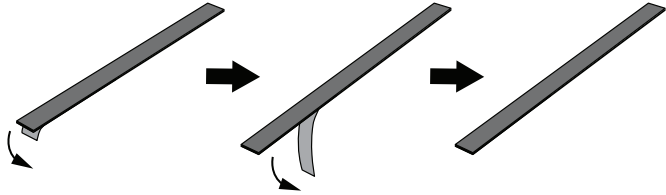

SP-BC0016



Bulkhead Side Seal Strip

Attached on each side to be used as a base for the long seal strips in Steps **b** and **c**.

a

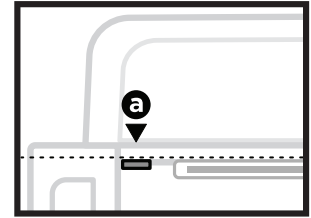
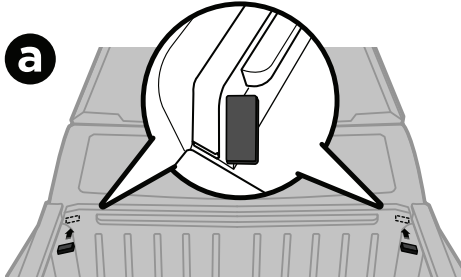

Bulkhead Seal Strip

Apply on Front Utility Track to level the lower bulkhead with the side bed rails

b

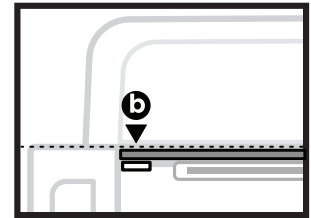
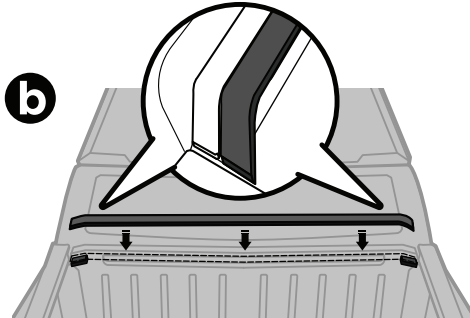

SP-BC0015 - Only for 2024 Tacoma 5' or 6' Bed

SP-BC0018 - Only for 2025-Up Tacoma 5' Bed

SP-BC0019 - Only for 2025-Up Tacoma 6' Bed

SP-BC0014



Front Seal Strip (0.4cm thick)

Used to level the front bed rail with the side bed rails.

c

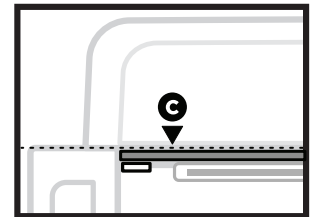
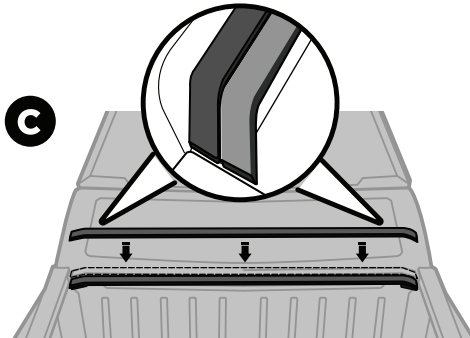



Slide these into the narrow gaps between the front and side bed panels.

d

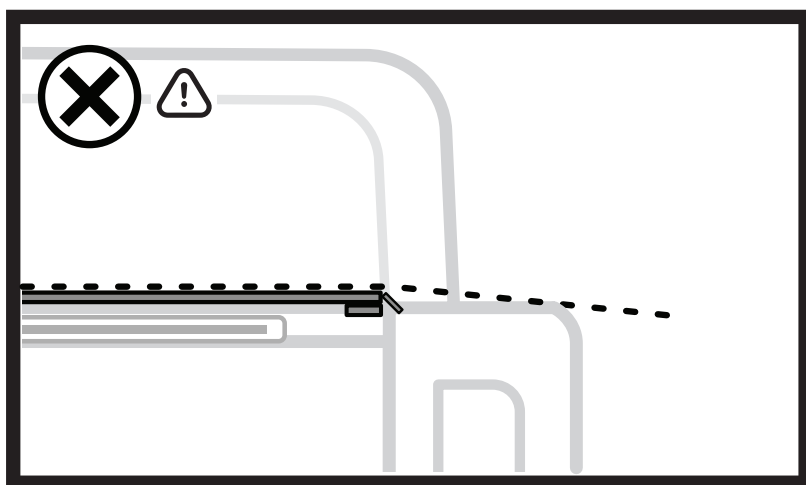
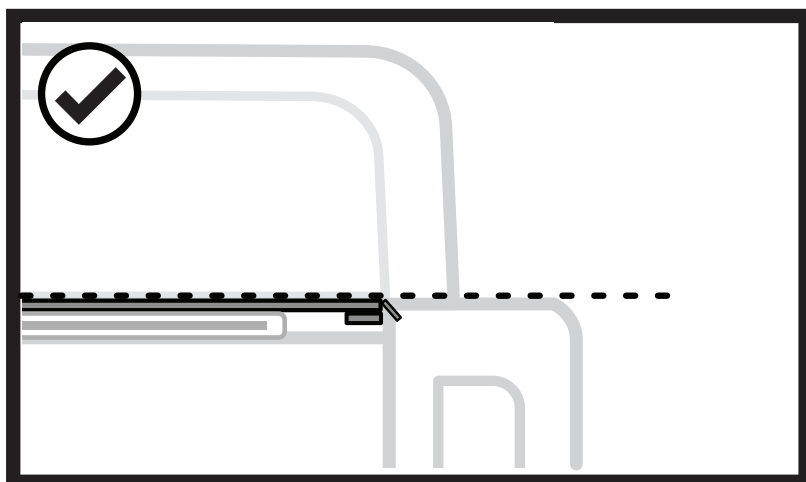
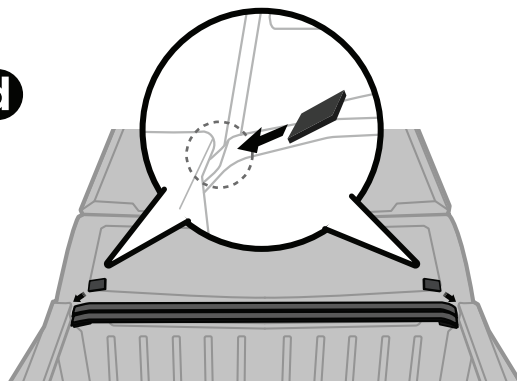

2 LAYING OUT THE COVER

- Place the folded cover assembly on the front bed rail.
- Release the safety buckles and fully unfold the cover towards the tailgate.

a

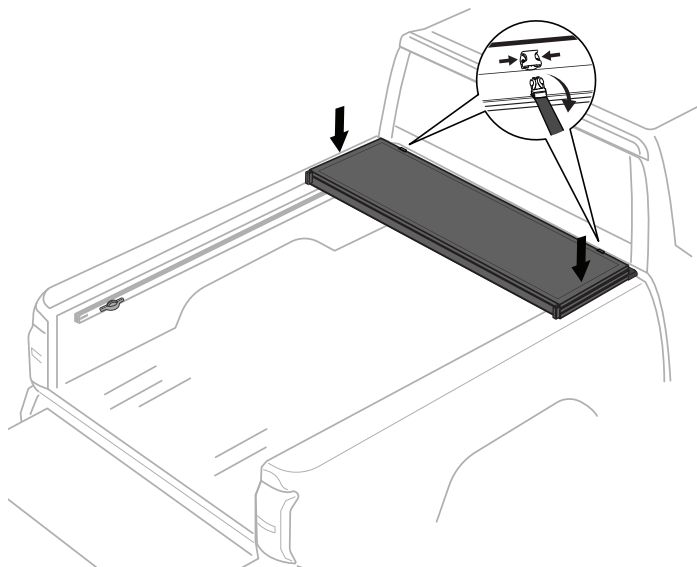

b

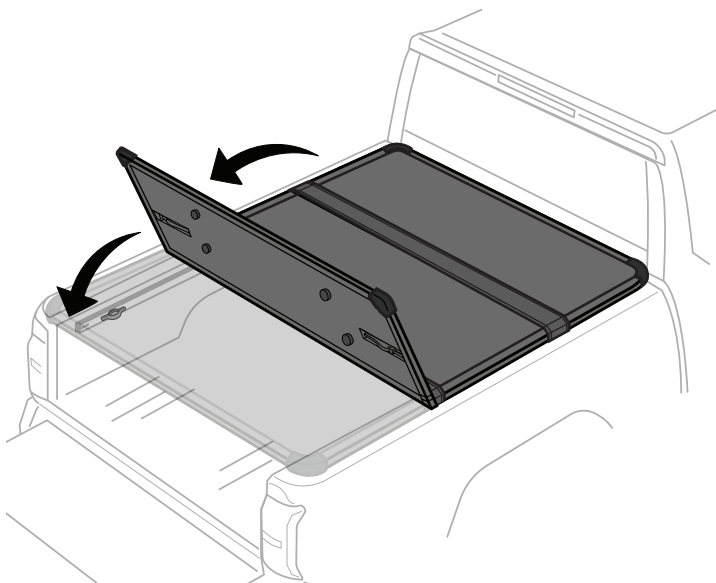

C

- C-1** • Align the front of the cover against the outer edge at the midpoint of the front bed rail.
- C-2** • Align both sides of the cover evenly on the side bed rails. The width of the cover does not cover all the way to the outer edges of the side rails.

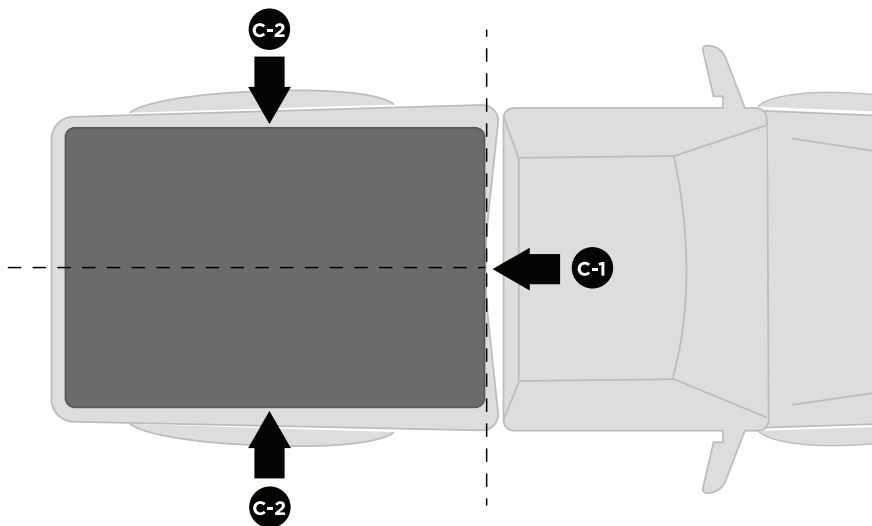

3 FOLDING BACK THE COVER

- Carefully refold the cover without moving its position on the truck bed.

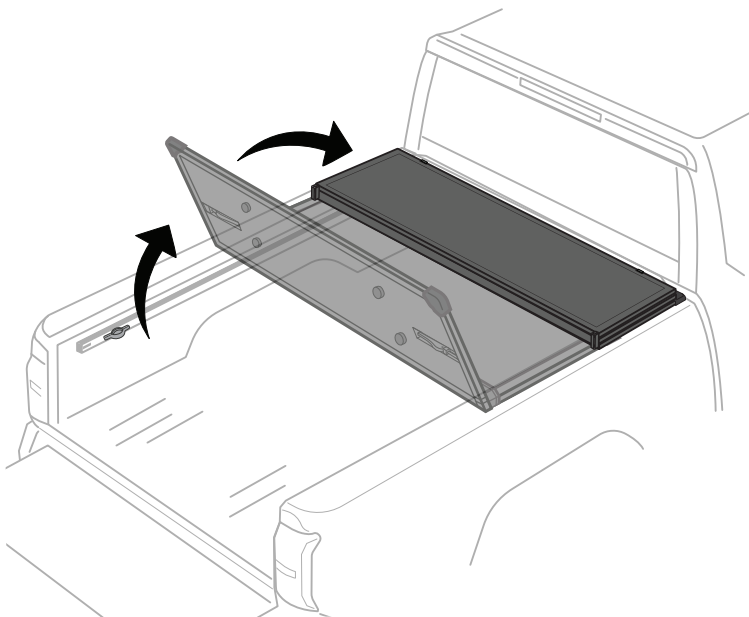

4 INSTALL THE ALTERNATE BRACKETS

Models with utility tracks require alternate brackets to access the bed railing lip. First, remove any tie-down anchors installed along the tracks. Then, slide in the alternate brackets and position them aligned with the cover dampers. Slide anchors back in between the brackets if needed.

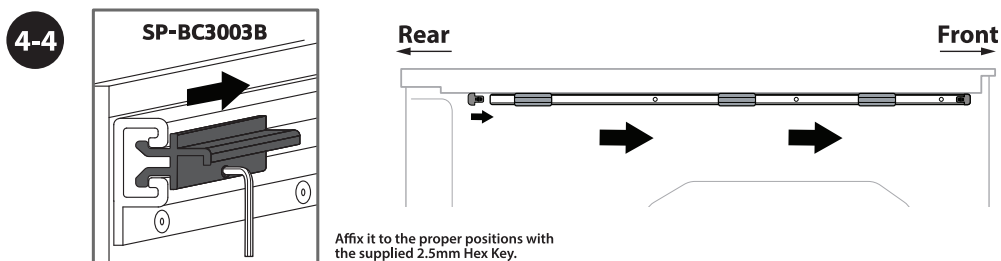
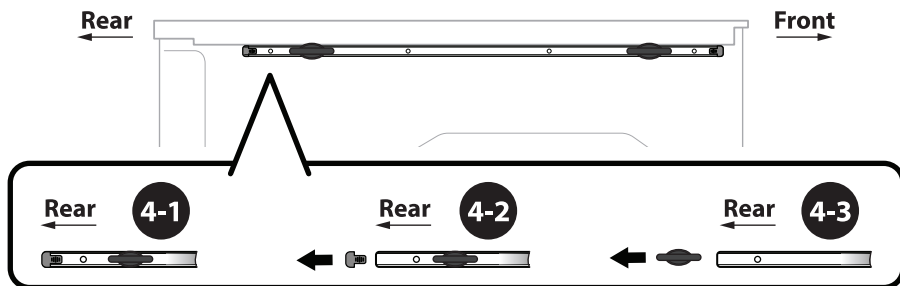

5 CLAMPS & LATCHES OVERVIEW

• The clamps and latches are already attached to the assembled cover.

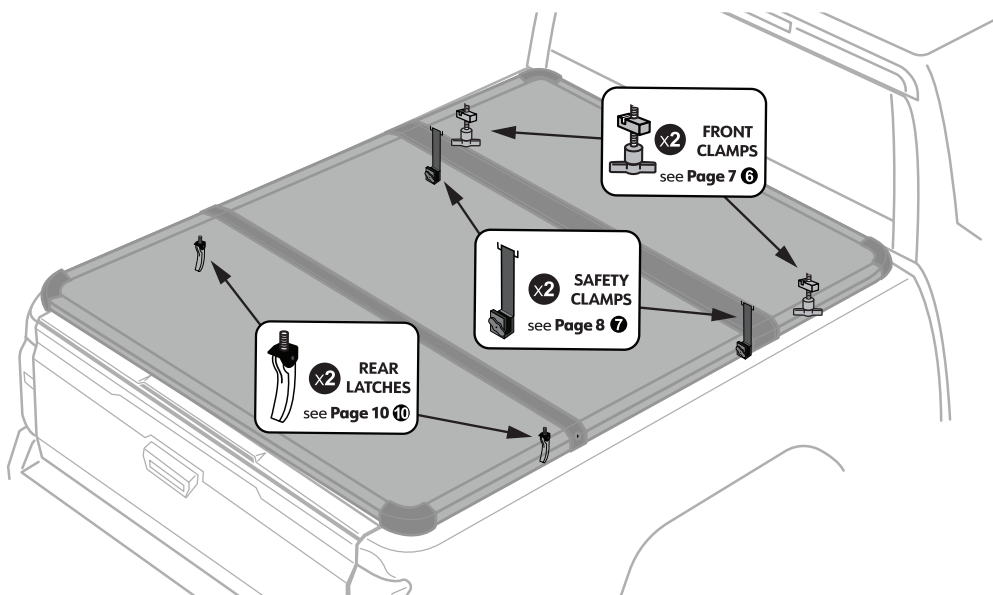

⑥ APPLYING FRONT CLAMPS ⓘ

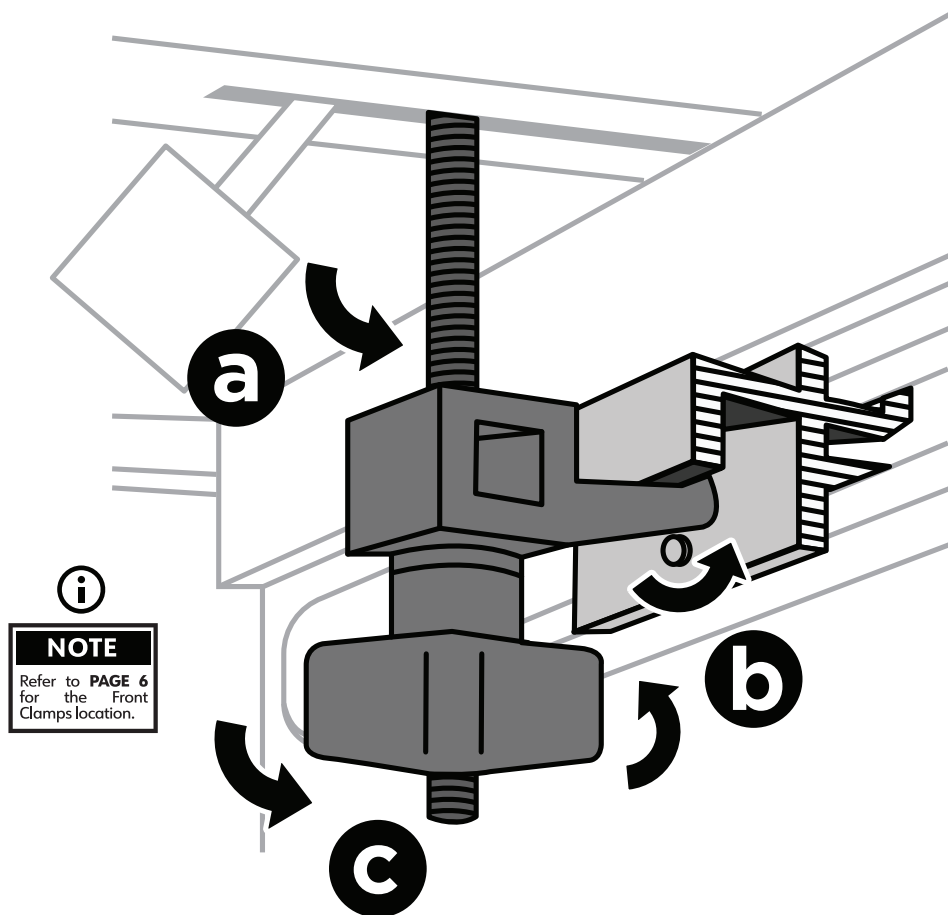

a

• Pull down front clamps into vertical position.

b

• Hook the jaw of the clamp onto the metal bed rail lip. Clamp pad can be inserted to protect the paint.

c

• Turn the knob until side q-seal on the cover is compressed and the clamp is snug.

7 APPLYING SAFETY CLAMPS ⓘ



NOTE

Refer to **PAGE 6**
for the Safety
Clamps location.

SP-BC5037

7-1

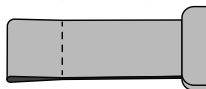

SP-BC5039

7-2

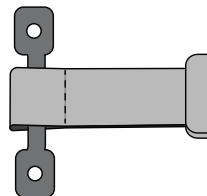

7-3

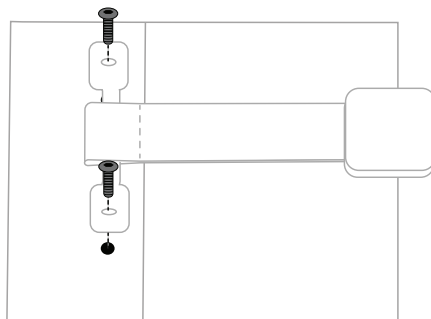

- Turn the knob counterclockwise to loosen the safety clamp with the strap, attach clamp to the metal bed rail lip on both sides, then tighten.

Strap

Knob

Clamp

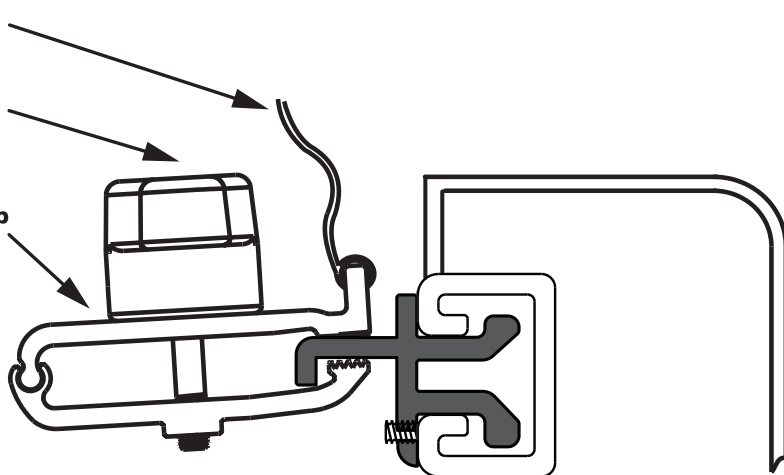

8 UNFOLD THE TONNEAU COVER

- Unfold the cover completely towards the tailgate.

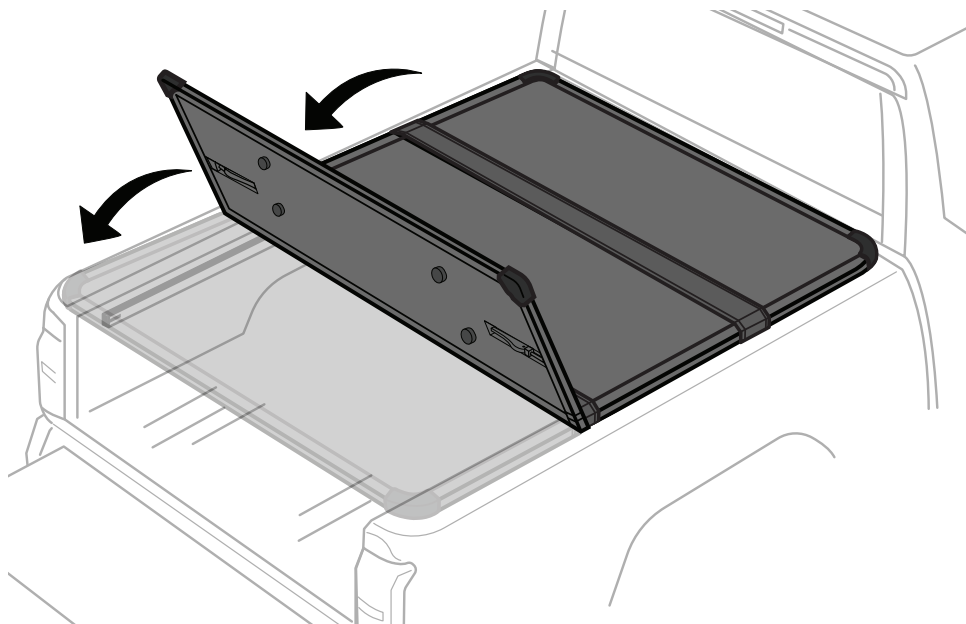

NOTE

All latches & clamps must make solid contact with the metal bed rail lip for the cover to be secured.

YOU NEED

SP-BC5038



9 ADJUST THE STOPPER ⓘ

- FOR THE REAR LATCH, IF NEEDED, ADJUST STOPPER POSITION BY UNSCREWING THE BOLTS THEN SLIDE THE STOPPER TO THE OPTIMAL POSITION AND RESCREW.

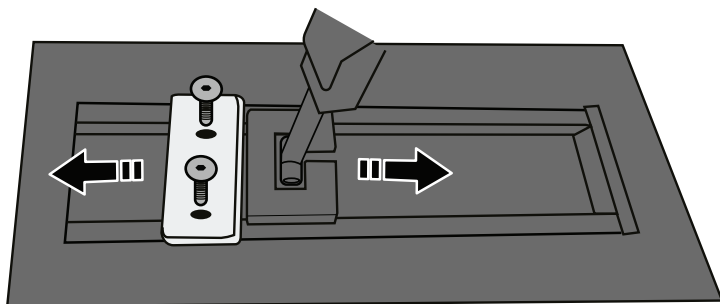



10 FASTENING REAR LATCHES ⓘ



NOTE

Refer to **PAGE 6**
for the Rear Latch
location.

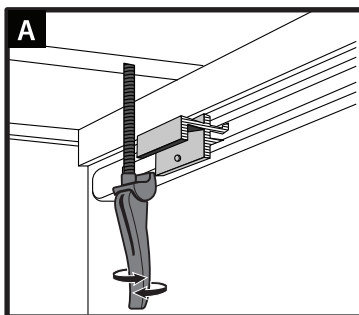

A: Start by pulling down latch handle from the back of cover. Then unscrew the handle to lower its position.

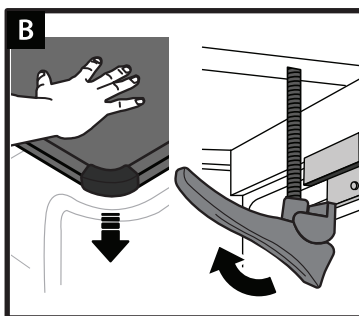

B: With one hand, lift and keep the latch handle pointing up as much as possible (beyond 90°). Then, with the other hand firmly pressed down onto the cover corner. Continue to rotate handle to adjust the position.

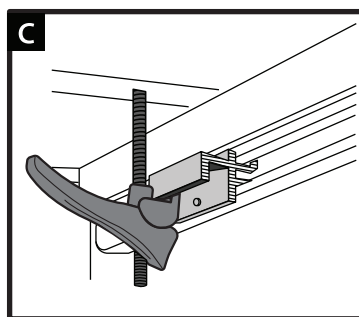

C: For the tightest fit, opening of latch jaw should be level with the side rail lip without limiting access to the jaw.

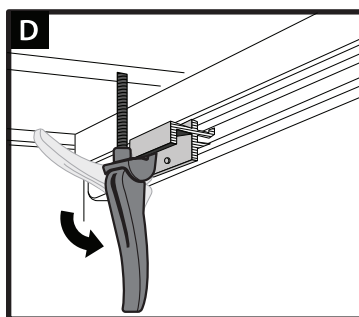

D: Latch the jaw groove fully into the rail lip, then crank handle down to tighten. Go back and readjust jaw position from step b if the latch does not feel very tight.

11 CHECKING FOR GAPS ⓘ

- With the tailgate open, visually inspect for light leaking through the gaps. Apply additional sealing strips to fill the gaps then reinspect and repeat.

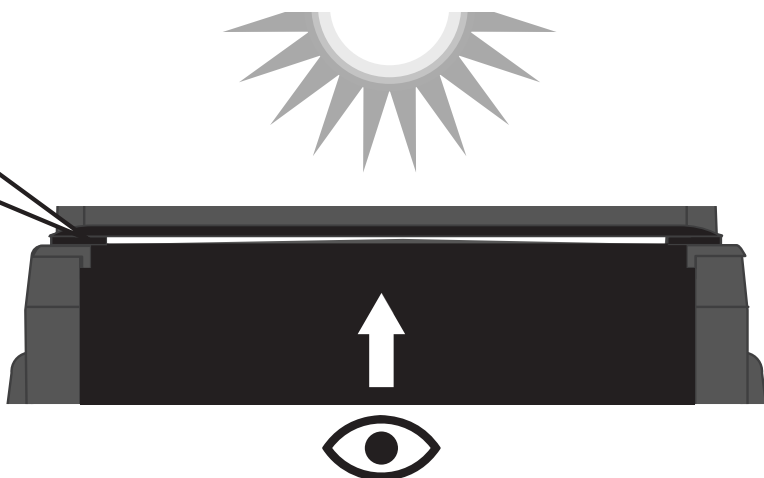

12 FINISHING INSTALLATION

- After rear latches are securely fastened, shut & lock the tailgate so the cover cannot be opened from the outside.

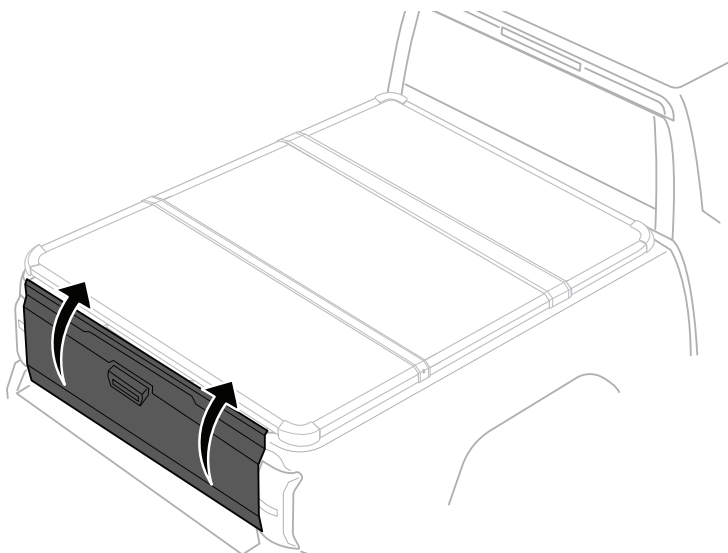

INSTALLATION COMPLETE!!!

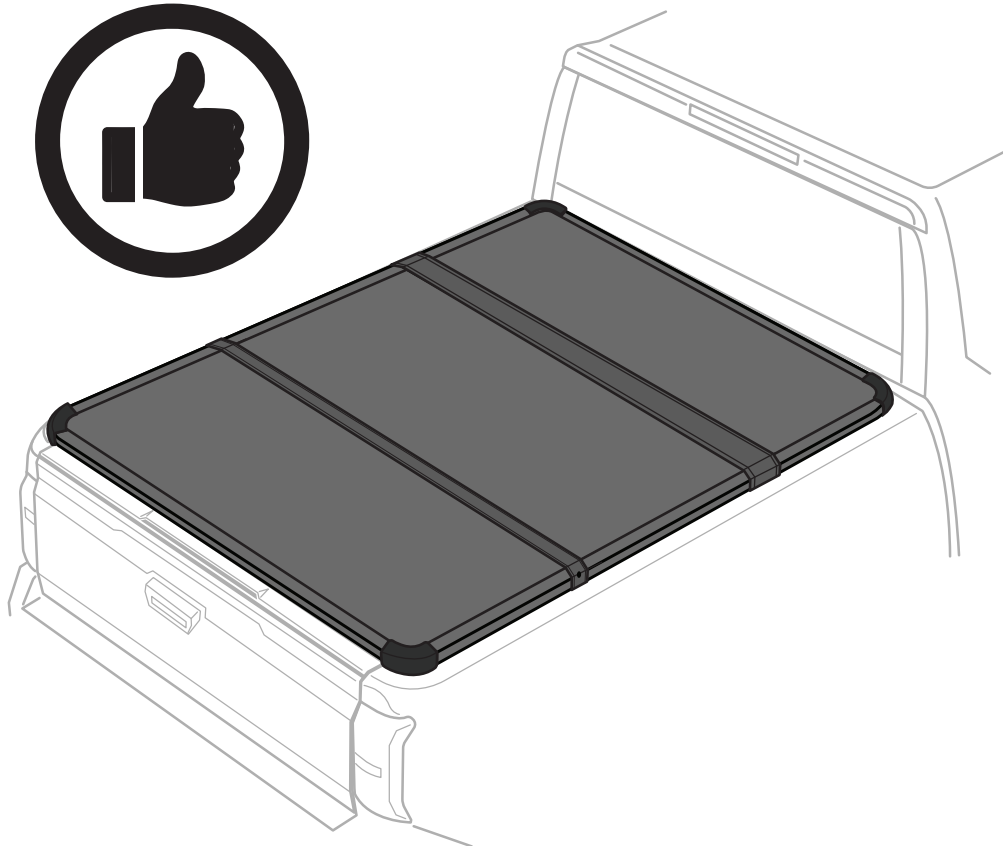

DO NOT
overload cargo



DO NOT place
sharp objects on top



Remove snow before
folding up cover



Secure strap buckles
before driving



Use seal strips for
Exposed gaps to
Avoid leaking



Use water and
soap to clean.
Avoid abrasive
chemical cleaners

AFTER INSTALLATION

13 FOLDING UP THE COVER

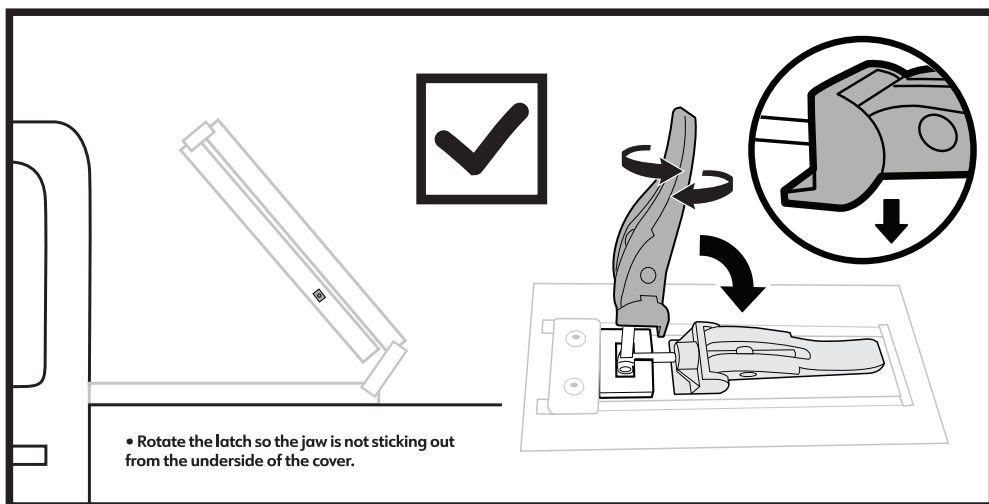
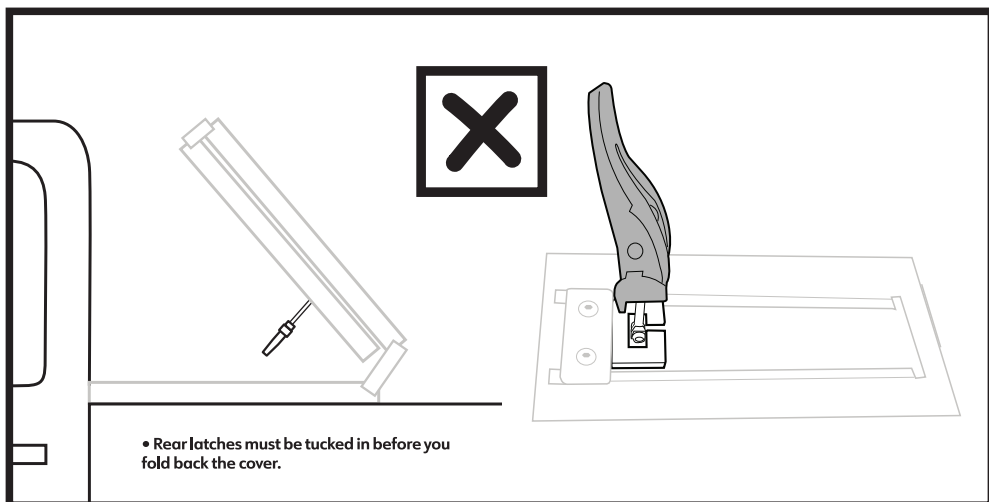



NOTE

DO NOT release the front clamps and safety clamps when you unfold the cover, and make sure they are all secured!

a 

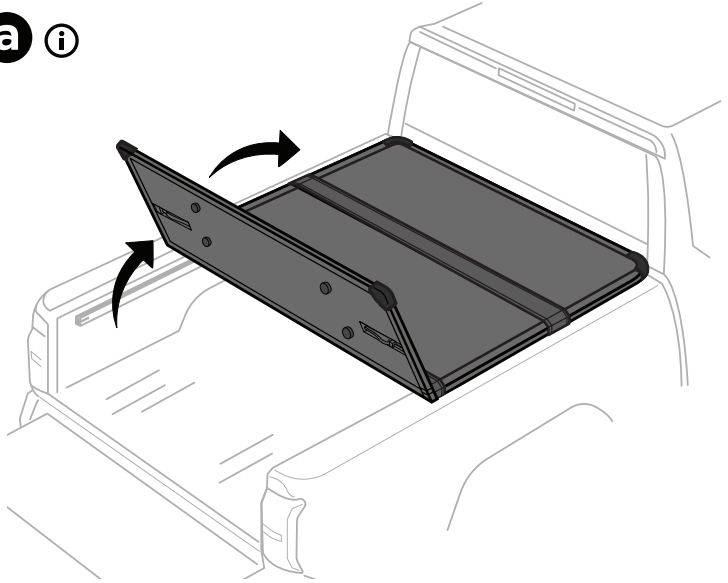

b

- Ensure the safety buckles are properly secured on both sides.

CLICK!!!

