



## BLADE®

TG-BL2F7068

### BEFORE INSTALLATION

READ INSTRUCTIONS CAREFULLY BEFORE STARTING INSTALLATION. REMOVE CONTENTS FROM BOX AND VERIFY ALL PARTS ARE PRESENT. ASSISTANCE IS RECOMMENDED. FAILURE TO IDENTIFY DAMAGE BEFORE INSTALLATION COULD LEAD TO A REJECTION OF ANY CLAIM. IF ANY DAMAGE FOUND, PLEASE TAKE A PICTURE FOR THE CLAIM PURPOSE. PLEASE ALSO SEND THE PICTURES, ORDER NUMBER, AND DETAILS OF THE ISSUE TO [SUPPORT@TYGERAUTO.COM](mailto:SUPPORT@TYGERAUTO.COM).

### Torque Value

Fastener Size	Class 8.8 Tightening Torque (ft-lbs)	Class10.9 Tightening Torque (ft-lbs)
6mm	6-7	6-7
8mm	15-16	22-23
10mm	31-32	44-45
12mm	54-55	78-79
14mm	87-88	125-126

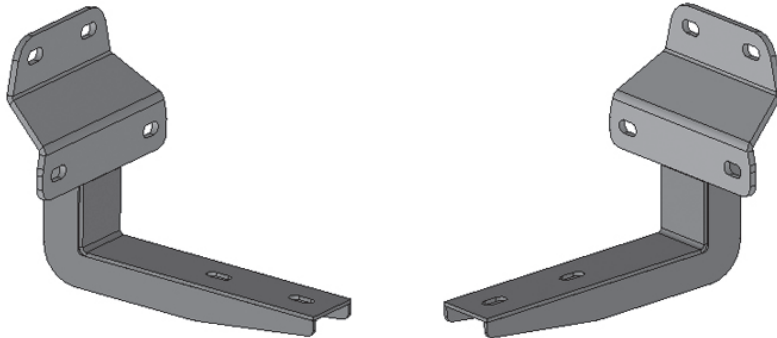

(4) Left or Right Mounting Brackets

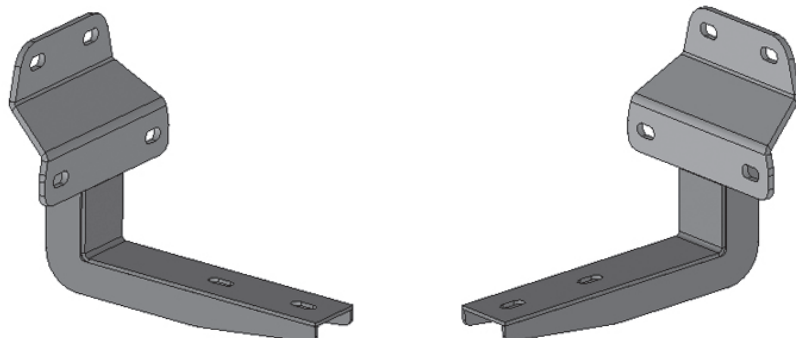

### Parts List

- x2 78" TYGER Blade Running Boards
- x4 Universal Mounting Brackets (left or right)
- x4 8-1.25mm Double Bolt Plates
- x12 8mm Plastic Retainers
- x12 8mm Lock Washers
- x20 8mm x 24mm x 2mm Flat Washers
- x12 8-1.25mm Hex Nuts
- x8 8-1.25mm Nylon Lock Nuts

### Tool Needed:

- 13mm Socket
- 13mm Wrench



# TYGER®

## STEP 1

Start the installation under the passenger/right side of the vehicle. Locate the front factory running board mounting location along the inner side of the body, (Fig 1).

## STEP 2

Slide (1) Plastic Retainer over each of the (3) factory mounting studs in the body panel, (Figs 2-3).

**IMPORTANT:** The Plastic Retainers are designed to prevent corrosion between the aluminum body panel and the steel mounting brackets. Do not install the Brackets without the Plastic Retainers.

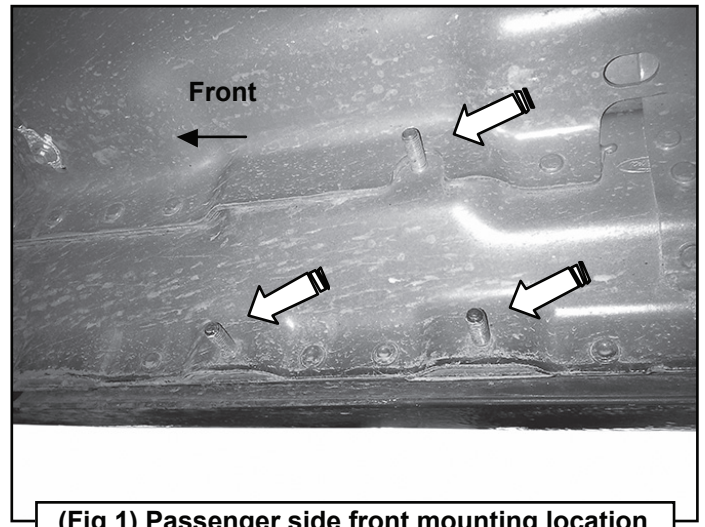

(Fig 1) Passenger side front mounting location

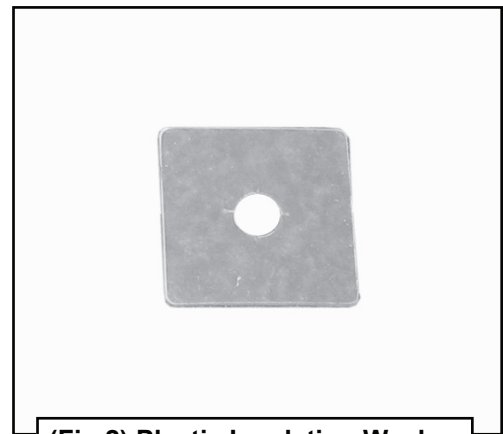

(Fig 2) Plastic Insulation Washer

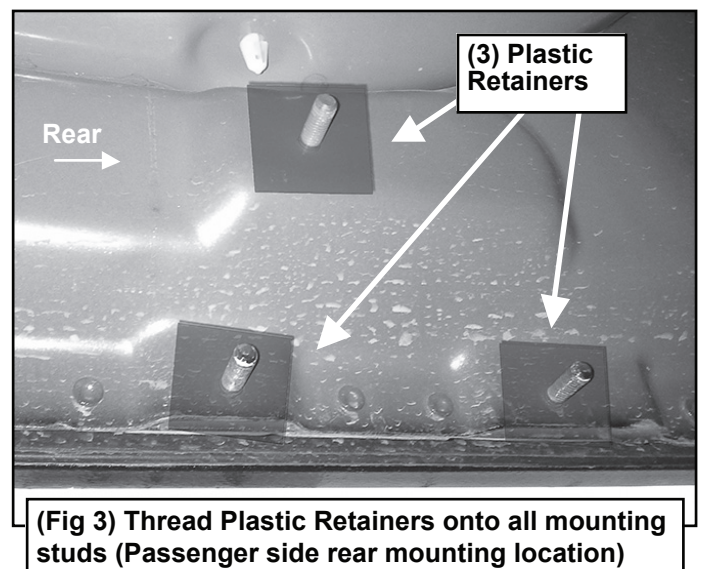

(Fig 3) Thread Plastic Retainers onto all mounting studs (Passenger side rear mounting location)



## STEP 3

Select (1) Mounting Bracket.

**NOTE:** All (4) Brackets are universal and will fit left or right side. Attach the Mounting Bracket to the (3) factory studs with (3) 8mm Flat Washers, (3) 8mm Lock Washers and (3) 8mm Hex Nuts, (Figs 4-5). Leave bracket loose at this time.

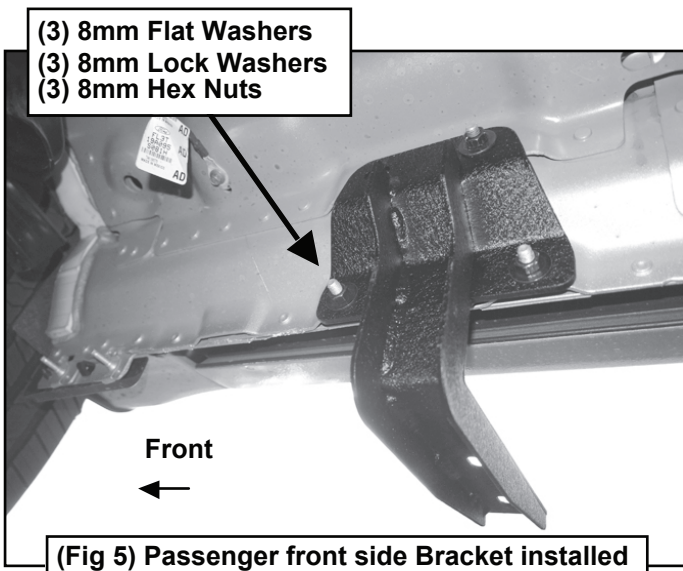
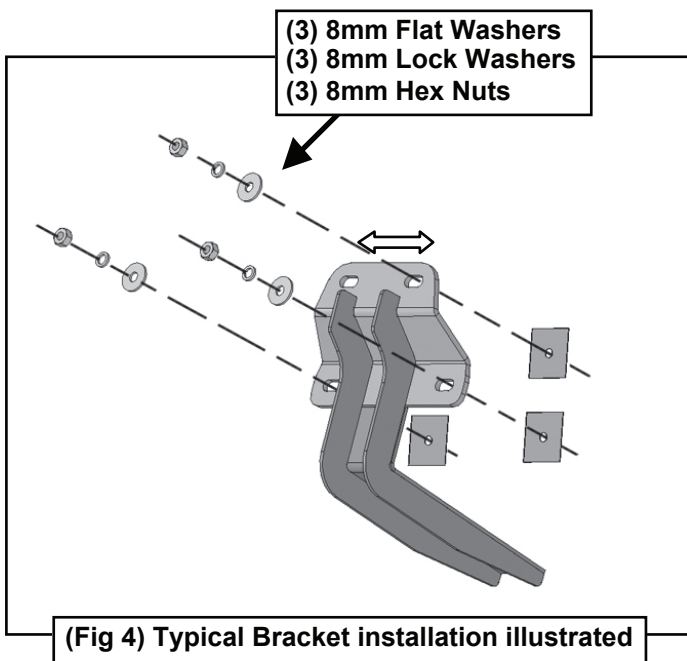

## STEP 4

Repeat Steps 1-3 for Bracket installation on the passenger/right rear side, (Fig 6).

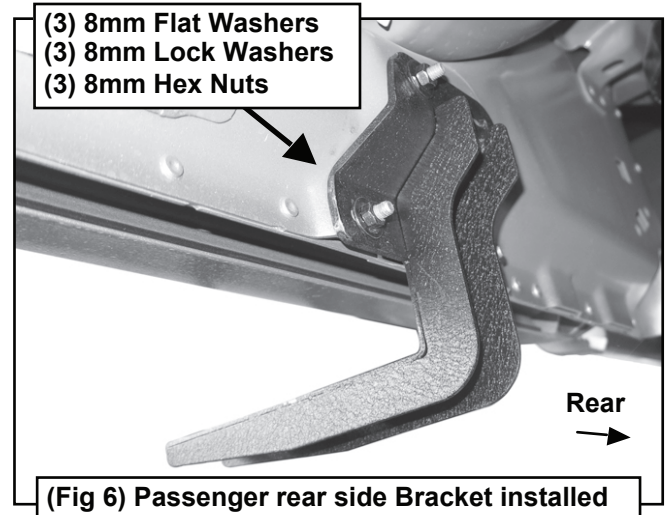

## STEP 5

Select (1) Running Board. Place the Running Board on top of the Brackets. Locate the channel in the bottom of the Running Board. Select (2) 8mm Double Bolt Plates. Insert the Bolt Plates into the channel in the bottom of the Running Board closest to the Brackets, (Fig 7). Lift the Running Board up and guide the studs through the Brackets

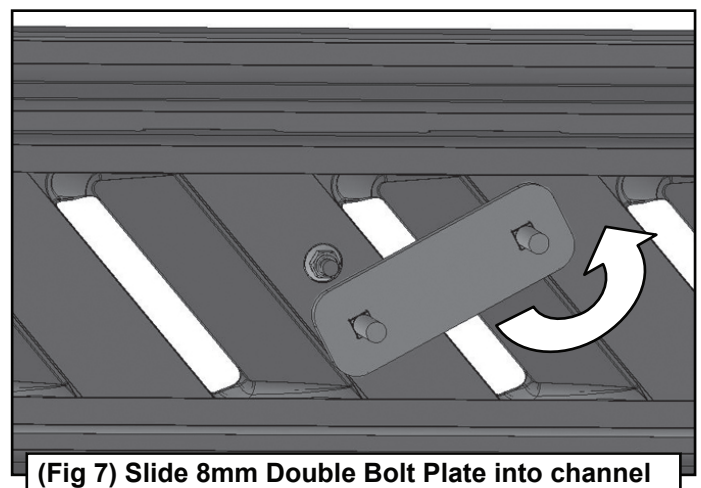



# TYGER®

## STEP 6

Attach the Running Board to the Brackets with (4) 8mm Flat Washers and (4) 8mm Nylon Lock Nuts, (Figs 8-9). Do not tighten hardware.

## STEP 7

Level and adjust the Running Board as necessary and fully tighten all hardware.

## STEP 8

Repeat Steps 1-7 for the Driver/left side Running Board installation.

## STEP 9

Do periodic inspections to the installation to make sure that all hardware is secure and tight.

