



TYGER®

TYGER FURY™

TG-BP9J81198

BEFORE INSTALLATION

READ INSTRUCTIONS CAREFULLY BEFORE STARTING INSTALLATION. REMOVE CONTENTS FROM BOX AND VERIFY ALL PARTS ARE PRESENT. FAILURE TO IDENTIFY DAMAGE BEFORE INSTALLATION COULD LEAD TO A REJECTION OF ANY CLAIM. IF MISSING PARTS OR ANY DAMAGE FOUND, PLEASE TAKE A PICTURE FOR THE CLAIM PURPOSE. TO FILE YOUR CLAIM, PLEASE VISIT: WWW.TYGERAUTO.COM/CONTACT

TORQUE VALUES

Fastener Size	Class 8.8 Torque (ft-lbs)	Class 10.9 Torque (ft-lbs)
6mm	6-7	6-7
8mm	15-16	22-23
10mm	31-32	44-45
12mm	54-55	78-79
14mm	87-88	125-126

Parts List

- x1 TYGER Rear Bumper
- x1 License Plate Bracket
- x1 License Plate Bracket Base Seal
- x1 License Plate Light
- x2 Plastic Plugs
- x4 Sensor Retaining Rings
- x4 Sensor Foam Spacers
- x4 Sensor Sealing Washers
- x4 Sensor Rubber Plugs
- x4 Sensor Cover Kit
- x1 14-1.50mm Fine Thread Double Nut Plate
- x2 14-1.50mm x 55mm Fine Thread Hex Bolts
- x2 14mm x 28mm x 3mm Flat Washers
- x2 14mm Lock Washers
- x2 8mm x 25mm Button Head Bolts
- x4 8mm x 16mm x 1.6mm Flat Washers
- x2 8mm Nylon Lock Nuts
- x8 4mm x 10mm Button Head Bolts
- x1 5mm Wrench
- x1 4mm Wrench
- x1 2.5mm Wrench

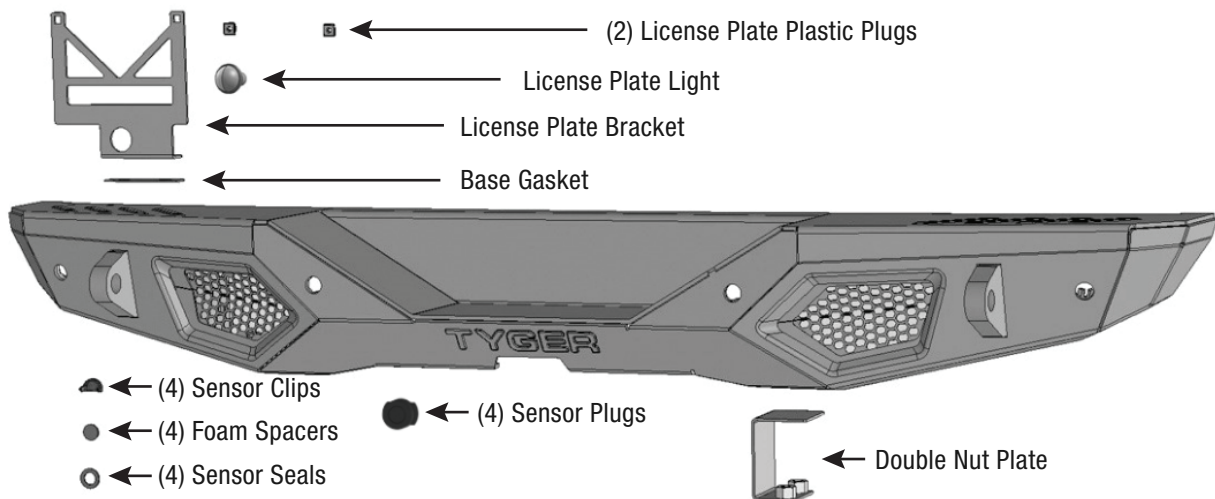



TYGER®

PROCEDURE:

REMOVE CONTENTS FROM BOX. VERIFY ALL PARTS ARE PRESENT. READ INSTRUCTIONS CAREFULLY BEFORE STARTING INSTALLATION. WARNING: ALLOW TIME FOR THE MUFFLER TO COMPLETELY COOL BEFORE REMOVING REAR BUMPER.

STEP 1

Start installation from under the driver/left side of the rear bumper. Remove the plastic cover from the back of the rear wheel opening, (Fig 1). Locate and remove the (2) hex bolts attaching the outer bracket running from the side of the frame to the outer end of the bumper, (Fig 2). Remove the (2) hex bolts attaching the bottom of the bumper to the rear crossmember if equipped, (Fig 3). Repeat this STEP on the passenger/right side of the vehicle.

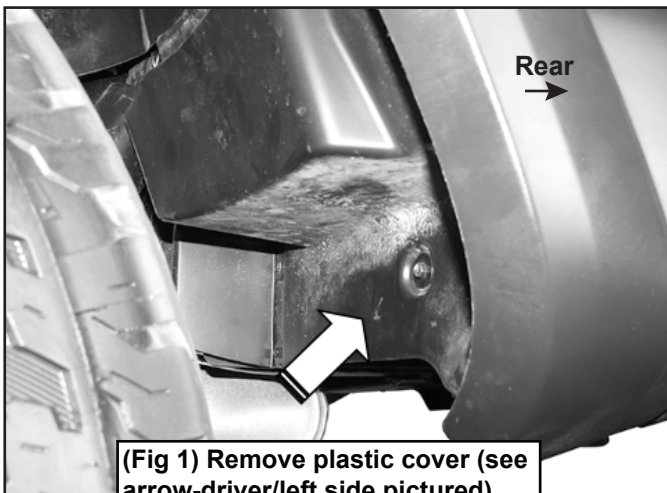

(Fig 1) Remove plastic cover (see arrow-driver/left side pictured)

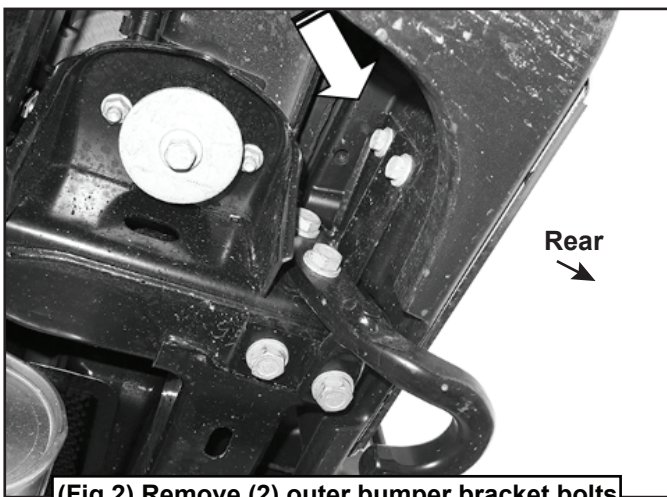

(Fig 2) Remove (2) outer bumper bracket bolts

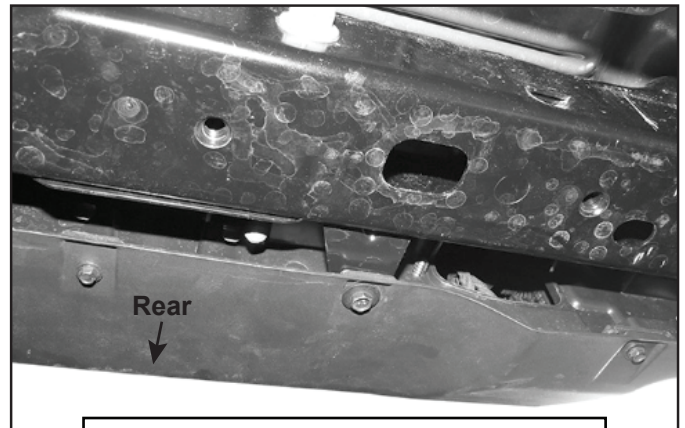

(Fig 3) Remove (2) hex bolts attaching bottom of bumper to frame cross member

STEP 2

Unplug the wiring harness leading to the rear bumper.

STEP 3

With assistance, remove the (4) hex nuts attaching the bumper to the inner bumper brackets, (Fig 4). Slide bumper off of the inner and outer bumper brackets.

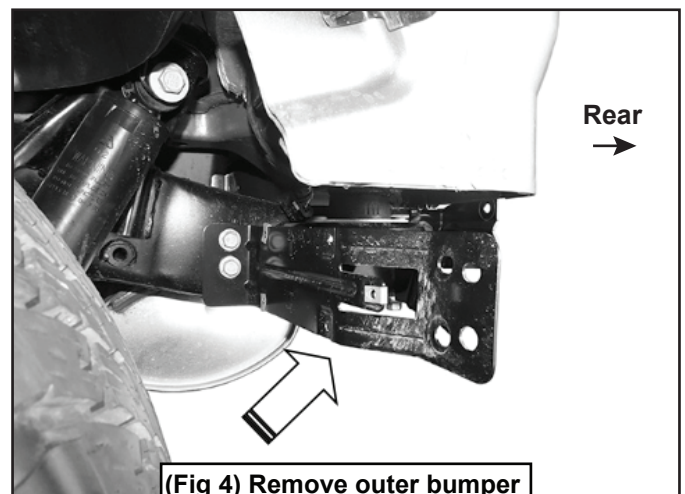

(Fig 4) Remove outer bumper bracket from side of frame



TYGER®

STEP 4

Remove the driver/left outer bumper bracket attached to the side of the frame, (Fig 4). Next, remove the (2) hex bolts attaching the tow hook to the side of the frame and remove the inner bumper bracket, (Fig 5).

NOTE: It may be necessary to loosen the (2) bolts attaching the tow hook to the bottom of the frame to remove the bumper bracket.

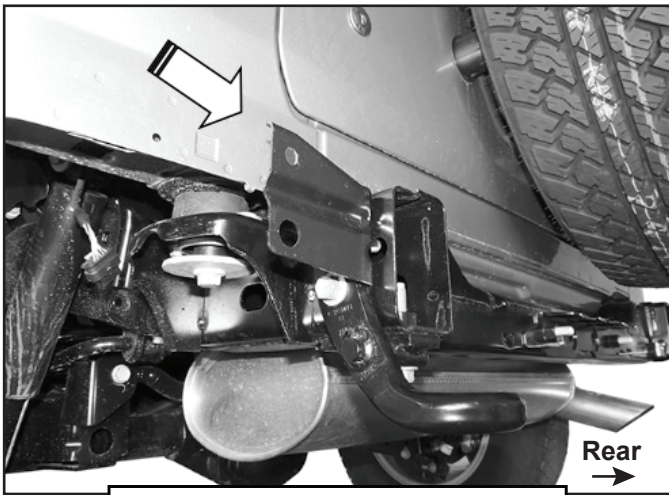

(Fig 5) Remove tow hook and inner bumper bracket from side of frame

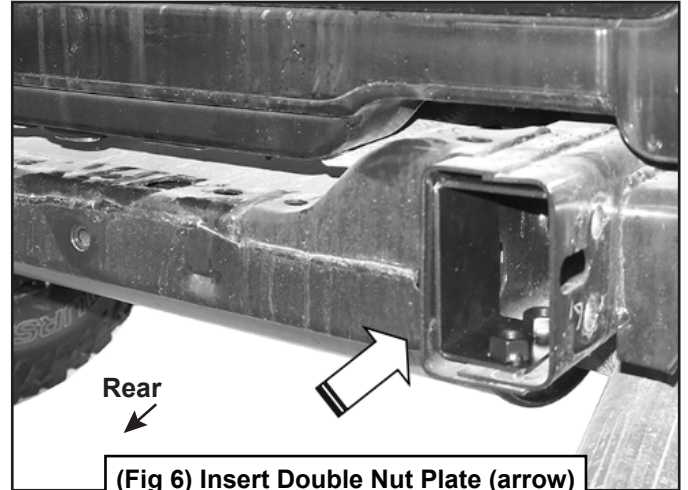

(Fig 6) Insert Double Nut Plate (arrow) into passenger/right end of frame

STEP 7

Determine if accessory lights will be installed. Remove screens covering light openings and install lights, (available separately), before installing Bumper, (Fig 7).

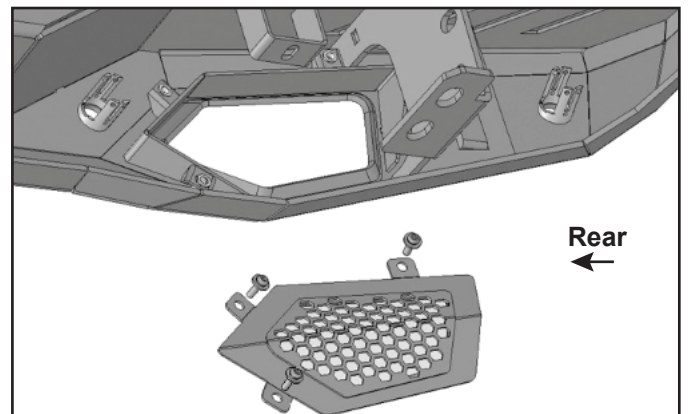

(Fig 7) Before installing Bumper, remove screens as required for clearance around lights (not included)

STEP 5

Repeat **STEP 4** to remove the Passenger/right side bumper brackets.

STEP 6

Insert the Double Nut Plate into the open end of the frame. Line up the Nut Plate with the holes in the bottom of the frame, (Fig 6).



STEP 8

Determine if the vehicle is equipped with parking sensors.

NOTE: Depending on tow package, it may be necessary or easier to install sensors, (if equipped), before attaching the Bumper.

Models without parking sensors:

- Select (1) Rubber Plug.
- Insert the Plug into sensor mounting sleeve on the back of the bumper, (Fig 8). Screws have been provided to lock the Plugs into the sleeves. Use is optional.
- Repeat previous Steps to insert the remaining (3) Rubber Plugs.

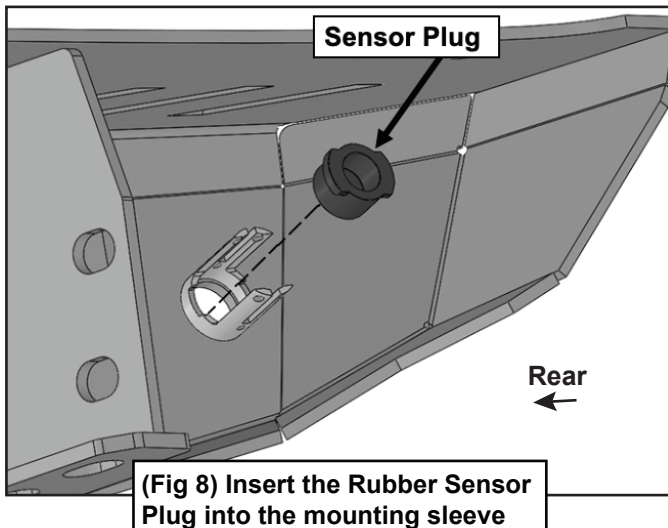

Models with bumper mounted sensors:

- Disassemble the factory bumper to remove the wiring harness and sensors.
- Select (1) parking sensor. Remove the seal from the end of the sensor. Slide (1) Foam Washer over the front of the sensor, (Fig 9).
- Insert the sensor with Seal into sensor sleeve on the back of the Bumper, (Fig 9).
- Place (1) Foam Spacer over end of the sensor. Push Sensor Retaining Clip into sensor mount and lock into mounting sleeve, (Fig 10).
- Repeat previous STEPS to attach the (3) remaining sensors.
- Attach the wiring harness to sensors.
- Optional:** Secure each sensor to the sensor sleeve with (2) 4mm x 10mm Button Head Screws. **IMPORTANT:** Sensors fit snug in sockets. The 4mm Screws are used to apply slight pressure to lock the sensors in place. Tighten both screws evenly until they touch the sensor body only. DO NOT overtighten screws or damage to sensors will result.

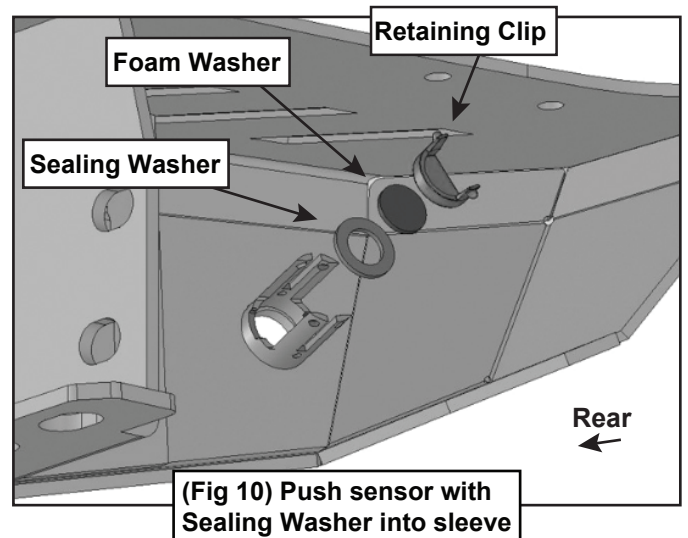
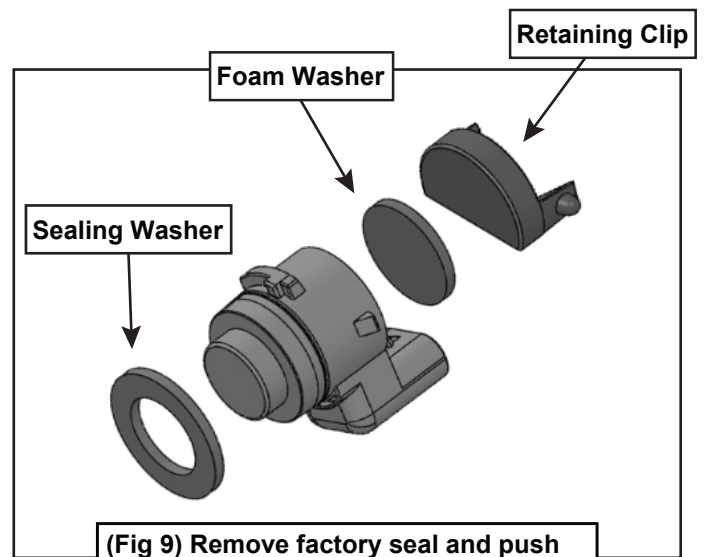

STEP 9

With assistance, carefully position the Rear Bumper up to the outside of the frame. Attach the Bumper to the Nut Plate in the passenger/right frame end with the included (2) 14mm Fine Thread Hex Bolts, (2) 14mm Lock Washers and (2) 14mm Flat Washers, (Fig 11 & 12). Reuse the (2) factory hex bolts to attach the Bumper to the threaded inserts in the side of the frame. Reuse (4) factory hex bolts to attach the driver/left side of the Bumper to the frame, (Fig 13). DO NOT tighten hardware.



TYGER[®]

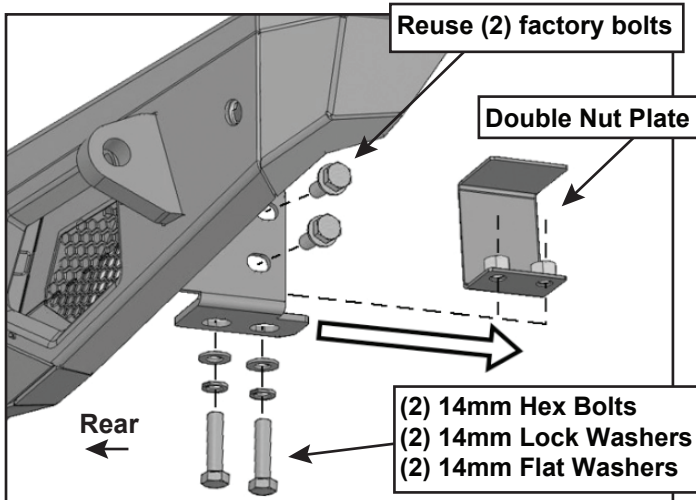

(Fig 11) Attach passenger/right side of Bumper to Double Nut Plate. Reuse (2) factory hex bolts to attach Bumper to side of frame (see Fig 11)

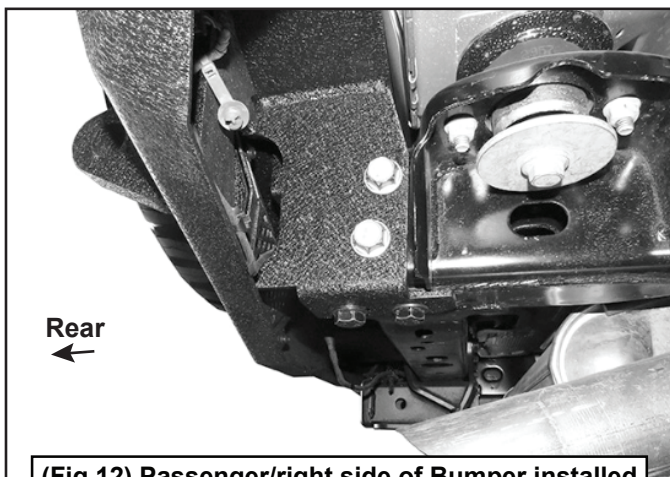

(Fig 12) Passenger/right side of Bumper installed

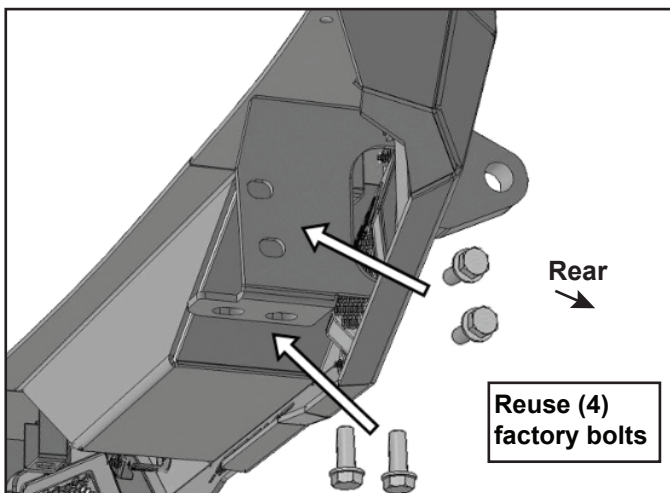

(Fig 13) Reuse (4) factory bolts to attach the Driver/left side of the Bumper

STEP 10

Level and adjust the Rear Bumper and tighten all hardware.

STEP 11

Select the License Plate Bracket, (Fig 14). Attach the Bracket to the top of the Bumper with the included (2) 8mm x 25mm Button Head Bolts, (4) 8mm Flat Washers and (2) 8mm Nylon Lock Nuts. Attach the license plate to the top holes in the Bracket with the included (2) Plastic Plugs. Insert the License Plate Light into the hole in the Bracket and attach to the wiring harness, (Fig 14).

(2) 8mm x 25mm Button Head Bolts
(4) 8mm Flat Washers
(2) 8mm Nylon Lock Nuts

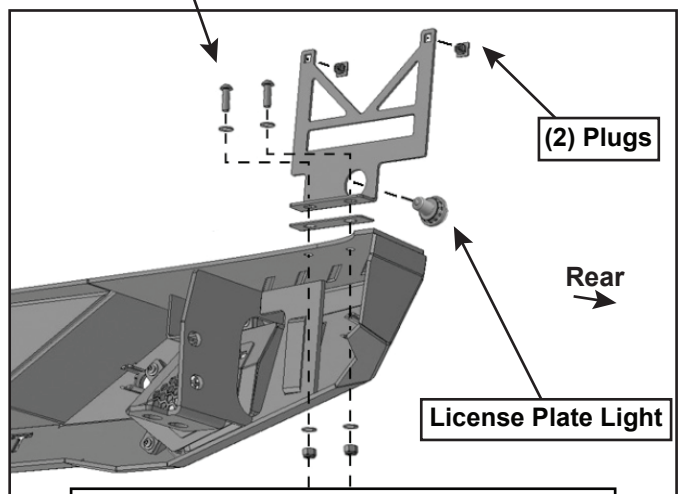

(Fig 14) Attach License Plate Bracket to the top of the driver/left side of the Bumper

STEP 12

Plug-in the bumper wiring harness to the main harness.

STEP 12

Do periodic inspections to the installation to make sure that all hardware is secure and tight.