



# TYGER®

## TYGER GUARD™

TG-GD6F60378

### BEFORE INSTALLATION

READ INSTRUCTIONS CAREFULLY BEFORE STARTING INSTALLATION. REMOVE CONTENTS FROM BOX AND VERIFY ALL PARTS ARE PRESENT. ASSISTANCE IS RECOMMENDED. FAILURE TO IDENTIFY DAMAGE BEFORE INSTALLATION COULD LEAD TO A REJECTION OF ANY CLAIM. IF ANY DAMAGE FOUND, PLEASE TAKE A PICTURE FOR THE CLAIM PURPOSE. PLEASE ALSO SEND THE PICTURES, ORDER NUMBER, AND DETAILS OF THE ISSUE TO [SUPPORT@TYGERAUTO.COM](mailto:SUPPORT@TYGERAUTO.COM).

### Torque Value

Fastener Size	Class 8.8 Tightening Torque (ft-lbs)	Class 10.9 Tightening Torque (ft-lbs)
6mm	6-7	6-7
8mm	15-16	22-23
10mm	31-32	44-45
12mm	54-55	78-79
14mm	87-88	125-126

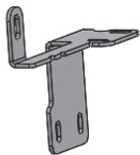

Passenger/right Side Upper Mounting Bracket



(2) Double Sided Studs with Nut

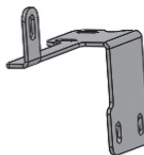

Driver/left Side Upper Mounting Bracket

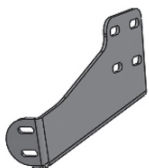

Passenger/right Side Lower Mounting Bracket

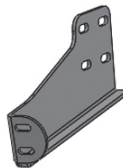

Driver/left Side Lower Mounting Bracket

NOTE: Factory skid plate must be removed or modified for installation.

### Parts List

- x1 TYGER Guard
- x1 Driver/left side Lower Mounting Bracket
- x1 Passenger/right side Lower Mounting Bracket
- x1 Driver/left side Upper Mounting Bracket
- x1 Passenger/right Upper Mounting Bracket
- x2 12-1.75mm x 110mm Hex Bolts
- x2 12mm x 44mm x 4mm Flat Washers
- x2 12mm x 32mm x 3mm Flat Washers
- x2 12mm Lock Washers
- x2 12-1.75mm Hex Nuts
- x4 10-1.50mm x 35mm Hex Bolts
- x8 10mm x 27mm x 3mm Flat Washers
- x4 10mm Lock Washers
- x4 10-1.50mm Hex Nuts
- x4 8-1.25mm x 35mm Hex Bolts
- x4 8-1.25mm x 25mm Special Self-Tapping Flange Bolts
- x2 8-1.25mm x 55mm Double Sided Studs with Nut
- x10 8mm x 22mm x 2mm Flat Washers
- x10 8mm Lock Washers
- x2 8mm Hex Nuts
- x2 6-1.0mm x 20mm Combo Bolts (license plate)
- x1 4mm Allen Wrench



# TYGER®

## STEP 1

Start the installation on the driver side, front of the vehicle. Remove plastic air box if equipped, (Fig 1). Select the driver side Upper Mounting Bracket. Hold the Bracket in position against the outside of the frame channel, (Fig 2). Insert (1) 12mm x 110mm Hex Bolt with (1) 12mm x 32mm Flat Washer sideways through the Mounting Bracket and frame. Secure with (1) 12mm x 44mm Large Flat Washer, (1) 12mm Lock Washer and (1) 12mm Hex Nut, (Figs 3 & 5). Snug but do not tighten hardware.

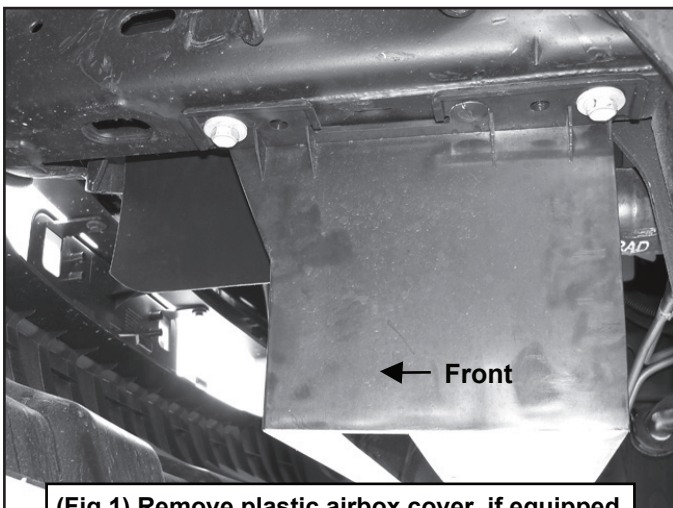

(Fig 1) Remove plastic airbox cover, if equipped (pictured from driver/left side of frame)

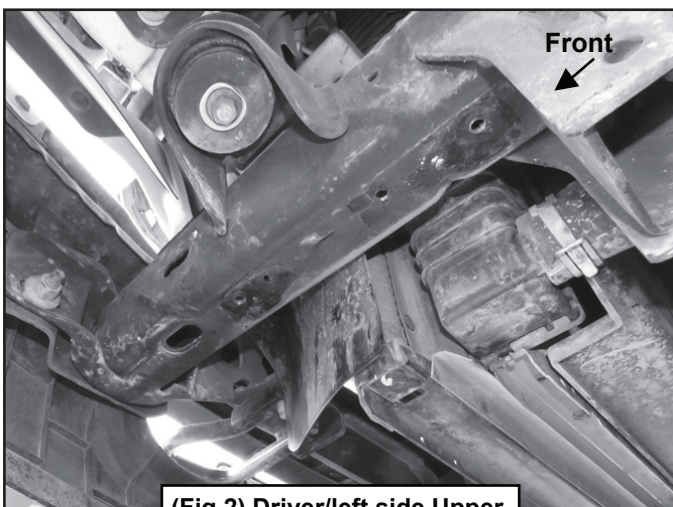

(Fig 2) Driver/left side Upper Bracket mounting location

## STEP 2

Line up the (2) slots in the bottom of the Bracket with the (2) factory holes in the bottom of the frame.

### 1998-2009 vehicles without plastic airbox:

Slowly thread (2) 8mm x 25mm Self Tapping Flange Bolts, (2) 8mm Lock Washers and (2) 8mm Flat Washers into the factory holes in the frame, (Fig 3). Do not tighten hardware at this time.

**IMPORTANT:** Do not over-tighten the Bracket hardware or damage to the frame may result.

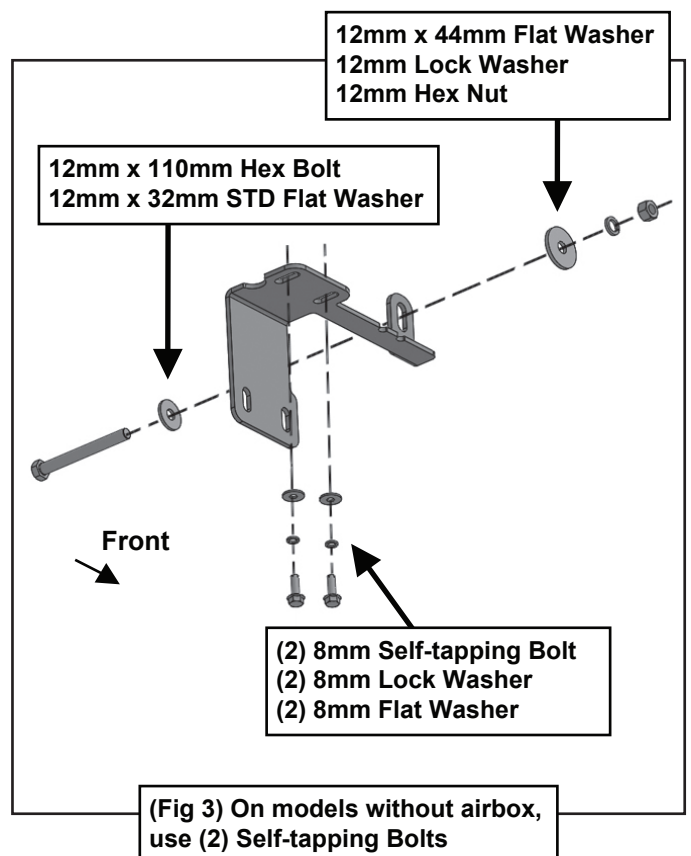



**2010-2012 vehicles with plastic airbox or factory skid plate (must be removed):**

The forward hole is not threaded; the rear hole is threaded for a hex bolt and was used to hold the air box or skid plate in place. Slowly thread the (1) 8mm x 25mm Self Tapping Flange Bolt, (1) 8mm Lock Washer and (1) 8mm Flat Washer into the forward unthreaded hole in the frame, (Fig 4A). Thread (1) 8-1.25mm x 50mm Double Sided Stud, (1) 8mm Lock Washer and (1) 8mm Flat Washer into the rear threaded hole, (Fig 4A-4B).

**NOTE:** Installation of the 8mm Double Sided Stud will require a long reach deep socket. Snug but do not tighten hardware at this time.

**IMPORTANT:** Do not over-tighten the Bracket hardware or damage to the frame may result.

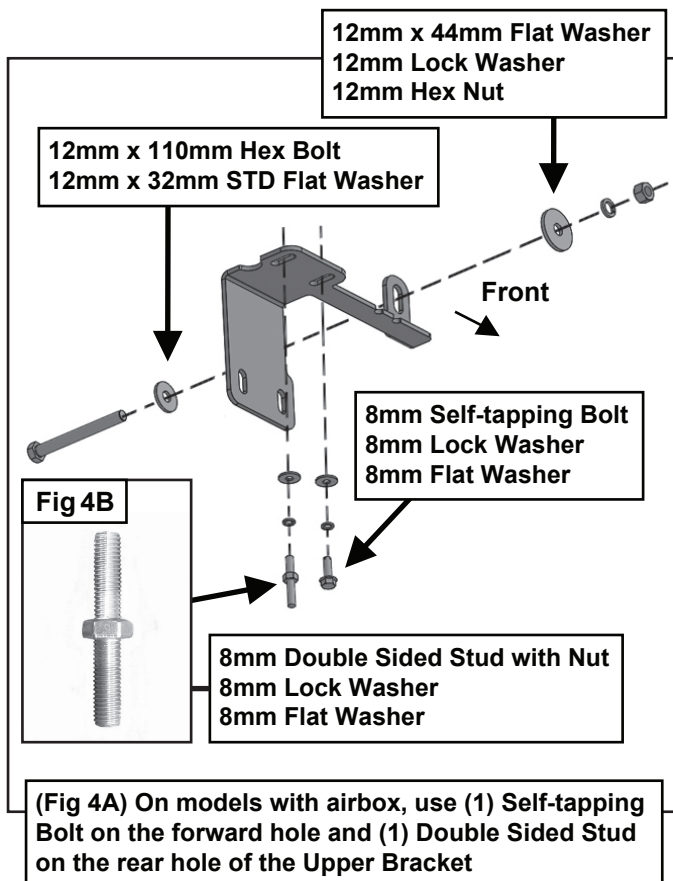

## STEP 3

Repeat Steps 1-2 for passenger side Upper Mounting Bracket installation.

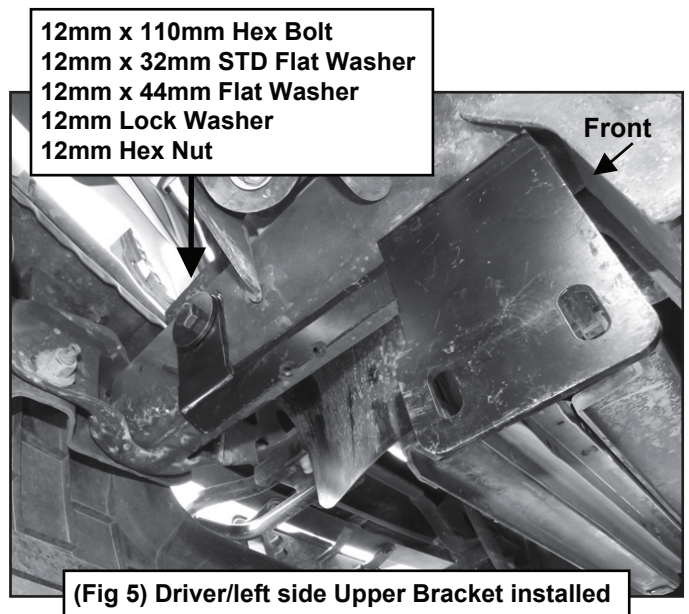



# TYGER®

## STEP 4

Next, determine the correct mounting position for the driver side Lower Mounting Bracket:

**1998-2009 models:** Use the bottom (2) slots position to raise the TYGER Guard, (See Fig 6).

**2010-2012 models:** Use the top (2) slots position to clear the factory spoiler, (See Fig 6).

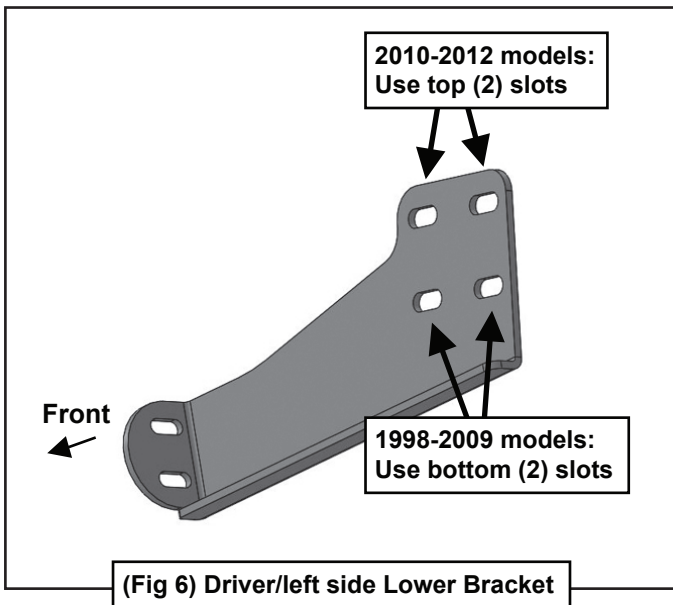

## STEP 5

Attach the Driver/left side Lower Bracket to the outside of the Upper Bracket with the included (2) 10mm x 35mm Hex Bolts, (4) 10mm Flat Washers, (2) 10mm Lock Washers and (2) 10mm Hex Nuts, (Fig 7). Do not tighten hardware. Repeat this Step for passenger side Lower Bracket installation.

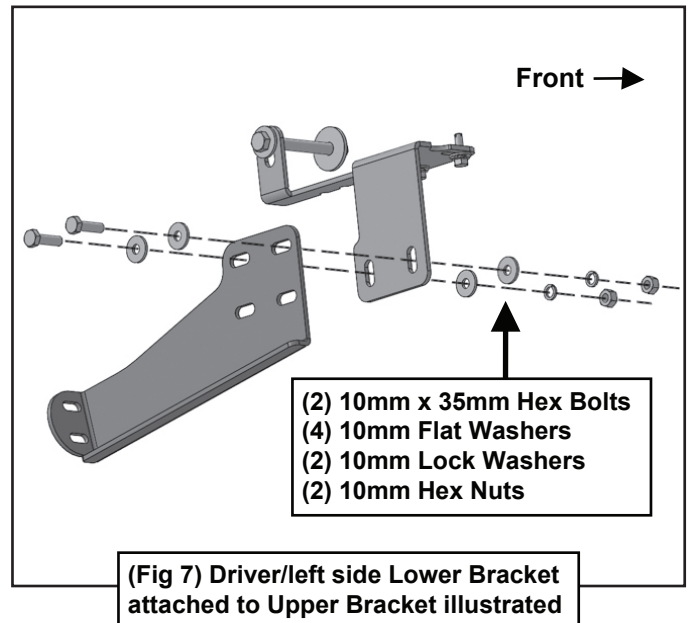



# TYGER®

## STEP 6

With assistance, position the TYGER Guard up to the Lower Brackets. Use the included (4) 8mm Hex Bolts, (4) 8mm Lock Washers and (4) 8mm Flat Washers to attach the TYGER Guard to the Lower Brackets, (Fig 8). Snug but do not tighten hardware at this time.

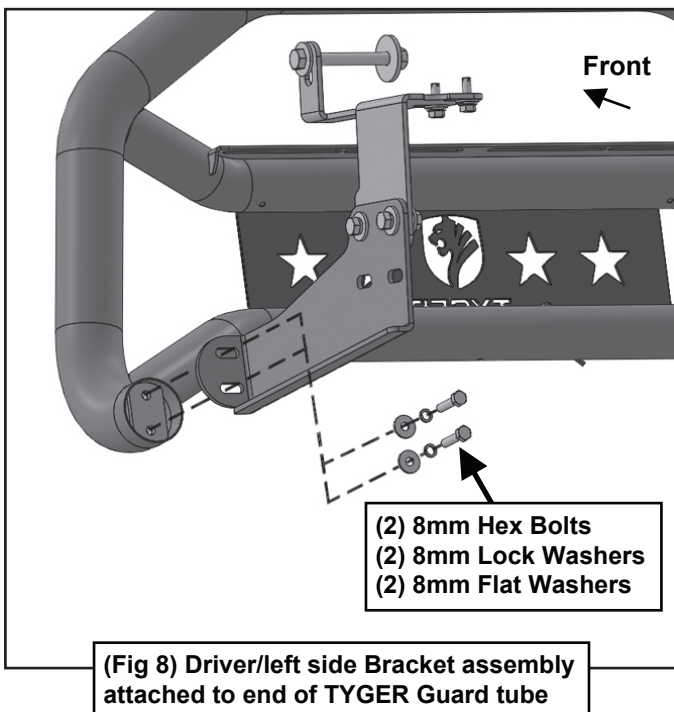

## STEP 7

Level and adjust the TYGER Guard properly and tighten all hardware.

**IMPORTANT:** Do not over-tighten the Mounting Bracket hardware or damage to the frame may result.

## STEP 8

**On vehicles with plastic airbox removed in Step 1:**

Remove the (2) plastic clips from the plastic air box. Hold the airbox up to the vehicle. Insert the plastic clips into the forward previously unused holes if there are corresponding holes in the bottom of the frame, (Fig 9). If there are no holes in the frame, discard the plastic clips.

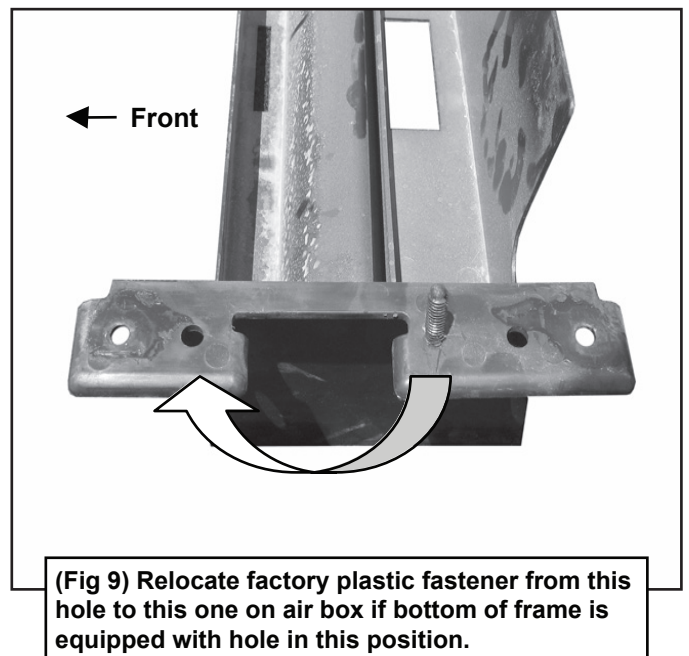



# TYGER®

Place the air box in position over the 8mm Double Sided Stud. Secure the air box to the 8mm Double Sided Stud with (1) 8mm Flat Washer, (1) 8mm Lock Washer and (1) 8mm Hex Nut, (Fig 10). Bolt the front of the airbox to the frame rail with the factory hex bolt and the plastic clip-if used. Do not tighten hardware at this time. Repeat this step to attach the airbox on the passenger side. Proceed to tighten all hardware.

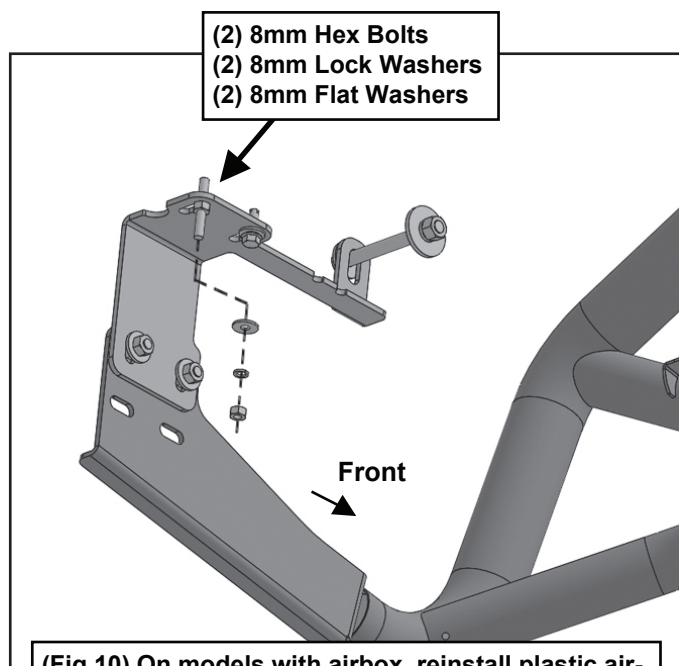

(Fig 10) On models with airbox, reinstall plastic air-box onto Double Sided Stud and over Self Tapping Hex Bolt. Reuse factory bolt and plastic clip to secure airbox along with the provided hardware for the Double Sided Stud.

## STEP 9

Do periodic inspections to the installation to make sure that all hardware is secure and tight.



Complete Installation