



RISER®

TG-RS6C60248

BEFORE INSTALLATION

READ INSTRUCTIONS CAREFULLY BEFORE STARTING INSTALLATION. REMOVE CONTENTS FROM BOX AND VERIFY ALL PARTS ARE PRESENT. FAILURE TO IDENTIFY DAMAGE BEFORE INSTALLATION COULD LEAD TO A REJECTION OF ANY CLAIM. IF MISSING PARTS OR ANY DAMAGE FOUND, PLEASE TAKE A PICTURE FOR THE CLAIM PURPOSE. TO FILE YOUR CLAIM, PLEASE VISIT: WWW.TYGERAUTO.COM/CONTACT

TORQUE VALUES

Fastener Size	Class 8.8 Torque (ft-lbs)	Class 10.9 Torque (ft-lbs)
6mm	6-7	6-7
8mm	15-16	22-23
10mm	31-32	44-45
12mm	54-55	78-79
14mm	87-88	125-126

- x1** Driver/Left 6inch Tyger Sidebar **D**
- x1** Passenger/Right 6inch Tyger Sidebar **P**
- x8** Mounting Brackets
- x16** 8mm x 30mm Hex Bolts
- x16** 8mm x 25mm Combo Boltss
- x16** 8mm Lock Washers
- x16** 8mm x 24mm OD x 2mm Flat Washers

Parts List

(8) Mounting Brackets

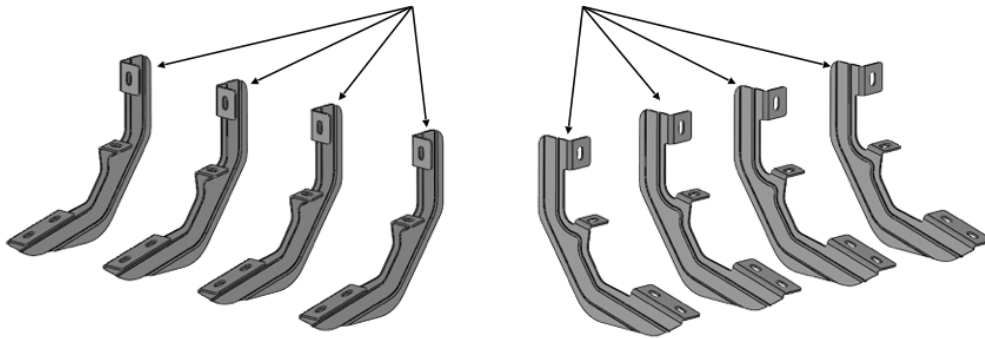

Top View

ATTENTION: Refer to **D** and **P** labelling on the side of the tubes to determine Driver and Passenger Riser



P Passenger Side Riser

Front
→

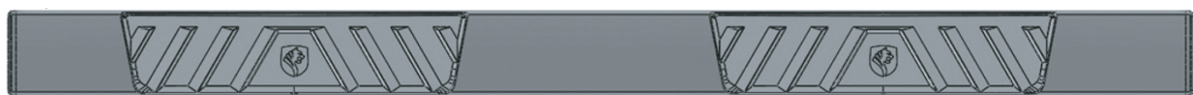

Front
←

D Driver Side Riser

PROCEDURE:

REMOVE CONTENTS FROM BOX. VERIFY ALL PARTS ARE PRESENT. READ INSTRUCTIONS CAREFULLY BEFORE STARTING INSTALLATION. ASSISTANCE IS RECOMMENDED.

STEP 1

Start the installation under the Passenger/Right side of the vehicle.

a. For “Early” 2019 models, locate the 6 plugs along the bottom edge of the body. Mounting Brackets will bolt to the 1st, 3rd, 4th and 6th threaded mounting holes (Fig 1).

b. For “Late” 2019 models, all 4 mounting locations will be used.

Passenger/Right Side Installation Pictured

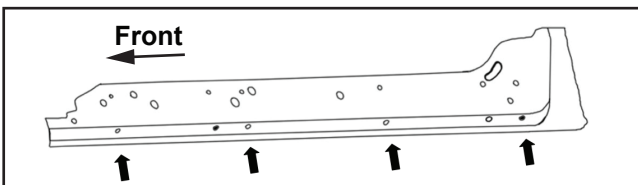

(Fig 1) Passenger/Right “Early” rocker panel mounting locations (arrows) NOTE: Hold Bracket up to body panel to help determine the correct mounting locations.

STEP 2

Remove the plastic plugs from the Passenger/Right front mounting location. Select (1) Mounting Bracket. Attach the Mounting Bracket to the factory threaded holes with (2) 8mm Hex Bolts, (2) 8mm Lock Washers and (2) 8mm Flat Washers (Figs 2 & 3). DO NOT tighten hardware.

Passenger/Right Side Installation Pictured

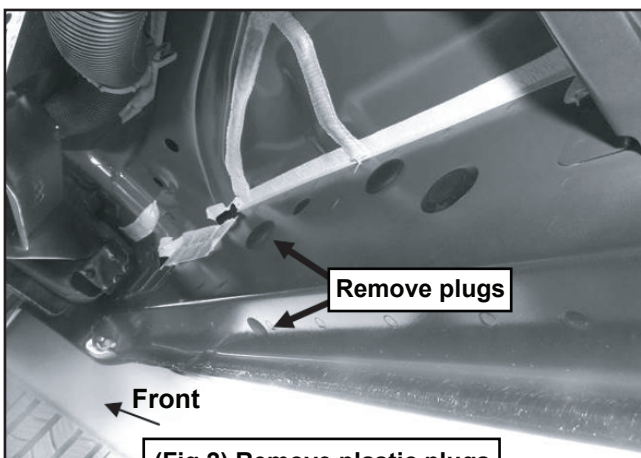

(Fig 2) Remove plastic plugs to uncover threaded inserts

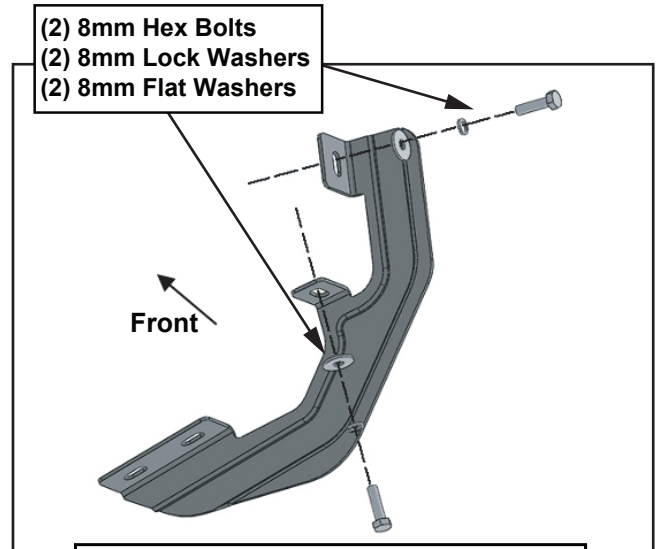

(Fig 3) Attach (1) Passenger/Right Mounting Bracket to the mounting location

STEP 3

Repeat **STEPS 1 & 2** to attach (3) Mounting Brackets to the (3) remaining locations along the rocker panel (Figs 4-7). DO NOT tighten hardware.

Passenger/Right Side Installation Pictured

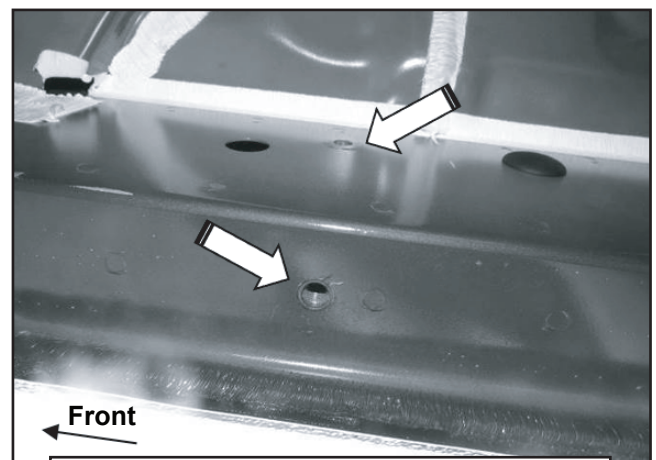

(Fig 4) Passenger/Right front mounting location

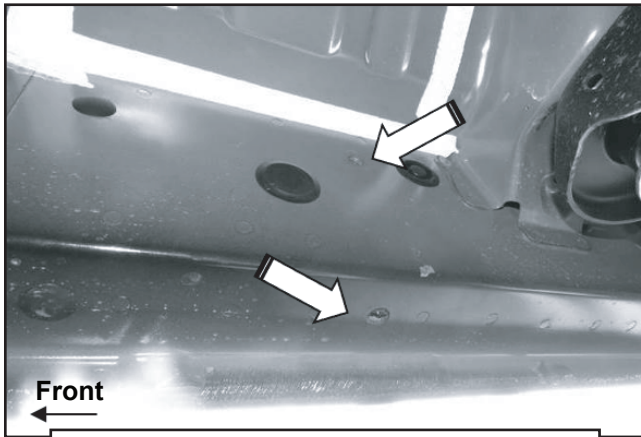

(Fig 5) Passenger/Right 2nd mounting location

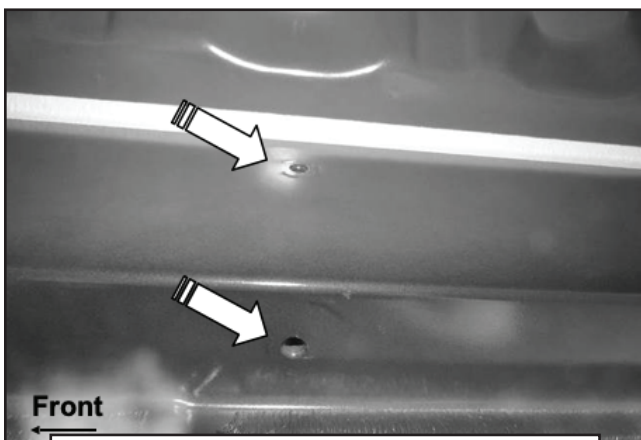

(Fig 6) Passenger/Right 3rd mounting location

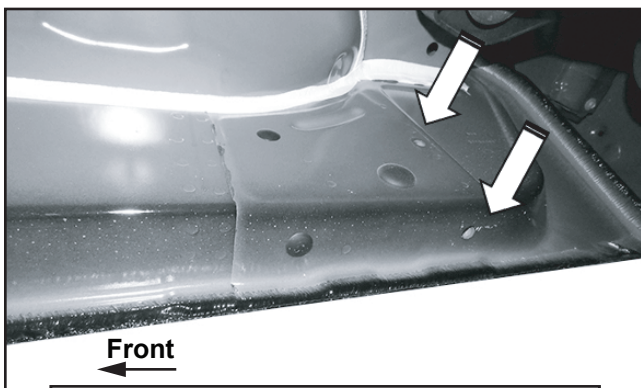

(Fig 7) Passenger/Right rear mounting location

Passenger/Right Side Installation Pictured

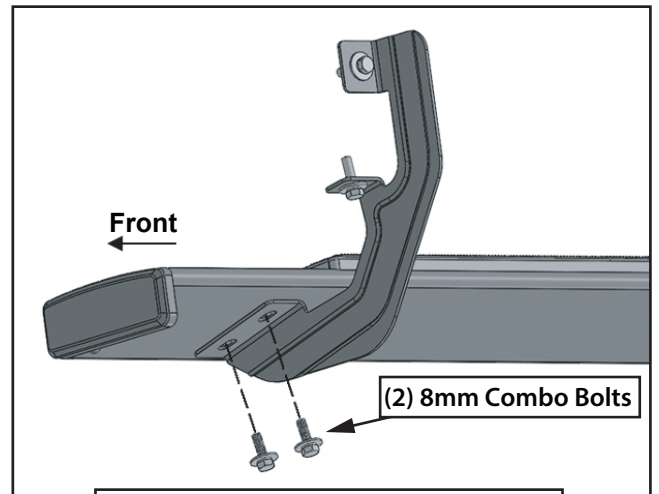

(Fig 8) Attach Passenger/Right Running Board to the Mounting Brackets

STEP 5

Level and adjust the Tyger Sidebar and fully tighten all hardware.

STEP 6

Repeat **STEPS 1-5** to attach the Driver/Left 6inch Tyger Sidebar.

STEP 7

Do periodic inspections to the installation to make sure that all hardware is secure and tight.

STEP 4

Select the Passenger/Right 6inch Tyger Sidebar. Attach the Sidebar to the rear faces of the Mounting Brackets with (8) 8mm Combo Bolts (Fig 8). DO NOT tighten hardware.