



# TYGER RIDER®

TG-SS2T35187

Scan to Download the Latest Digital Version



## Parts List

- x1 Driver/Left Sidebar **D**
- x1 Passenger/Right Sidebar **P**
- x1 Driver/Left Front Mounting Bracket **[A]**
- x1 Passenger/Right Front Mounting Bracket **[D]**
- x1 Driver/Left Center Mounting Bracket **[B]**
- x1 Passenger/Right Center Mounting Bracket **[E]**
- x1 Driver/Left Rear Mounting Bracket **[C]**
- x1 Passenger/Right Rear Mounting Bracket **[F]**
- x12 8-1.25mm x 30mm Hex Bolts
- x12 8-1.25mm x 25mm Combo Hex Bolts
- x12 8mm Lock Washers
- x12 8mm x 24mm OD x 2mm Flat Washers

## BEFORE INSTALLATION

READ INSTRUCTIONS CAREFULLY BEFORE STARTING INSTALLATION. REMOVE CONTENTS FROM BOX AND VERIFY ALL PARTS ARE PRESENT. FAILURE TO IDENTIFY DAMAGE BEFORE INSTALLATION COULD LEAD TO A REJECTION OF ANY CLAIM. IF MISSING PARTS OR ANY DAMAGE FOUND, PLEASE TAKE A PICTURE FOR THE CLAIM PURPOSE. TO FILE YOUR CLAIM, PLEASE VISIT: [WWW.TYGERAUTO.COM/CONTACT](http://WWW.TYGERAUTO.COM/CONTACT)

## TORQUE VALUES

Fastener Size	Class 8.8 Torque (ft-lbs)	Class 10.9 Torque (ft-lbs)
6mm	6-7	6-7
8mm	15-16	22-23
10mm	31-32	44-45
12mm	54-55	78-79
14mm	87-88	125-126

## Top View

**ATTENTION:** Refer to **D** and **P** labelling on the side of the tubes to determine Driver and Passenger Rider

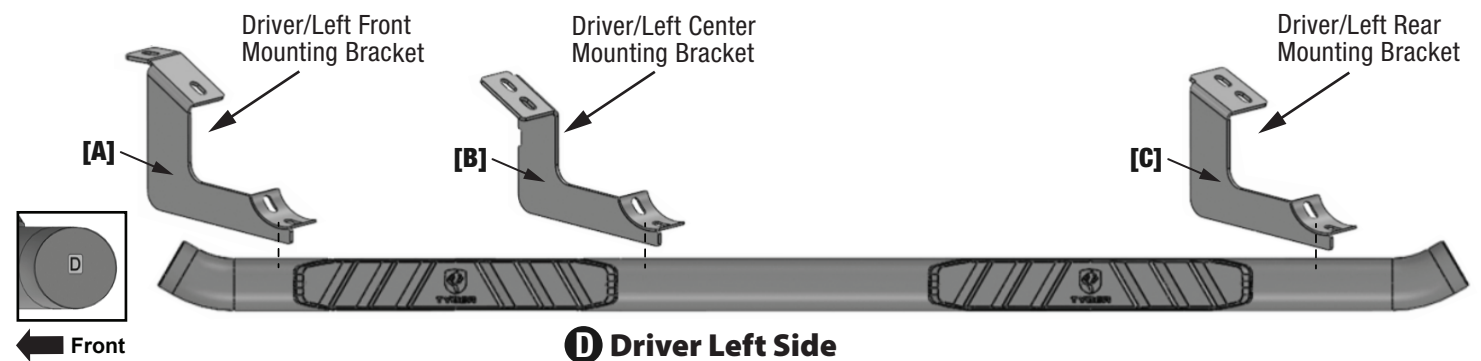
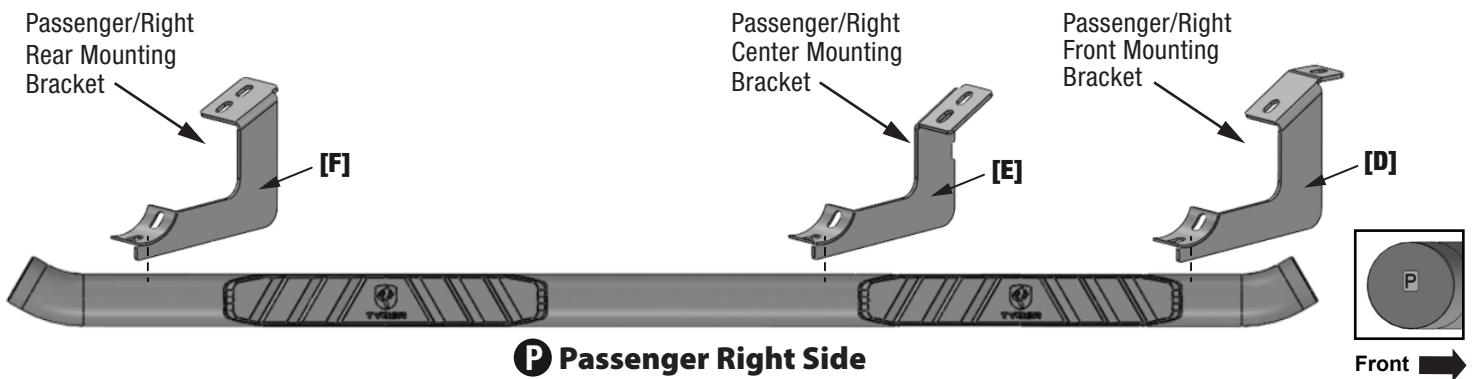

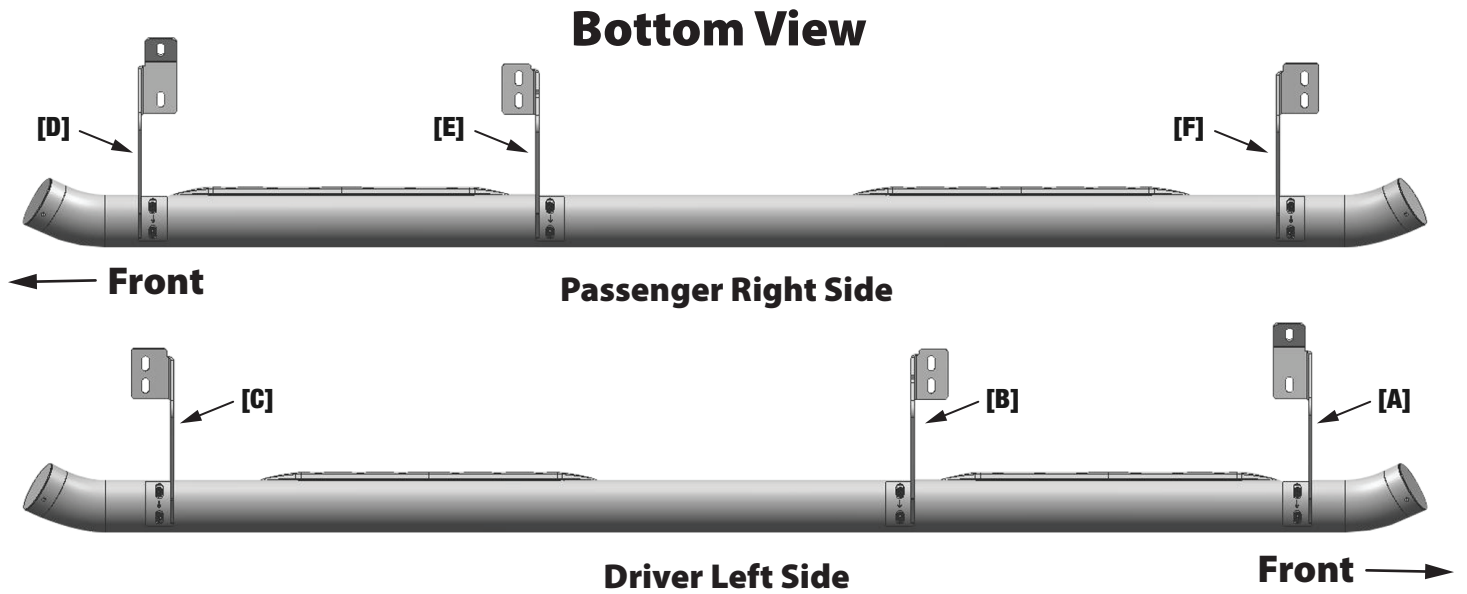

**STEP 1**

REMOVE CONTENTS FROM BOX. VERIFY ALL PARTS ARE PRESENT. READ INSTRUCTIONS CAREFULLY. ASSISTANCE IS HIGHLY RECOMMENDED.

**STEP 2**

Starting on the Driver/Left side of the vehicle and remove the plastic plugs or hex bolts from the factory mounting location along the bottom of the body (Figs 1 & 2).

Driver/Left Side Installation Pictured

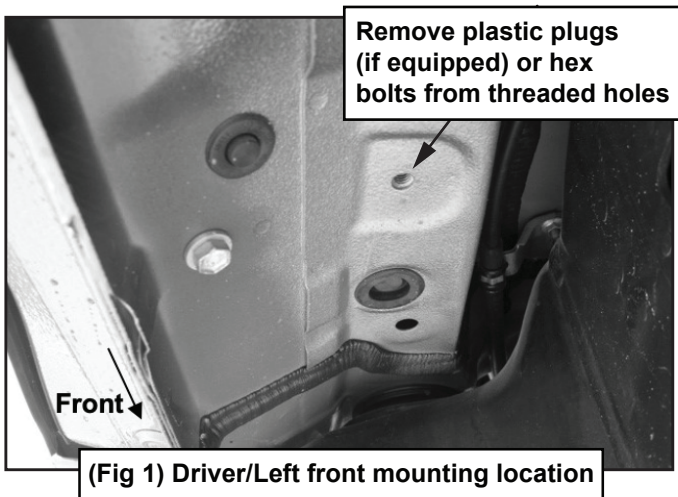

(Fig 2) Driver/Left center (2nd) location

**STEP 3**

Select the Driver/Left Front Mounting Bracket **[A]**. Attach the Bracket to the front location with (2) 8mm Hex Bolts, (2) 8mm Lock Washers and (2) 8mm Flat Washers (Figs 3 & 4). DO NOT tighten hardware at this time.

(2) 8mm Hex Bolts  
(2) 8mm Lock Washers  
(2) 8mm Flat Washers

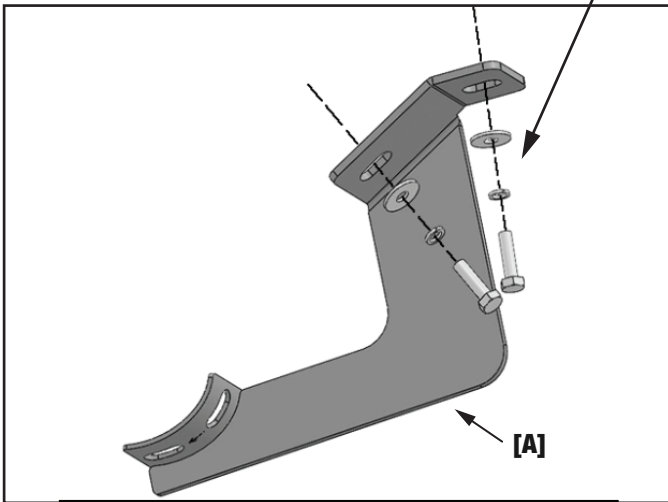

(Fig 3) Attach the Driver/Left Front Mounting Bracket [A] to the front location

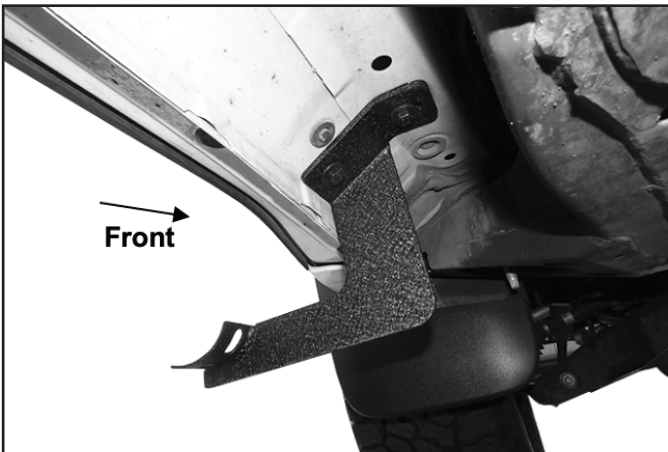

(Fig 4) Driver/Left Front Mounting Bracket attached to the front location

The Center Bracket has a notch cut out in the back

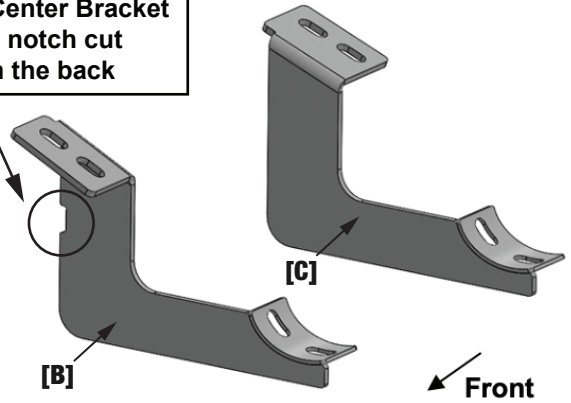

(Fig 5) The Center and Rear Brackets are similar but are different

(2) 8mm Hex Bolts  
(2) 8mm Lock Washers  
(2) 8mm Flat Washers

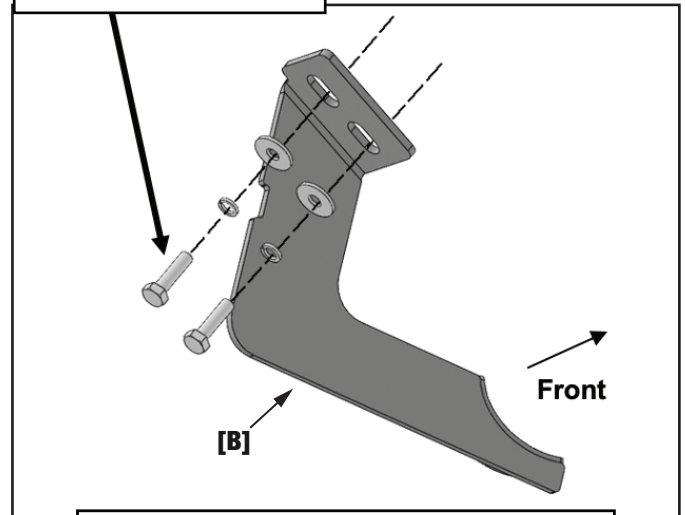

(Fig 6) Attach the Passenger/Right Center Mounting Bracket [B] to the center location

## STEP 4

Repeat **STEPS 2 & 3** to attach the Center and Rear Mounting Brackets [B] & [C] (Figs 2-6).

**NOTE:** The Center and Rear Mounting Brackets are similar but are unique. The Center Bracket has a notch in the back (Fig 5).

**Driver/Left Side Installation Pictured**

## STEP 5

Select the Driver/Left Sidebar. Carefully place Sidebar on the brackets.

**IMPORTANT:** DO NOT slide or rotate Sidebar on cradles, or damage to the finish may result. Attach Sidebar to the Mounting Brackets with (6) 8mm Combo Bolts (Figs 7 & 8). DO NOT tighten hardware at this time.

Driver/Left Side Installation Pictured

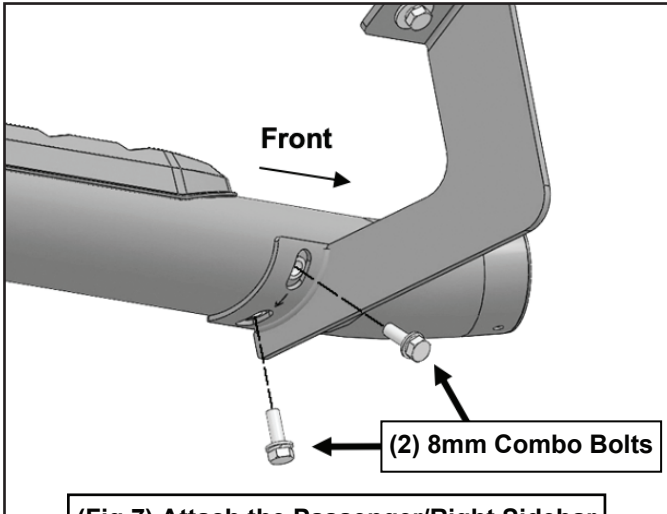

(Fig 7) Attach the Passenger/Right Sidebar to the Mounting Brackets

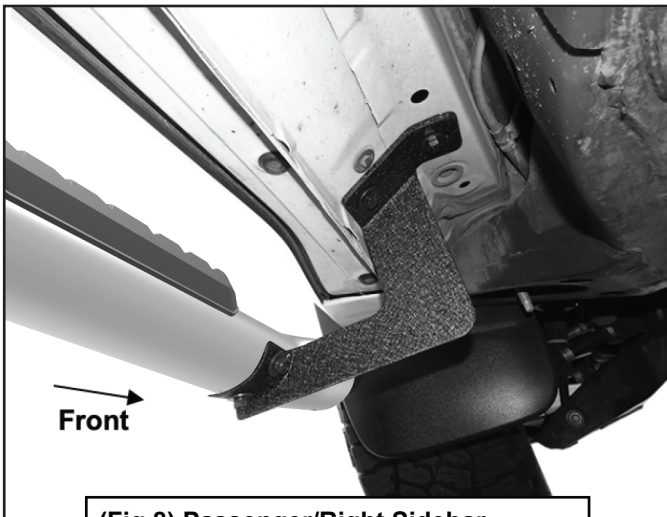

(Fig 8) Passenger/Right Sidebar attached to the Front Mounting Bracket

**STEP 6**

Level and adjust the Sidebar and tighten all hardware.

**STEP 7**

Repeat **STEPS 1-6** to attach the Passenger/Right Sidebar.

**STEP 8**

Do periodic inspections to the installation to make sure that all hardware is secure and tight.