



# TYGER®

## TG-TC9F1035B

Fit 2013-2016 Ford Escape

### Parts Included

- Cargo Cover x 1
- Instructions x 1

### IMPORTANT

To protect your investment, only use mild soap and water to clean the cover. Allow cover to completely dry before retracting into the housing.

# CARGO COVER

### Warning

REMOVE CONTENTS FROM BOX. VERIFY ALL PARTS ARE PRESENT. READ INSTRUCTIONS CAREFULLY BEFORE STARTING INSTALLATION.

## STEP 1

The Cargo Cover is designed to install in the factory location, (Figure 1). Start installation by opening the rear hatch on the vehicle.

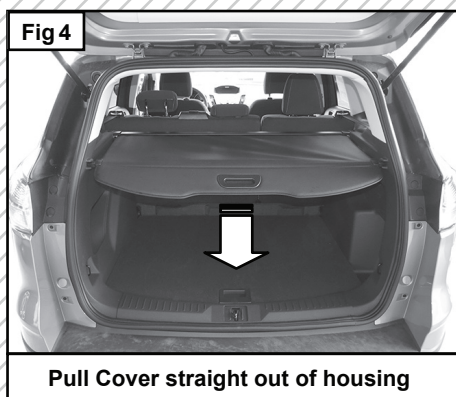
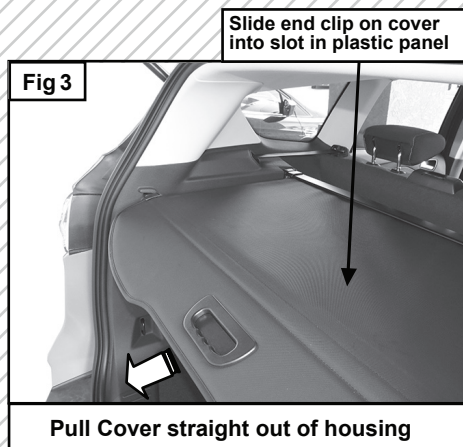
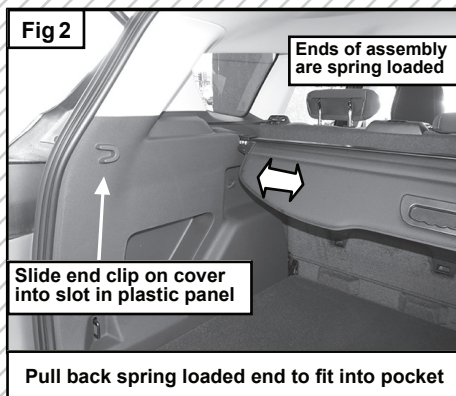
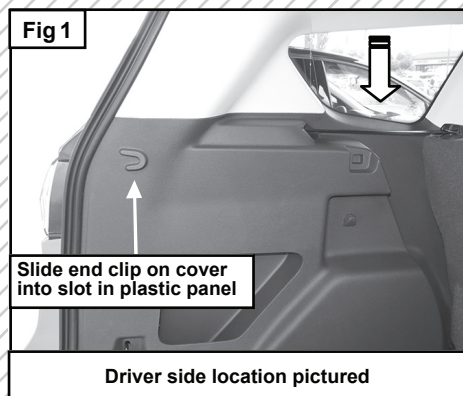

## STEP 2

Locate the rectangular pocket in the side of the cargo area behind the back seat, (Fig 1). Carefully unwrap the Cargo Cover. Insert the driver side of the Cargo Cover into the pocket in the side of the vehicle, (Fig 1 & 2). Select the forward or rear pocket as necessary to clear seat. Repeat this Step to insert the passenger side of the Cargo Cover into the pocket in the passenger side. **NOTE:** Ends on cover housing are spring loaded. Select the forward or rear pocket as necessary.

## STEP 3

Slowly pull the rear cover straight out of the assembly, (Fig 3). Locate the pockets on each side of the vehicle next to the rear door, (Fig 2 & 3). Slide the tabs on the end of the cover into the slots in the pockets next to the door. Hook the tabs on the U-Shaped pockets to hold cover in place, (Fig 2 - 4). Cargo Cover installation is complete. Then, do periodic inspections to the installation to make sure that all hardware is secure and tight.